

SwitchBot Curtain Rod 2

User Manual

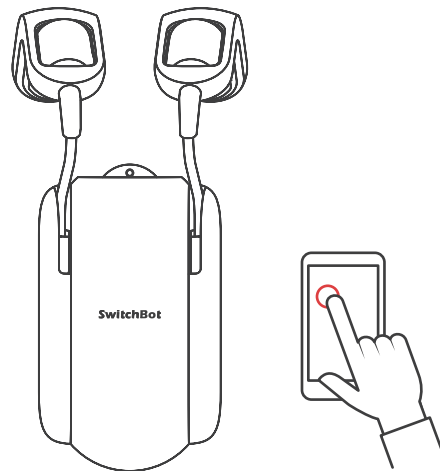

www.switch-bot.com

V4.6-2208

※ Please read this user manual carefully before using the device.

Contents

1. Package Contents	01
2. List of Components	02
3. Preparation	03
4. Installation	05
5. Usage Methods	22
6. Settings	25
7. Charging, Firmware Upgrades and Resetting Factory Settings	26
8. Specifications	28
9. Warranty	29
10. Contact & Support	31

For more support please visit support.switch-bot.com

Package Contents

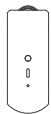

Main Unit



Hook Pair (Rod 2)

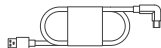

Type-C Cable



Beads Fixer (beads installed)

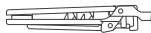

Clip

List of Components

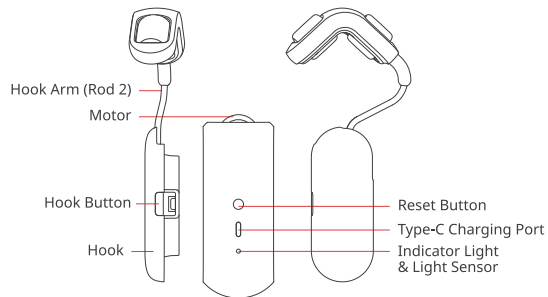

Preparation

- A smartphone or tablet using Bluetooth 4.2 or later.
- The latest version of our app, downloadable via the Apple App Store or Google Play Store.
- A SwitchBot account, you can register via our app or sign in to your account directly if you already have one.
- A fully charged SwitchBot Curtain.

Please note: If you intend to use Cloud Services for voice control, you will need a SwitchBot Hub Mini (sold separately).



iOS 11.0+



Android OS 5.0+

Check your Curtain Track

SwitchBot Curtain Rod 2 supports curtain track with the following measurements:

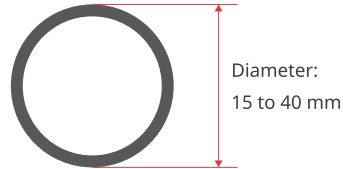

If SwitchBot Curtain Rod 2 does not work on your curtain track, please contact: support@wondertechlabs.com

Installation

Step 1: Add your Curtain to the SwitchBot app

Open the SwitchBot app and sign in to your account. Tap "+" at the top right of the home page, find the Curtain icon and select, then follow the instructions to add your Curtain.

Step 2: Install your Curtain on curtain track

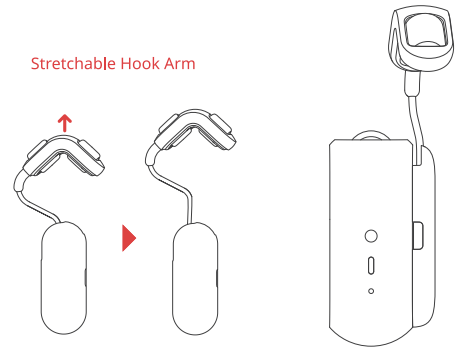

1. Ring Top Curtains

① Fully close your curtain, then remove the first curtain hook from the ring.

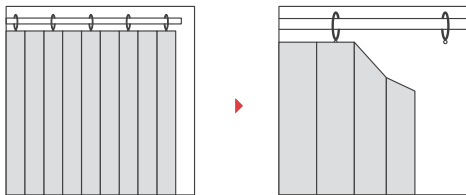

② Stretch the separate Hook arm and attach it between the first and second ring onto the rod.

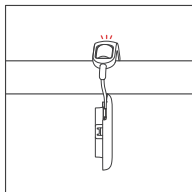

07

③ Attach another Hook with the main unit onto your curtain track, then pull the separate Hook downwards slightly and install it back to the main unit. You will hear a click when it is firmly attached.

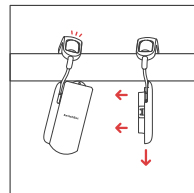

④ Adjust your SwitchBot Curtain to keep it perpendicular to the ground and make sure the SwitchBot logo faces indoors. Then hang your curtain back in place and hide SwitchBot Curtain behind your fabric curtain.

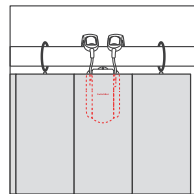

08

2. Grommet Curtains

① Install your SwitchBot Curtain at the back of this type of curtain.

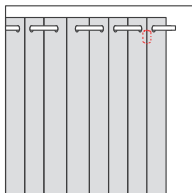

② Stretch the separate Hook arm and attach it between the first and second grommet onto the rod.

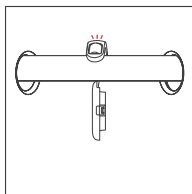

③ Attach another Hook with the main unit onto your curtain track, then pull the separate Hook downwards slightly and install it back to the main unit. You will hear a click when it is firmly attached.

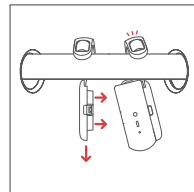

④ Adjust your SwitchBot Curtain to keep it perpendicular to the ground and make sure the SwitchBot logo faces indoors.

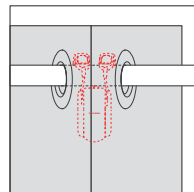

⑤ Refer to the pictures below to install the beads fixer (with beads installed) at the top of the grommets. Make sure that you clip them to the grommets firmly. Finish by cutting the remaining beads or put it behind your curtain.

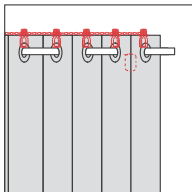
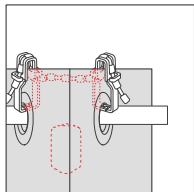
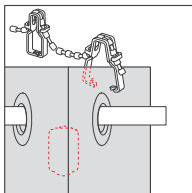
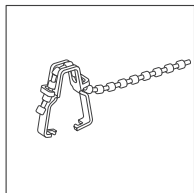

3. Tab Top Curtains

Use the clips provided to help install your SwitchBot Curtain on tab top curtains.

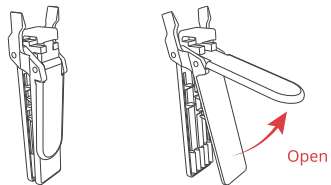

Close your curtain, attach a clip on the first tab.

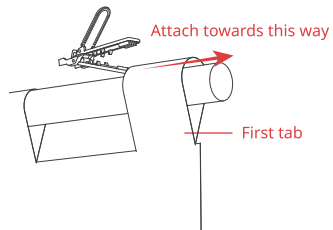

Attach the remaining clips on other tabs as shown on the picture.

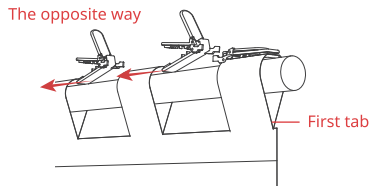

Beware that all other clips should be attached the opposite way against the first clip, make sure all the clips are sitting on the top of the rod and are aligned with each other.

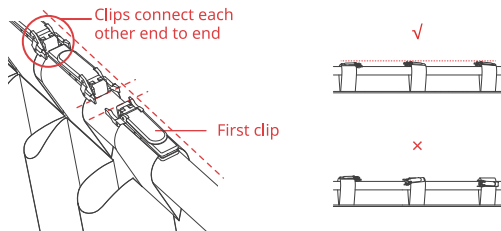

① Install your SwitchBot Curtain at the back of this type of curtain.

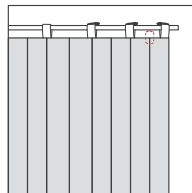

② Stretch the separate Hook arm and attach it between the first and second tab onto the rod.

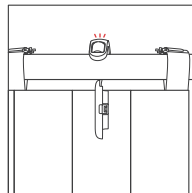

③ Attach another Hook with the main unit onto your curtain track, then pull the separate Hook downwards slightly and install it back to the main unit. You will hear a click when it is firmly attached.

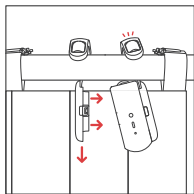

④ Adjust your SwitchBot Curtain to keep it perpendicular to the ground and make sure the SwitchBot logo faces indoors.

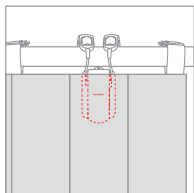

4. Back Tab Curtains

Use the clips provided to help install your SwitchBot Curtain on back tab curtains.

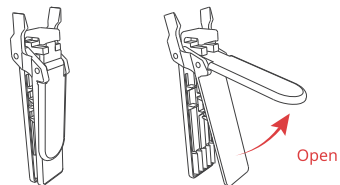

Close your curtain, attach a clip on the first tab.

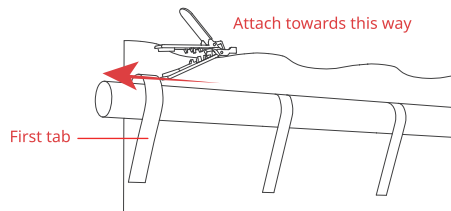

Attach the remaining clips on other tabs as shown on the picture.

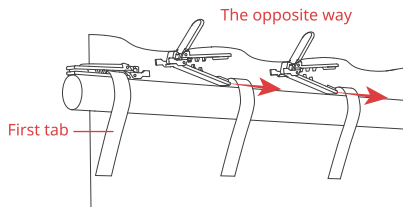

Beware that all other clips should be attached the opposite way against the first clip, make sure all the clips are sitting on the top of the rod and are aligned with each other.

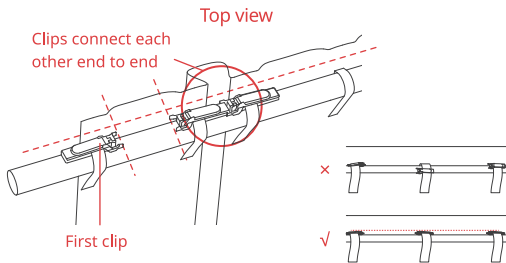

① Install your SwitchBot Curtain at the back of this type of curtain.

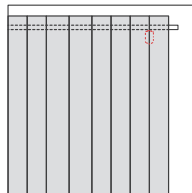

② Stretch the separate Hook arm and attach it between the first and second tab onto the rod.

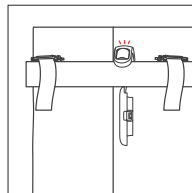

- ③ Attach another Hook with the main unit onto your curtain track, then pull the separate Hook downwards slightly and install it back to the main unit. You will hear a click when it is firmly attached.

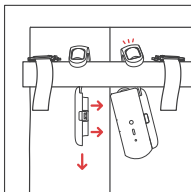

- ④ Adjust your SwitchBot Curtain to keep it perpendicular to the ground and make sure the SwitchBot logo faces indoors.

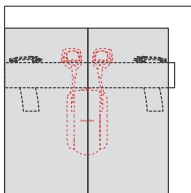

How to Control Double-Sided Curtains

If you are using a double-sided curtain, we recommend you use two SwitchBot Curtains to open your curtains from the middle.

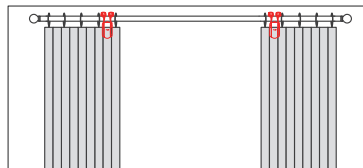
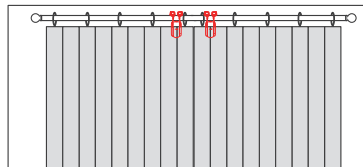

If you have only purchased 1 SwitchBot Curtain, you may use the clips provided to join your curtains together and turn them into a single-sided curtain.

Please note: Using just 1 SwitchBot Curtain to control a double-sided curtain may affect user experience.

Step 3: Calibration

After you have added and installed your SwitchBot Curtain, you will need to calibrate it to set its route on your curtain track. Please follow the instructions in our app to make sure that the actual movement of your curtain is the same as the animation in the app. You can choose to recalibrate the Curtain or change its opening direction whenever you want by going to Curtain > Settings > Calibration.

Please note: You can group two SwitchBot Curtains via our app should you plan to open your curtains from the middle. Before you calibrate, please make sure the positions of your SwitchBot Curtains are the same as shown in our app.

Usage Methods

App Control

Open or close your curtain with just the tap of a button. We offer intuitive app control for iOS and Android users, with weekly/bi-weekly updates. OTA firmware updates are also available to give you a better user experience.



Touch & Go

When SwitchBot Curtain senses you drawing your curtain for more than 5 cm, it will automatically start and do the work for you. For a double-sided curtain, you only need to pull one side of it to activate your Curtain.

Please note: You can turn off this feature on the Advanced Settings page of the Curtain at any time.

*5 cm lowers the possibility of false triggers by foreign objects, pets, children, etc.

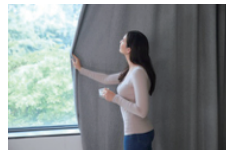

Voice Control and Home Automation*

You can link multiple third-party services to your SwitchBot account to control your SwitchBot Curtain or trigger Scenes using voice commands.

How to realize voice control and home automation:

- Connect your smartphone or tablet to the Internet.
- Set up a SwitchBot Hub Mini (sold separately).
- Turn on Cloud Services via SwitchBot Curtain's Settings page.
- Link third-party services to your SwitchBot account.

Alexa, close the curtain.

Hey Google, close my bedroom curtain.

Hey Siri, open the living room curtain.

* Requires SwitchBot Hub Mini (sold separately)



Control with SwitchBot Remote (Sold Separately)



A wireless remote to place anywhere.

You can also control your SwitchBot Curtain using a SwitchBot Remote. There are two buttons on the Remote and you can set an action for each via our app, for example, one button for fully opening and another for fully closing your Curtain. One Remote can also control 2 SwitchBot Curtains that have been grouped. Please refer to the user manual of Remote for more information.

Settings

Light Sensor (Beta)

This allows you to set automations based on the illuminance level or the relative intensity of sunlight around your device. This is a beta stage function and is being upgraded continuously. You can find more details in future app releases.

Delay

You can set 1 Delay for a countdown action. You can set the countdown time, percentage of opening or closing, and Motion Mode.

Schedule

You can set up to 5 Schedules locally on your device, or unlimited Schedules with a SwitchBot Hub. You can set the day, time, percentage of opening or closing, and Motion Mode.

Charging, Firmware Upgrades, and Resetting Factory Settings

Charging

It takes about 6.5 hours to fully charge your device battery and this can last for up to 8 months after one full charge. You may also purchase our Solar Panel to charge using sunlight.

1. A 5 V = 1 A adapter is required to charge your device.
2. Battery life is tested under conditions of opening and closing a 8 kg (17 lbs) curtain on a 3-meter-long track once a day under 25 °C. Actual battery life may vary depending on different conditions.
3. Charging with Solar Panel requires a level 6 illuminance level at least.

Firmware Upgrades

In order to improve user experience, we will regularly release firmware updates to introduce new functions and solve any software defects that may occur during usage. When a new firmware version is available, we will send an upgrade notification to your account via our app. When upgrading, please make sure your product has sufficient battery and make sure your smartphone is within range to prevent interference.

Resetting Factory Settings



Press and hold the Reset button for 15 seconds until the indicator light lights up, then release the button.

Caution: You may lose all previous settings after factory reset and you will need to add the device again and redo calibration. If you are using a double-sided curtain, you will need to recalibrate both Curtains.

Specifications

Model: W0701600

Color: White/Black

Material: ABS plastic with UV-resistant coating

Size (Main Unit): 42 × 51 × 110 mm (1.7 × 2 × 4.3 in.)

Weight (Main Unit): 135 g (4.8 oz.)

Power: Type-C, DC 5V = 1A,

3350 mAh lithium-ion battery or by Solar Panel¹

Battery Life: 8 months² or unlimited with Solar Panel

Network Connectivity:

Bluetooth 5.0, long range transmission

Sensor: Accelerometer, light sensor

Strength: Supports curtain of up to 8 kg (17 lbs)
(from controlled experiments in our lab)

Max Runway: 3 m (9.8 ft.)

Schedule: Up to 5, or unlimited with a SwitchBot Hub³

Voice Control (SwitchBot Hub Required): Amazon Alexa, Google Assistant, Siri Shortcuts, SmartThings, IFTTT, and LINE CLOVA

Please note: Use your device under room temperature only.

1. SwitchBot Solar Panel is sold separately.
2. Battery life is tested under conditions of opening and closing a 8 kg (17 lbs) curtain on a 3-meter-long track once a day under 25 °C. Actual battery life may vary depending on different conditions.
3. SwitchBot Hub Mini is sold separately.

Warranty

We warrant to the original owner of the product that the product will be free from defects in materials and workmanship. Please note that this limited warranty does not cover:

- Products submitted beyond the original limited warranty period.
- Products on which repairs or modifying have been attempted.
- Products subjected to falls, extreme temperatures, water, or other operating conditions outside the product specifications.
- Damage due to natural disaster (including but not limited to lightning, flood, tornado, earthquake, or hurricane, etc.).
- Damage due to misuse, abuse, negligence or casualty (e.g. fire).
- Other damage that is not attributable to defects in the manufacture of product materials.
- Products purchased from unauthorized resellers.
- Consumable parts (including but not limited to batteries).
- Natural wear of the product.

Contact & Support

Setup and Troubleshooting: support.switch-bot.com

Support Email: support@wondertechlabs.com

Feedback: If you have any concerns or problems when using our products, please send feedback via our app through the Profile > Feedback page.

Find Out More

Please visit support.switch-bot.com for more details.



CE/UKCA Warning

To comply with RF exposure requirements, a minimum separation distance of 20 cm must be maintained between the user's body and the device, including the antenna. Use only the supplied or an approved antenna. This device is in compliance with the essential requirements and other relevant provisions of directive 2014/53/EU. All essential radio test suites have been carried out.

CE DOC

Hereby, Woan Technology (Shenzhen) Co., Ltd. declares that the radio equipment type W0701600 is in compliance with Directive 2014/53/EU. The full text of the EU declaration of conformity is available at the following internet address: support.switch-bot.com

UKCA DOC

Hereby, Woan Technology (Shenzhen) Co., Ltd. declares that the radio equipment type W0701600 is in compliance with UK Radio Equipment Regulations (SI 2017/1206). The full text of the UK declaration of conformity is available at the following internet address: support.switch-bot.com

This product can be used in EU member states and UK.

Manufacturer: Woan Technology (Shenzhen) Co., Ltd.

Address: Room 1101, Qiancheng Commercial Center, No. 5 Haicheng Road, Mabu Community, Xixiang Subdistrict, Bao'an District, Shenzhen, Guangdong, P.R.China, 518100

Operation Frequency: Max RF output power

Bluetooth: 2402 MHz to 2480 MHz (-1.42 dBm)

FCC Warning

This device complies with Part 15 of the FCC Rules. Operation is subject to the following two conditions:

- (1) This device may not cause harmful interference.
- (2) This device must accept any interference received, including interference that may cause undesired operation.

NOTE: This equipment has been tested and found to comply with the limits for a Class B digital device, pursuant to Part 15 of the FCC Rules. These limits are designed to provide reasonable protection against harmful interference in a residential installation.

This equipment generates uses and can radiate radio frequency energy and, if not installed and used in accordance with the instructions, may cause harmful interference to radio communications. However, there is no guarantee that interference will not occur in a particular installation. If this equipment does cause harmful interference to radio or television reception, which can be determined by turning the equipment off and on, the user is encouraged to try to correct the interference by one or more of the following measures:

- Reorient or relocate the receiving antenna.
- Increase the separation between the equipment and receiver.
- Connect the equipment into an outlet on a circuit different from that to which the receiver is connected.
- Consult the dealer or an experienced radio/TV technician for help.

NOTE: The manufacturer is not responsible for any radio or TV interference caused by unauthorized modifications to this equipment. Such modifications could void the user's authority to operate the equipment.

FCC Radiation Exposure Statement

This equipment complies with FCC radiation exposure limits set forth for an uncontrolled environment. This equipment should be installed and operated with minimum distance 20 cm between the radiator and your body.

IC Warning

This device complies with CAN ICES-003 (B)/NMB-003(B).

This device complies with Industry Canada licence-exempt RSS standard(s).

Operation is subject to the following two conditions:

- (1) this device may not cause harmful interference.
- (2) this device must accept any interference received, including interference that may cause undesired operation.

Cet appareil est conforme à la norme CAN ICES-3 (B)/NMB-3 (B).

Le présent appareil est conforme aux CNR d'Industrie Canada applicables aux appareils radio exempts de licence. L'exploitation est autorisée aux deux conditions suivantes :

- (1) l'appareil ne doit pas produire de brouillage.
- (2) l'utilisateur de l'appareil doit accepter tout brouillage radioélectrique subi, même si le brouillage est susceptible d'en compromettre le fonctionnement.

IC Radiation Exposure Statement

This equipment complies with the IC radiation exposure limits established for uncontrolled environment. This equipment must be installed and operated at least 20 cm from a radiator or your body.

Cet équipement est conforme aux limites d'exposition aux rayonnements de la IC établies pour un environnement non contrôlé. Cet équipement doit être installé et fonctionner à au moins 20cm de distance d'un radiateur ou de votre corps.

KCC Warning

인증받은자의 상호: Woan Technology (Shenzhen) Co., Ltd.
제품명/모델명: 특정소출력 무선기기(무선데이터통신시스템용 무선기기) / W0701600
제조사 및 제조국가: Woan Technology (Shenzhen) Co., Ltd. /China
제조년월: 2021.11
인증번호: R-R-Woa-W0701601
이 장치는 보안성이 없으므로 통신보안에 위배되는 사항의 통신을 금지하며 운용 중

NCC Warning

取得審驗證明之低功率射頻器材，非經核准，公司、商號或使用者均不得擅自變更頻率、加大功率或變更原設計之特性及功能。
低功率射頻器材之使用不得影響飛航安全及干擾合法通信；經發現有干擾現象時，應立即停用，並改善至無干擾時方得繼續使用。
前述合法通信，指依電信管理法規定作業之無線電通信。
低功率射頻器材須忍受合法通信或工業、科學及醫療用電波輻射性電機設備之干擾。