

- Microprocessor controlled
- 13 functions
- RS232 or RS485
- Remote controllable up to 1200m (RS485)
- Preset standard
- Weatherproof standard IP56



The DTRXDC is a digital receiver, controlled by a microprocessor, for remote control of variable speed Pan & Tilt motor (PTH355P) and a motor-driven zoom lens.

The connection to the control unit can be RS232 or RS485 (in this case, the connection distance can reach 1200m).

The digital receiver is controlled by DCJ or DCT keyboards and it is possible to recall up to 14 Pan & Tilt and lens preset positions with 4 local alarms.

Two auxiliary control relays are available for controlling, for instance, the switching on of an IR illuminator, through a power contact.

A IP56 weatherproof box ensures protection against all weather conditions.

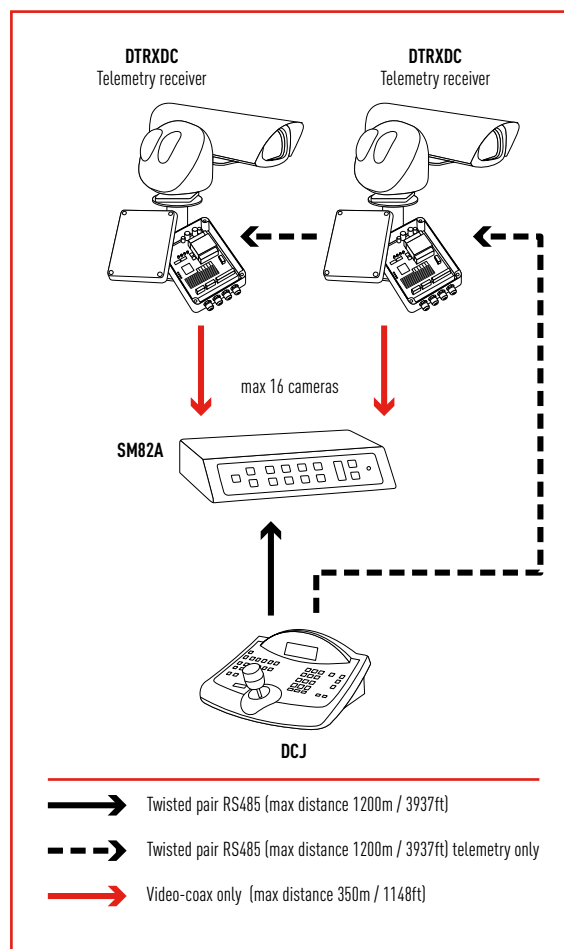

TECHNICAL DATA

GENERAL

13 Functions: UP, DOWN, LEFT, RIGHT, AUTO, ZOOM TELE, ZOOM WIDE, FOCUS NEAR, FOCUS FAR, IRIS OPEN, IRIS CLOSE, AUX1, AUX2

99 selectable address through Dip Switch

Serial input selectable: RS232 or RS485

Repeater RS232 or RS485 for daisy chain configuration

Ability to use both polarity inversion lenses and common wire lenses

PRESET / SCAN / PATROL functions, 4 alarm contacts

Ability to memorize up to 14 preset functions (P&T motor, lens)

LED indicating power supplied to the unit

Optoisolated digital logic and power section

EEPROM for the storage of active options

Supplied with instruction manual, 2 PG11 blanking caps, 4 wall mounts with relevant fastening screws

MECHANICAL

Plastic material enclosure

6 cable glands PG11

External dimensions: 255x200x100mm (10x7.87x3.93in)

ELECTRICAL

Power supply: 230V AC, 50Hz

Power consumption: 40W

Power supplied to the positioning device: 24V DC

Power supplied to the lens: adjustable 6 - 16V max 80mA

Trimmer for the adjustment of the lens voltage

2 dry contacts 1A 230V AC, 1A 24V AC (AUX1, AUX2)

Fuse F1: 630mA F 250V

PROTOCOLS

VIDEOTECH (9600, 1200 Baudrate)

COMMUNICATIONS

Repeater RS485 and RS232 for daisy chain configuration

Telemetry data input RS485 on keyboards serial output for a max distance of 1200m (3937ft)

Telemetry data input RS485 on matrix SM series serial output for a max distance of 1200m (3937ft)

Telemetry data input RS232 for PC or keyboard control for a max distance of 15m (49ft)

RELATED PRODUCTS

PTH355P Pan&Tilt

SM42A-82A Matrix 4/8 inputs and 2 outputs

SM84A-164A Matrix 8/16 inputs and 4 outputs

SM328A Matrix 32 inputs and 8 outputs

DCJ Matrix, Mux and Telemetry Control Keyboard with three axis joystick

DCT Matrix, Mux, DVR and Telemetry Control Keyboard touch screen equipped with three axis joystick

Retrofit on discontinued products: contact Videotec for further specifications.

ENVIRONMENT

Indoor / Outdoor

Operating temperature: 0°C / +45°C (+32°F / +113°F)

COMPLIANCE TO

CE according to EN 61000-6-3, EN 60065, EN 50130-4

IP56

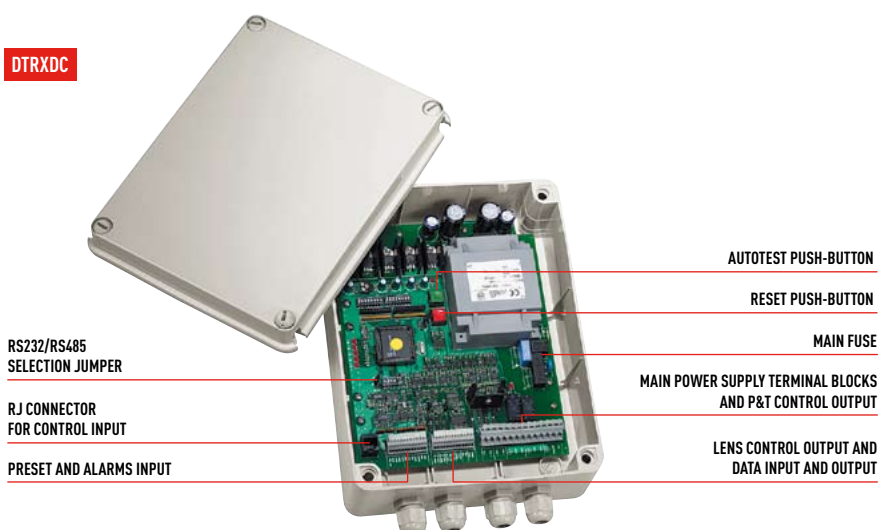

Unit Weight:
DTRXDC 1.7kg / 3.7lb

Package Weight:
DTRXDC 1.9kg / 4.2lb

Package Dimensions (BxHxL):
DTRXDC 12x21x30cm / 4.7x8.3x11.8in

Master Carton:
DTRXDC -