



- Video programming "On Screen Menu"
- 8-16 video inputs
- 4 video outputs
- Remote control by max 4 operators
- Telemetry line
- Controllable by PC
- Privacy video-masking function

The SM84/SM164A matrix is a microprocessor remote-controlled video matrix which allows the video switching of 8-16 cameras on 4 outputs.

The "On Screen" programming can be done in four languages. A programmable password ensures protection from improper use of the matrix.

The switching is controlled by a maximum of 4 remote keyboards in RS485.

The keyboards, remote up to maximum distance of 1200m (3937ft), allows the video switching and matrix set-up, in four languages, on screen and telemetry control through the same matrix.

8-16 alarm contacts can be associated with the corresponding video inputs. In case of alarm, the alarmed video input can be displayed on the video output. The alarm contacts are independent and configured as Normally Open (NO) or Normally Closed (NC). The reset of an alarm situation is performed through keyboard, external contact or time-out.

The telemetry control can be performed on coax cable on the 8-16 video inputs and on the RS485 serial output.

Furthermore, it is possible to control the video switching by a VCR trigger signal.

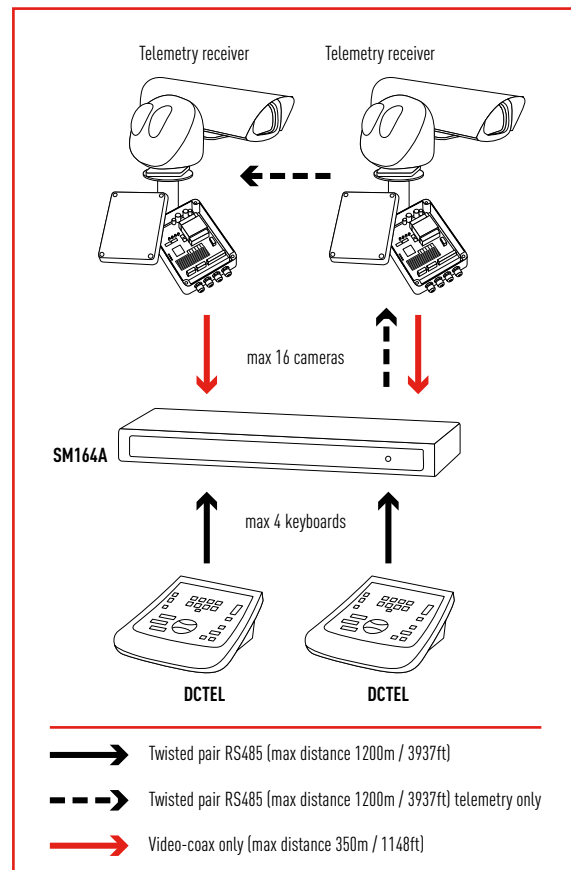

10
VIDEO SWITCHING

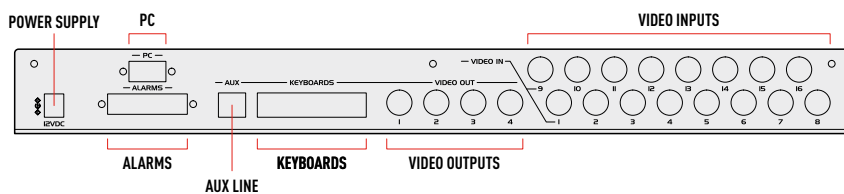

TECHNICAL DATA

GENERAL

Max 8-16 cameras
 Max 4 remote keyboards
 Menu in four languages (Italian, English, French and German)
 On screen display video programming
 Different switching sequences for each output video
 Identification texts for each output
 Date and time management
 Types of alarm reset: manual from keyboard, external, timed automatically
 Completely configurable alarm input for each 8-16 video input
 VCR trigger management
 Alarm condition warning buzzer
 Relay can be activated by each alarm
 Video signal masking on fixed camera for privacy purposes
 Input 75 Ohm load disconnectable
 Supplied with instruction manual, wide range power supply, 3 power cables, 2 RJ11 telephone cables, 2 jack shunt boxes RJ11, 1 DB25 connector

MECHANICAL

Metal enclosure
 Painted with epoxy polyester powder RAL7036
 Dimensions: Rack 19", 1U (436.6x163x445mm)
 1 connector 25 pole
 5 connectors RJ11 (4 for keyboards and 1 for telemetry line)
 Power supply jack connector
 Female connector DB9
 8-16 BNC video inputs
 4 BNC video outputs

ELECTRICAL

Power supply: IN 100-240V AC - OUT 12V DC, 47/63Hz, 1A
 Power consumption: 15W max
 8-16 inputs 75 Ohm 1Vpp (PAL/NTSC)
 4 outputs 75 Ohm 1Vpp (PAL/NTSC);
 Bandwidth: > 6MHz
 Lower cut-off frequency [-3dB]: 9Hz
 Signal/noise ratio: >48dB@5.5MHz
 Relay contact: 50V AC, 0.3A

COMMUNICATIONS

Telemetry transmission on coax cable on the 8-16 video inputs (min distance 5m (16.4ft) and max 350m (1148ft)
 Telemetry data transmission on serial output RS485 for a max distance of 1200m (3937ft)
 Four serial inputs RS485 for the reception of data from max 4 remote keyboards from a max distance of 1200m (3937ft)
 Serial input RS232 for firmware update and PC control from a max distance of 15m (49ft)

PROTOCOL

Telemetry Line

VIDEOTECH (1200, 9600 baudrate)
 MACRO (1200, 9600, 19200, 38400 baudrate)
 PELCO D (2400, 4800, 9600, 19200 baudrate)

Pelco D is registered trademark.

Because SM84A-164A may be interfaced with equipment not manufactured by Videotec, it is possible that the interface protocols have changed or are in a different configuration from earlier tested units from us. Because Videotec recommends a bench test prior to installation, Videotec will not be liable for any installation costs or lost revenues in the event a compatibility problem will occur.

RELATED PRODUCTS

DCBD	Matrix Control Keyboard
DCTEL	Matrix and Telemetry Control Keyboard
DCIR	Infrared Remote Control
DCK	Matrix and Mux Control Keyboard
DCJ	Matrix, Mux and Telemetry Control Keyboard with three axis joystick
DCT	Matrix, Mux, DVR and Telemetry Control Keyboard touch screen equipped with three axis joystick
MICRODEC485	Mini telemetry receiver 8 functions, 24V AC
DTMRX224	Telemetry receiver 12 functions, 24V AC
DTMRX2	Telemetry receiver 12 functions, 230V AC
DTRX324	Telemetry receiver 17 functions, 24V AC
DTRX3	Telemetry receiver 17 functions, 230V AC
DTCOAX	Over the coax board for DTRX3 only trough matrix series SM
DTRXDC	Telemetry receiver 13 functions, for PTH355P
ULISSE	Positioning Unit
MISTRAL	Dome Camera

Retrofit on discontinued products; contact Videotec for further specifications.

ENVIRONMENT

Indoor
 Operating temperature: 0°C / +40°C (32°F / +105°F)

COMPLIANCE TO

CE according to EN 61000-6-3, EN 60950, EN 55022 Class B, EN 50130-4
 FCC according to Part. 15 Class B



Unit Weight:
SM84-164A 3.4kg / 7.5lb

Package Weight:
SM84-164A 3.7kg / 8.1lb

Package Dimensions (BxHxL):
SM84-164A 51.5x18.5x11.5cm / 20.2x7.3x4.5in

Master Carton:
SM84-164A -