

A STORY LASTING FOR MORE THAN 40 YEARS

- Ever since the year 1980, our company has been designing and creating products according to the initial idea of founder Francesco Albiero.
 - Starting with only a few presses and production on behalf of third parties, our company was always looking to grow and create value.
 - In order to achieve this, a long process made of investments, plenty of brainstorming and care for market requests was undertaken.
 - It was out of one of such moments that the first "Stagnoli" nylon rack was born, patented and still acknowledged today all over the world as a synonym of quality
 - Since its foundation the company **produces in Italy**, precisely in Lonato del Garda, and is active on both Italian and foreign markets.
 - There are more and more countries each year in which the firm **exports** its own brand of "made in Italy"
 - Over time, the company's technical-productive know-how has grown significantly. Along with the technopolymers molding line, starting from the 90s a line of **products for automation and signaling** was launched, characterized by functionality, design and quality.
 - Today, Stagnoli offers a range of useful products for the **automation and signaling of mechanism of our everyday lives.**
-

"Remember, great ideas can arise even just from the observation of simple things"

Albiero Francesco

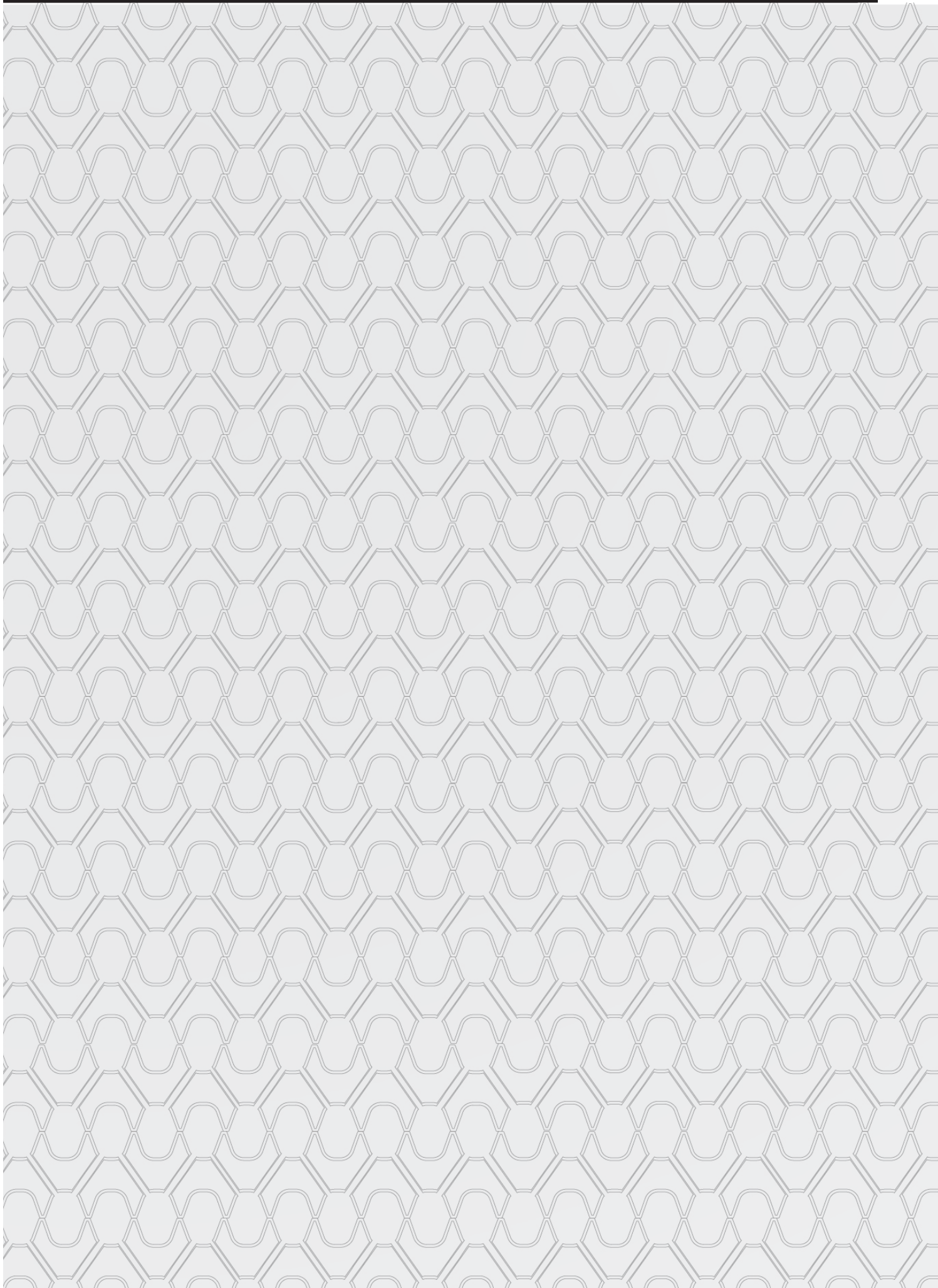

INDEX



SIGNALING ACCESSORIES

07

ERA80 TRAFFIC LIGHT	08
ERA801L TRAFFIC LIGHT	12
ERA80 TRAFFIC LIGHT - YELLOW	14
ERA801L TRAFFIC LIGHT - YELLOW	16
CHRONOS TRAFFIC LIGHT	18
APOLLO TRAFFIC LIGHT ALLUMINUM	22
APOLLO PLAST TRAFFIC LIGHT	26
APOLLO PLAST TRAFFIC LIGHT - YELLOW	30
DOCK LAMPS	34
PEGASUS FLASHING LIGHT	38
SATURNO CONTROL UNIT	40
ACNSEM3L CONTROL UNIT	42



RACKS

45

NYLON	46
STEEL	60



CONTROL ACCESSORIES

64

SAFETY ACCESSORIES

65

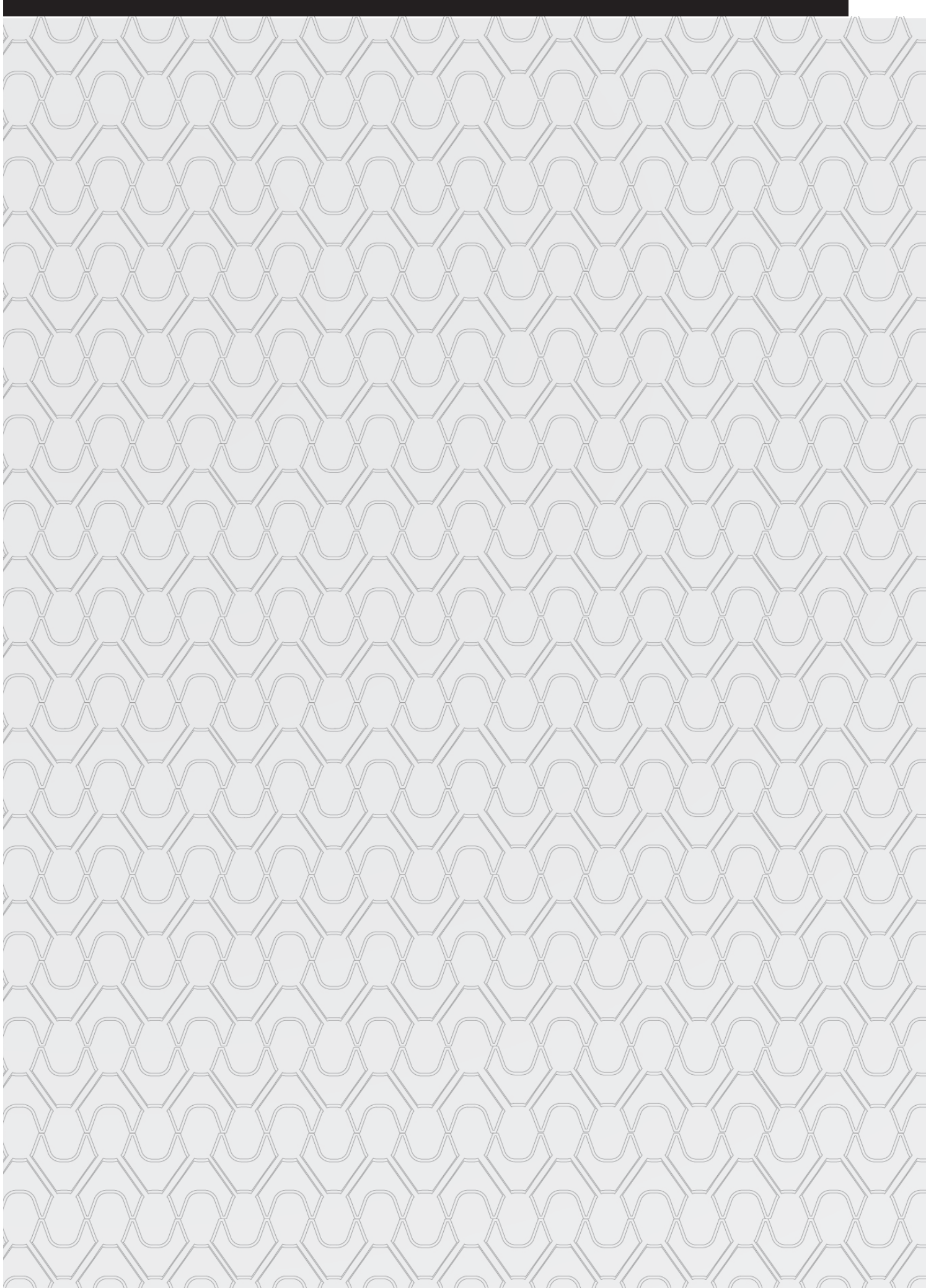



SIGNALING ACCESSORIES

07

ERA80 TRAFFIC LIGHT	08
ERA801L TRAFFIC LIGHT	12
ERA80 TRAFFIC LIGHT - YELLOW	14
ERA801L TRAFFIC LIGHT - YELLOW	16
CHRONOS TRAFFIC LIGHT	18
APOLLO TRAFFIC LIGHT ALLUMINUM	22
APOLLO PLAST TRAFFIC LIGHT	26
APOLLO PLAST TRAFFIC LIGHT - YELLOW	30
DOCK LAMPS	34
PEGASUS FLASHING LIGHT	38
SATURNO CONTROL UNIT	40
ACNSEM3L CONTROL UNIT	42

ERA80



A SUSTAINABLE ALLY

Our commitment towards the creation of sustainable products also includes the use of recycled materials in our production.

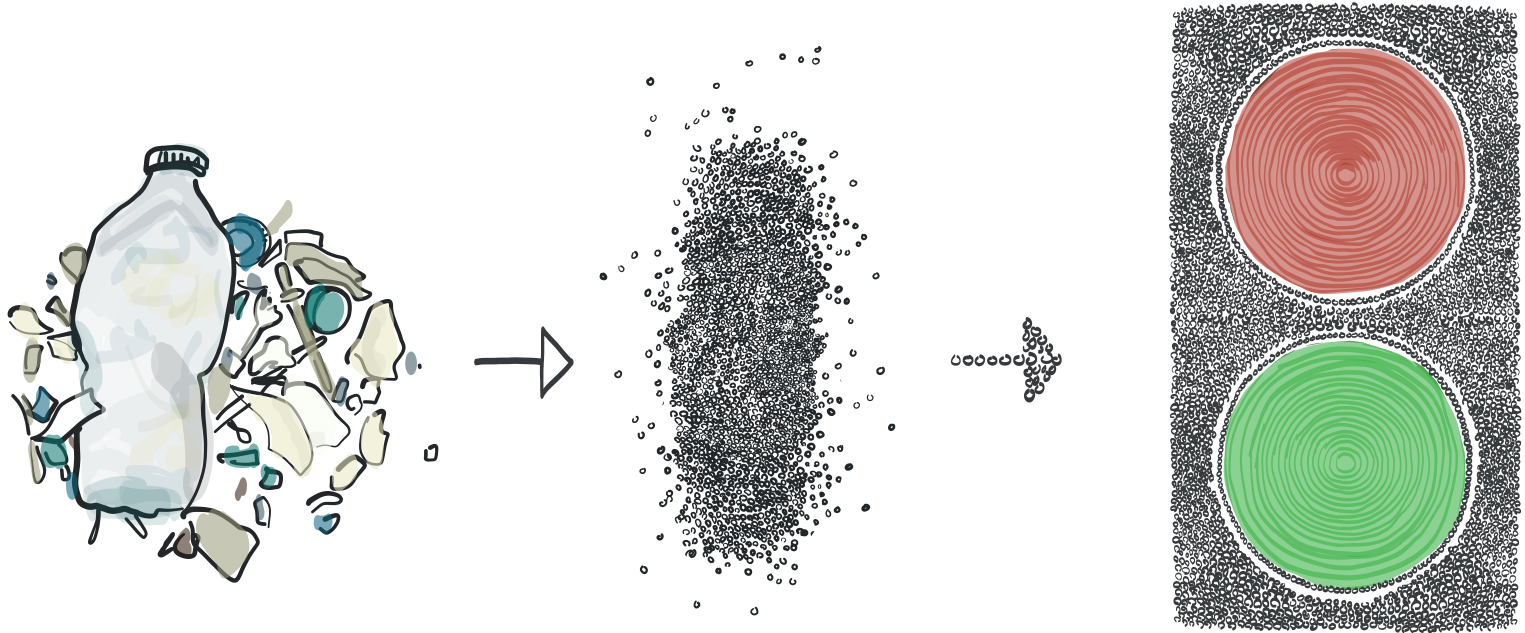

ERA 80 is a traffic light in post-consumer recycled plastic, the first of its kind in the world. Developed according to all principles of sustainable development: a lantern made in polyamide produced from industrial waste.

This traffic light is designed to meet high safety standards, with an attractive yet simple design.

It is a signaling product suitable for different contexts:

pedestrian crossings, parking lots, entrances in residential contexts.

ERA80 is not only a "design" product, but is most importantly a sustainable product, for meeting to the needs of a market getting increasingly sensitive to the issue of safety.

Product details

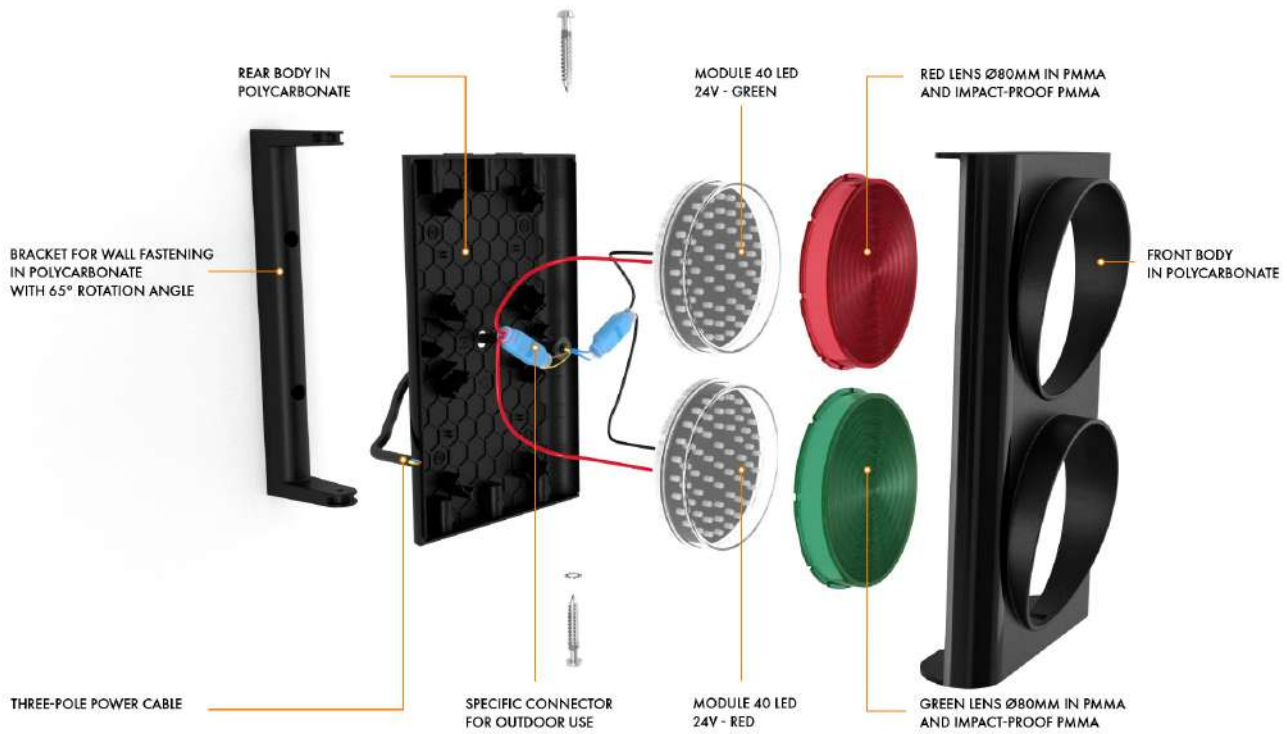

Models

VERTICAL



HORIZONTAL



Easy to install

ERA80 makes the installation process simple thanks to its new fixing systems, with bracket and wall fixing

VERTICAL WITH BRACKET



HORIZONTAL WITH BRACKET



VERTICAL WITHOUT BRACKET



HORIZONTAL WITHOUT BRACKET



APPLICATION WITH POLE BRACKET



Technical details

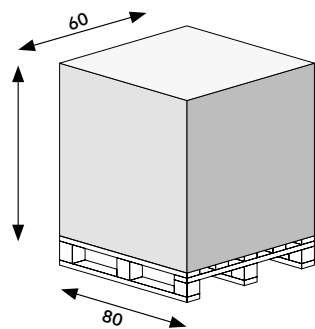

H120cm - pcs.48



TECHNICAL DATA	ASFERA80 Traffic light set, 2 lights	ASFERA80D Directional vertical traffic light, 2 lights	ASFERA80O Horizontal traffic light, 2 lights	ASFERA80OD Directional horizontal traffic light, 2 lights
Power supply	24V	24V	24V	24V
Rated absorbed current	0,13A	0,13A	0,13A	0,13A
Power	1,50W	1,50W	1,50W	1,50W
Brightness	120lx (±10lx)	120lx (±10lx)	120lx (±10lx)	120lx (±10lx)
Working temperature	-20/+55°	-20/+55°	-20/+55°	-20/+55°
IP	66	66	66	66
Number of LEDs	40	40	40	40

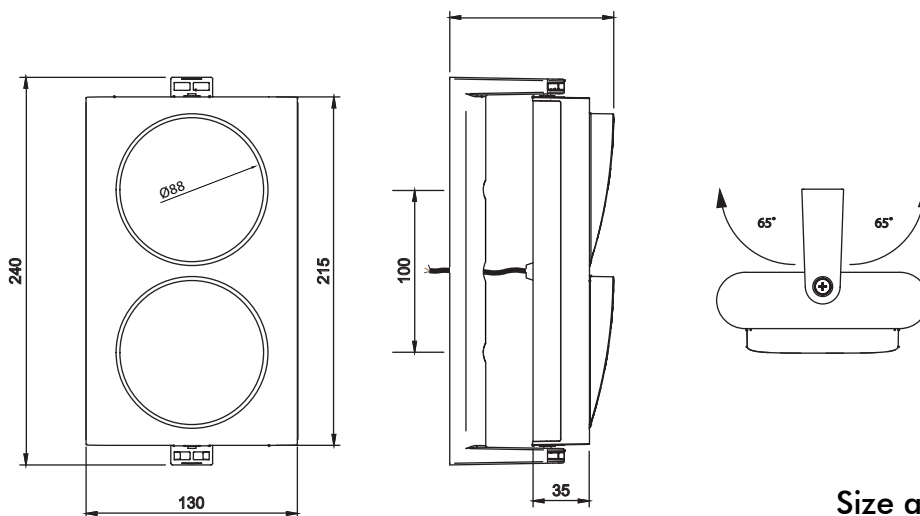

Size and bulk

Accessories



ASFERA80SP

Brackets for pole mounting

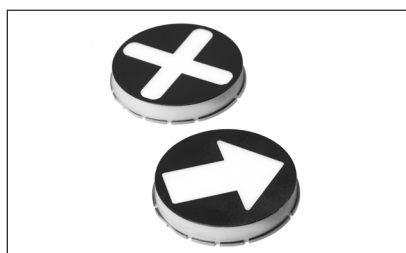

ASFERA80LD

Directional lenses kit



APS

Galvanized pole (Ø60mm)

ERA801L



EXTERNAL USE



EASY TO INSTALL

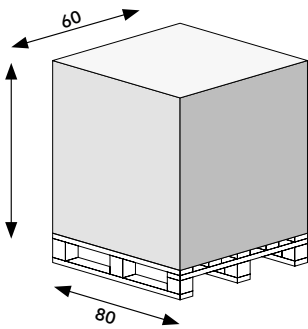

H120cm -
pcs.96



TECHNICAL DATA	ASFERA801LR	ASFERA801LV	ASFERA801LG
Power supply	24V	24V	24V
Rated absorbed current	0,13A	0,13A	0,13A
Power	1,50W	1,50W	1,50W
Brightness	120lx (+10lx)	120lx (+10lx)	120lx (+10lx)
Working temperature	-20/+55°	-20/+55°	-20/+55°
IP	66	66	66
Number of LEDs	40	40	40

VERTICAL WITH
BRACKET

VERTICAL WITHOUT
BRACKET

APPLICATION WITH POLE
BRACKET



ASFERA801LRV TWINCOLOR

Double coloring (red-green)
in one body with 40 LEDs (20 + 20) integrated.

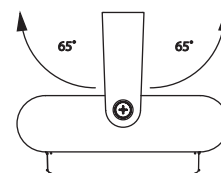
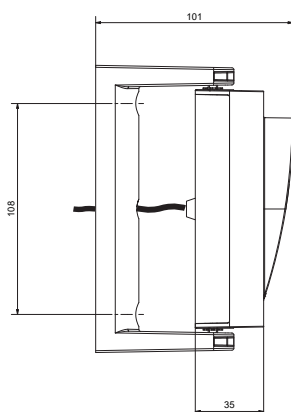
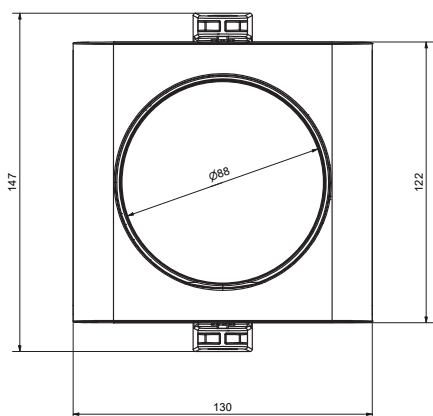
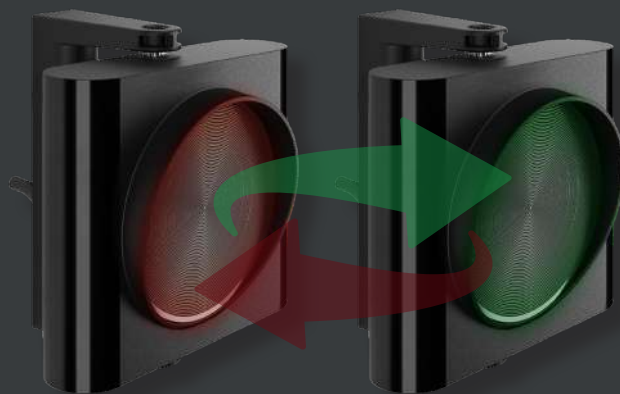

Size and bulk

Accessories



ASFERA80SP

Brackets for pole mounting

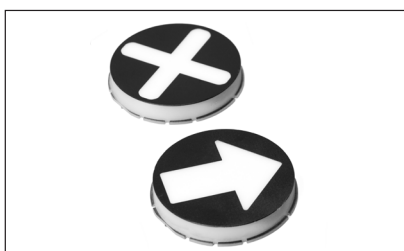

ASFERA80LD

Directional lenses kit



APS

Galvanized pole (Ø60mm)

ERA80

YELLOW

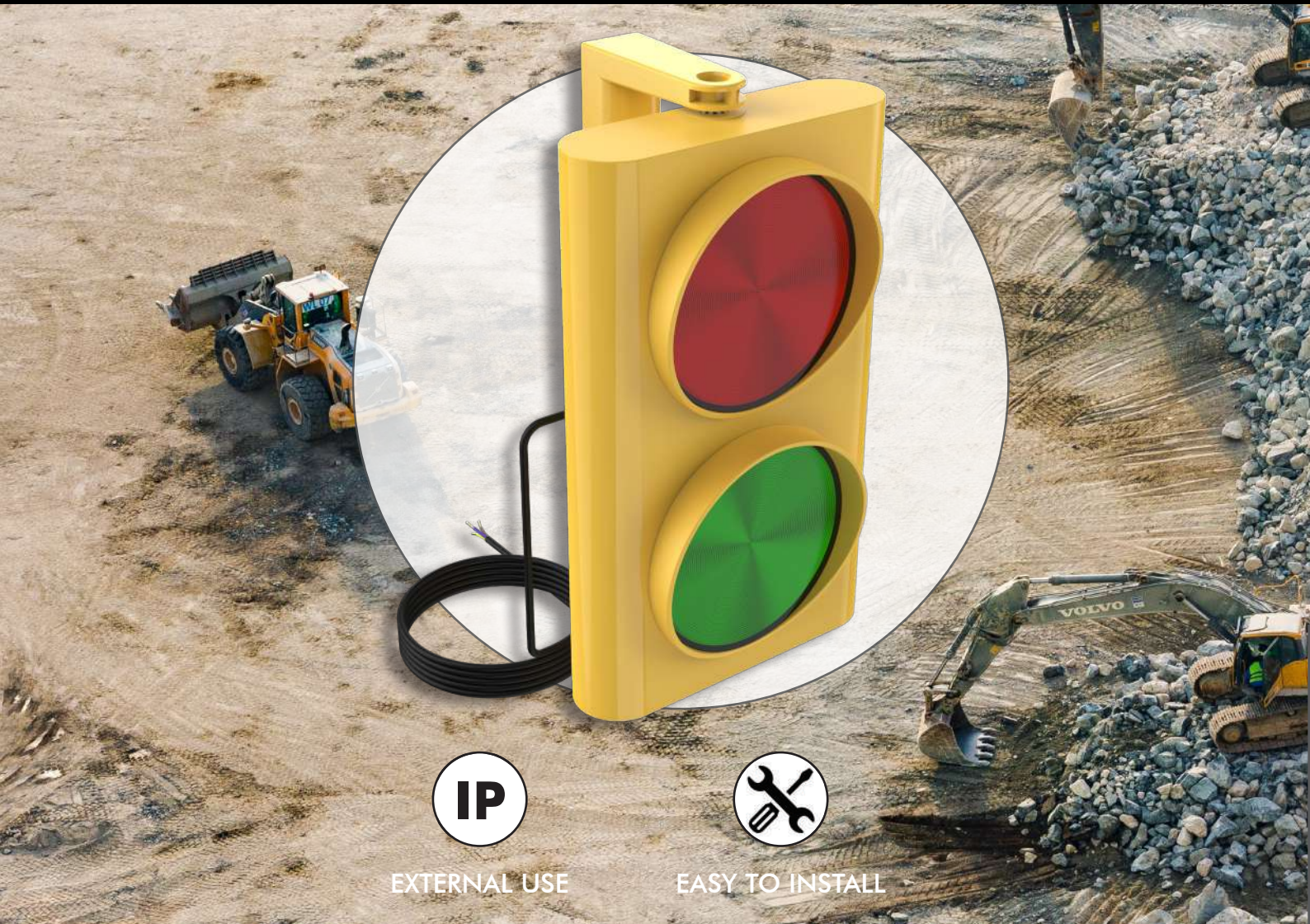

EXTERNAL USE



EASY TO INSTALL

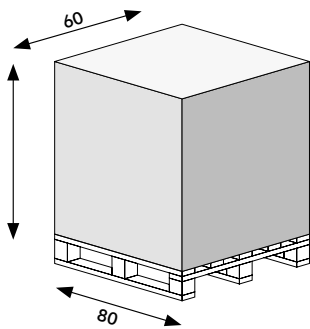

H120cm -
pcs.48

TECHNICAL DATA	ASFERA80Y Traffic light set, 2 lights	ASFERA80DY Directional vertical traffic light, 2 lights	ASFERA80OY Horizontal traffic light, 2 lights	ASFERA80ODY Directional horizontal traffic light, 2 lights
Power supply	24V	24V	24V	24V
Rated absorbed current	0,13A	0,13A	0,13A	0,13A
Power	1,50W	1,50W	1,50W	1,50W
Brightness	120lx (+10lx)	120lx (+10lx)	120lx (+10lx)	120lx (+10lx)
Working temperature	-20/+55°	-20/+55°	-20/+55°	-20/+55°
IP	66	66	66	66
Number of LEDs	40	40	40	40

ERA80 YELLOW TRAFFIC LIGHT

This traffic light is designed to meet high safety standards, with an attractive yet simple design. It is a signaling product suitable for different contexts: pedestrian crossings, parking lots, entrances in residential contexts.

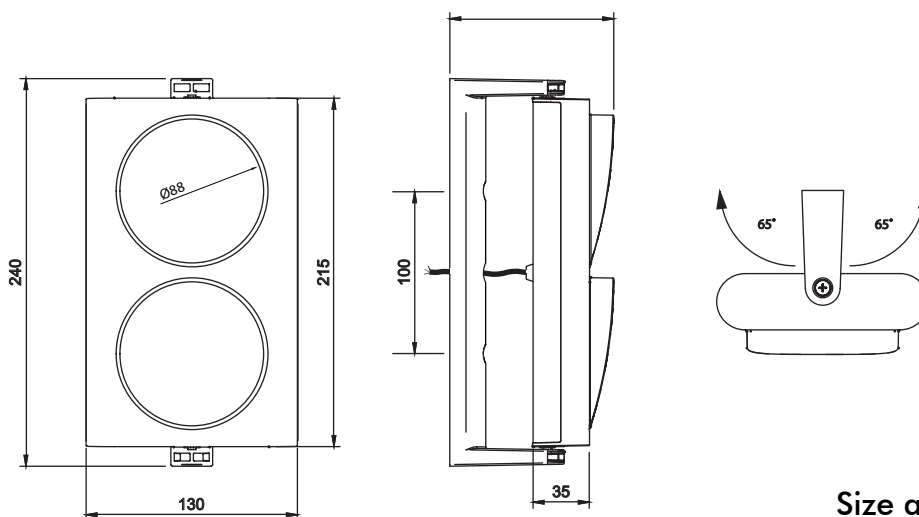

Size and bulk

Accessories



ASFERA80SP

Brackets for pole mounting

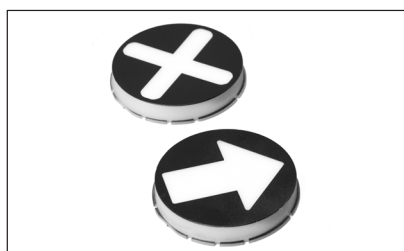

ASFERA80LD

Directional lenses kit



APS

Galvanized pole ($\varnothing 60\text{mm}$)

ERA801L

YELLOW



EXTERNAL USE



EASY TO INSTALL

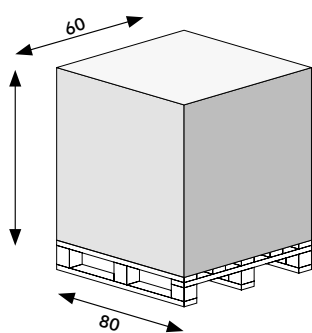

H120cm -
pcs.96



TECHNICAL DATA	ASFERA801LRY	ASFERA801LVY	ASFERA801LGY
Power supply	24V	24V	24V
Rated absorbed current	0,13A	0,13A	0,13A
Power	1,50W	1,50W	1,50W
Brightness	120lx (+10lx)	120lx (+10lx)	120lx (+10lx)
Working temperature	-20/+55°	-20/+55°	-20/+55°
IP	66	66	66
Number of LEDs	40	40	40

VERTICAL WITH
BRACKET

VERTICAL WITHOUT
BRACKET



ASFERA801LRVY TWINCOLOR

Double coloring (red-green)
in one body with 40 LEDs (20 + 20) integrated.

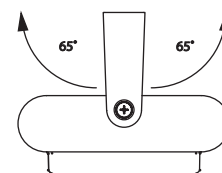
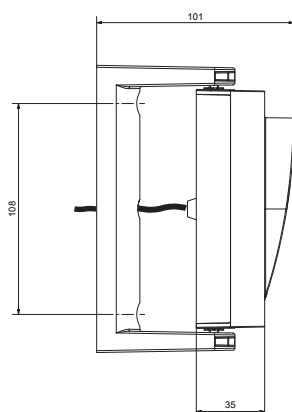
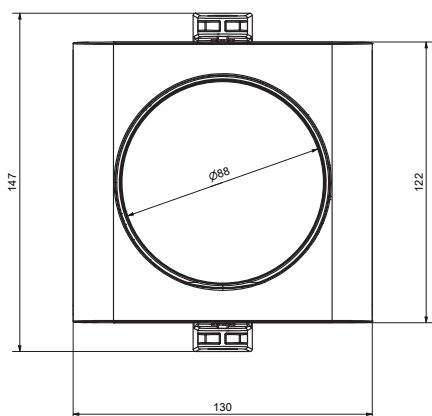
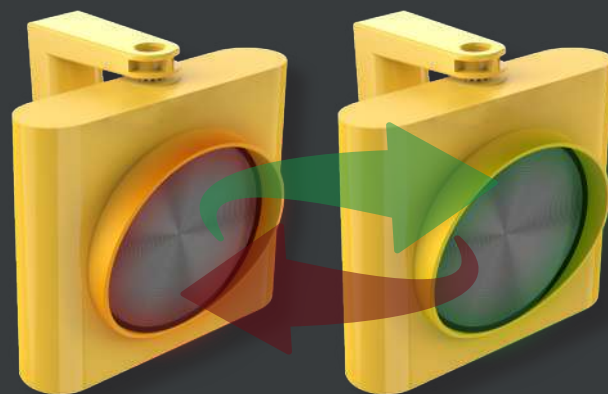

Size and bulk

Accessories



ASFERA80SP

Brackets for pole mounting



ASFERA80LD

Directional lenses kit



APS

Galvanized pole (Ø60mm)

CHRONOS









EXTERNAL USE

ONE POWER SOURCE

EASY TO INSTALL

ANTI-VANDALIC

Product	Code	Power supply (V)	Power (W)	Color	Number of lights	Brightness (lx)	Working Temperature (C°)	Number of LED's by color	Ø Lens mm	Protection (IP)	Weight (kg)	Pallet pcs.
	CHR1LG	24V ac/dc	2	●								
	CHR1LR	230V ac	5	●	1	19,4 - 47,8 (min - max)	-20/+55°	24	120	66	1.54	72
	CHR1LV			●								
	CHR2LRV	24V ac/dc	2	●	2	19,4 - 47,8 (min - max)	-20/+55°	24	120	66	2.40	48
		230V ac	5	●								
	CHR2LGG	24V ac/dc	2	●	2	19,4 - 47,8 (min - max)	-20/+55°	24	120	66	2.40	48
		230V ac	5	●								
	CHR3LRGV	24V ac/dc	2	●	3	19,4 - 47,8 (min - max)	-20/+55°	24	120	66	3.28	36
		230V ac	5	●								

SIZE AND BULK

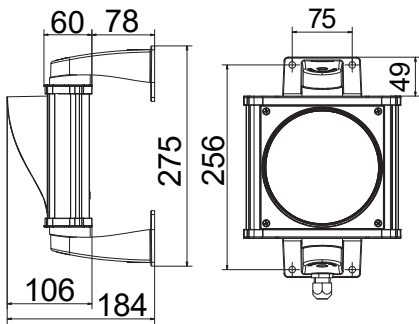

1-LIGHT TRAFFIC LIGHT

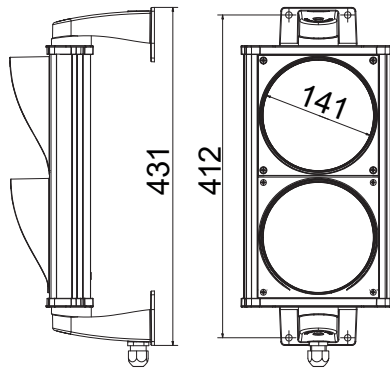

2-LIGHTS TRAFFIC LIGHT

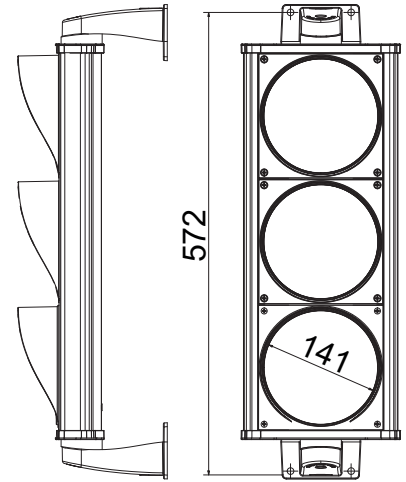

3-LIGHTS TRAFFIC LIGHT

FIELDS OF APPLICATION



GARAGES



LOGISTICS



CAR PARK

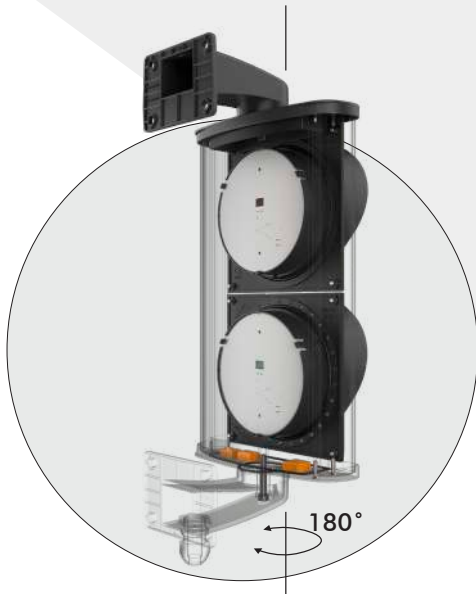

CHRONOS
 Composed of an aluminum profile, powder coated with internal reinforcements, technopolymer covers, for unsurpassed stiffness and mechanical resistance. Joint lens and sunshield, only one piece both waterproof and anti-leaking.

ROTATABLE AT 180° AND HIDDEN CABLE PASSAGE WITHIN THE BRACKET FOR MAXIMUM SAFETY.



A multivoltage traffic light, easy to wire as it automatically detects the incoming voltage (from 24 to 230V), 24 LEDs per lamp for optimal brightness, possibility to remove the electronics from the front, for both repair and maintenance works.

ACCESSORIES



CHRSM

55mm short bracket kit, 5mm for Chronos.



AMPS

Pair of brackets for hooking the traffic light onto the pole.



APS

Galvanized pole (Ø60mm) for traffic light support, length 3m.

APOLLO

ALUMINUM





EXTERNAL USE



ROTATABLE AT 200°



EASY TO INSTALL



ANTI-VANDALIC

Product	Code	Power supply (V)	Power (W)	Color	Number of lights	Brightness (lx)	Working Temperature (C°)	Number of LED's by color	Ø Lens mm	Protection (IP)	Weight (kg)	Pallet pcs.													
	ASF25L1R	24V ac/dc	2	●	1	50 (±5)	-30/+80°	25	120	65	1.42	72													
	ASF25L1G			●																					
	ASF25L1V			●																					
	ASF25L1R230	230V ac	5	●							1		50 (±5)	-30/+80°	25	120	65	1.50	72						
	ASF25L1G230			●																					
	ASF25L1V230			●																					
ASF1R	230V ac	70	●	2	900	-30/+80°	BULB	120	65	1.50		48													
ASF1G			●																						
ASF1V			●																						
	ASF25L2RV	24V ac/dc	2							● ●	2		50 (±5)	-30/+80°	25	120	65	2.85	48						
	ASF25L2RVC									● ●															
	ASF25L2RR									● ●															
	ASF25L2RVD			● ●																					
	ASF50L1RV-01	230V ac	5	● ●	2	50 (±5)	-30/+80°	25	120	65		3.20						48							
	ASF25L2RR230			● ●																					
	ASF25L2RV230			● ●																					
	ASF50L1RV230-01			● ●																					
ASF25L2RV230D	230V ac	70	●	3							900	-30/+80°	BULB	120	65	3.42	36								
ASF25L2RVC230			●																						
ASF2RV	24V ac/dc	2	● ● ●													3			50 (±5)	-30/+80°	25	120	65	3.90	36
ASF25L3GRV	230V ac	5	● ● ●																						
ASF25L3GRV230	230V ac	70	●		3	900	-30/+80°	BULB	120	65								3.90						36	
ASF3GRV			●																						

BULK SIZE AND PALLET

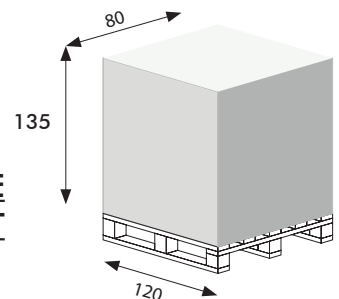

SIZE AND BULK

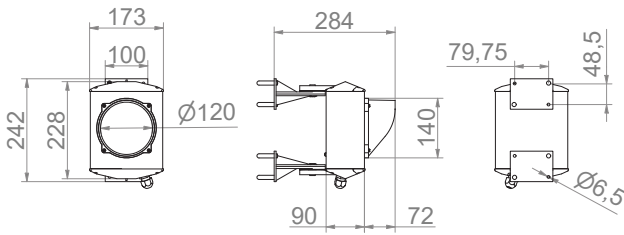

1 LAMP TRAFFIC LIGHT

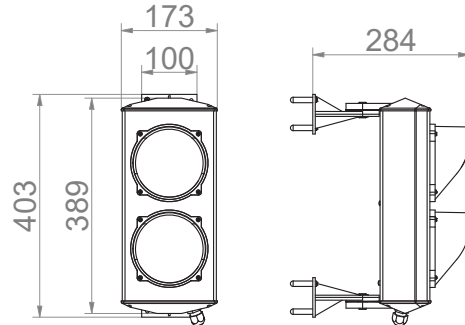

2 LAMP TRAFFIC LIGHT

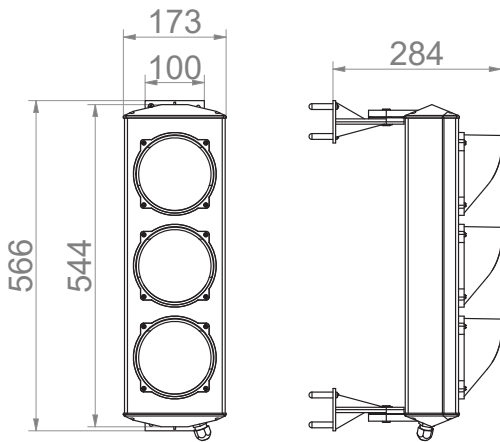

3 LAMP TRAFFIC LIGHT

FIELDS OF APPLICATION



AIRPORT



LOGISTICS



CONSTRUCTION SITES



TWIN COLOR
TRAFFIC LIGHT
CODE: ASF50L1RV-01
ASF50L1RV230-01

Double coloring
(red-green)
in one body with **50 LEDs**
(25 + 25) integrated

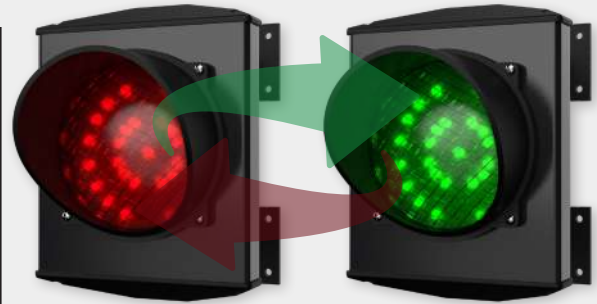

DIRECTIONAL TWO-LENS
TRAFFIC LIGHT
CODE: ASF25L2RVD
ASF25L2RV230D

Traffic light supplied with an adjustable arrow and a cross. Lens printed through a screen printing process. Neutral lens color and technical features matching those of a 2-lamps traffic lights.

TRAFFIC LIGHT WITH QUICK
MALE/FEMALE
CONNECTION

CODE: ASF25L2RVC
ASF25L2RV230C

Traffic light supplied with external quick connection with male/female coupling, same features of the 2-lamps traffic light.



ACCESSORIES

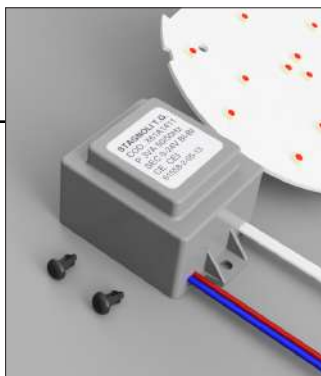

ASFK230

Conversion kit for allowing use of Apollo traffic lights from 24V to 230V.



AMPS

Pair of brackets for hooking the traffic light onto the pole.



APS

Galvanized pole (Ø60mm) for traffic light support, length 3m.



ARSFPOF-10
ARSFPOX-10

Directional lenses kit 10 pcs. Apollo.

APOLO PLAST





EXTERNAL USE



ROTATABLE AT 130°



EASY TO INSTALL



ANTI-VANDALIC

Product	Code	Power supply (V)	Power (W)	Color	Number of lights	Brightness (lx)	Working Temperature (C°)	Number of LED's by color	Ø Lens mm	Protection (IP)	Weight (kg)	Pallet pcs.
	ASFR	24V ac/dc	1,5	●	1	35 (±5)	-20/+55°	18	120	65	0.60	144
	ASFG			●								
	ASFV			●								
	ASFR230	230V ac	3	●								
	ASFG230			●								
	ASFV230			●								
	ASF36L1RV	24V ac/dc	1,5	● ●	1	35 (±5)	-20/+55°	18	120	65	0.60	144
	ASF36L1RV230	230V ac	3	● ●								
	ASFRV	24V ac/dc	1,5	● ●	2	35 (±5)	-20/+55°	18	120	65	0.60	48
	ASFRV230	230V ac	3	● ●								

**BULK SIZE
AND
PALLET**

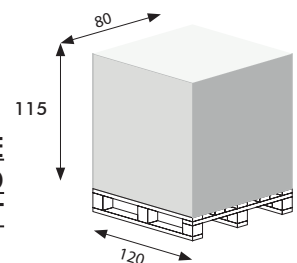

SIZE AND BULK

1- LAMPS TRAFFIC LIGHT

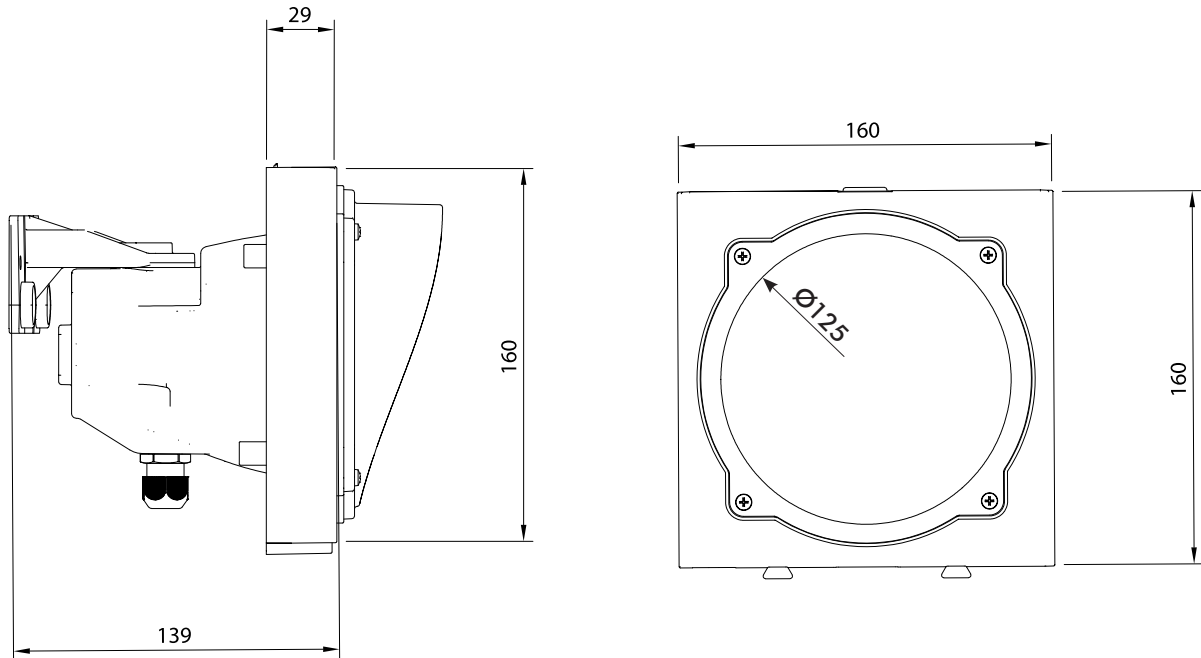

FIELDS OF APPLICATION



AIRPORT



LOGISTICS



CONSTRUCTION SITES



**TWIN COLOR
TRAFFIC LIGHT
CODE: ASF36L1RV
ASF36L1RV230**

Double coloring
(red-green) in one body with
36 LEDs (18+18) integrated.



MODULARITY OF BODIES

The clips placed
below the traffic light allow
for easy modulation of the
traffic light, from 2 to 3
bodies.



CHANNEL CLIP

for hiding the cable and prevent its
visibility.

ACCESSORIES

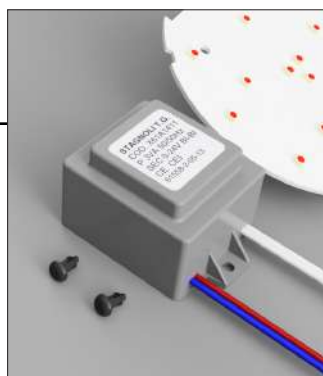

ASF230

Conversion kit for
allowing use of Apollo
traffic lights from 24V
to 230V.



AMPS

Pair of brackets for
hooking the traffic light
onto the pole.



APS

Galvanized pole
(Ø60mm) for traffic
light support,
length 3m.



**ARSFPOF-10
ARSFPOX-10**

Directional lenses
kit 10 pcs. Apollo.

APOLLO PLAST

YELLOW



EXTERNAL USE



ROTATABLE AT 130°



EASY TO INSTALL



ANTI-VANDALIC

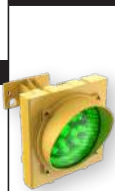

Product	Code	Power supply (V)	Power (W)	Color	Number of lights	Brightness (lx)	Working Temperature (C°)	Number of LED's by color	Ø Lens mm	Protection (IP)	Weight (kg)	Pallet pcs.
	ASFRY	24V ac/dc	1,5		1	35 (±5)	-20/+55°	18	120	65	0.60	144
	ASFGY											
	ASFVY											
	ASFR230Y	230V ac	3		1	35 (±5)	-20/+55°	18	120	65	0.60	144
	ASFG230Y											
	ASFV230Y											
	ASF36L1RVY	24V ac/dc	1,5	 	1	35 (±5)	-20/+55°	18	120	65	0.60	144
	ASF36L1RV230Y	230V ac	3	 							0.98	
	ASFRVY	24V ac/dc	1,5	 	2	35 (±5)	-20/+55°	18	120	65	0.60	48
	ASFRV230Y	230V ac	3	 							0.98	



**TWIN COLOR
TRAFFIC LIGHT**
**CODE: ASF36L1RVY
ASF36L1RV230Y**
Double coloring
(red-green) in one body with
36 LEDs (18+18) integrated.

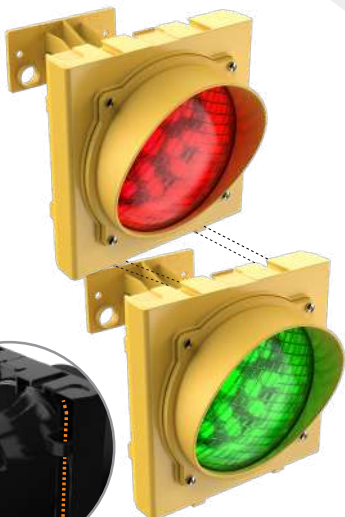

MODULARITY OF BODIES

The clips placed below the traffic light allow for easy modulation of the traffic light, from 2 to 3 bodies.

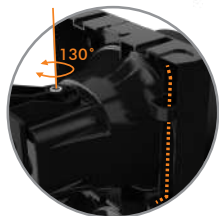

CHANNEL CLIP

for hiding the cable and prevent its visibility.



FIELDS OF APPLICATION



MINES



QUARRY



CONSTRUCTION SITES



CUSTOMIZATIONS OF OUR PRODUCTS

ON CUSTOMER DEMAND, STAGNOLI OFFERS A LENS CUSTOMIZATION SERVICE FOR THE PRODUCTS: APOLLO, APOLLO PLAST.

ARSFPO-08



ARSFPO-05



ARSFPO-04



ARSFPO-02



ARSFPO-10



ARSFPO-09



ARSFPO-06



ARSFPO-03



ARSFPO-07



ARSFPO-01





	APOLLO ALUMINUM	APOLLO PLAST	CHRONOS	ERA80
MATERIALS	ALLUMINUM + NYLON	NYLON	ALLUMINUM	POLYCARBONATE
NUMBER OF LED'S	25	18	18	40
BRIGHTNESS [LX]	50	40	70	120
IP	65	65	66	56
MODULAR	×	✓	×	×
POWER SUPPLY [V AC/DC]	24/230	24/230	24 › 230	24
CABLE PASSAGE	EXTERNAL	EXTERNAL	INTERNAL	EXTERNAL
LENT SIZE [MM]	120	120	120	80
CUSTOM LENS	✓	✓	×	✓

LAMPS

FOR DOCKING STATIONS



EXTERNAL USE



EAST TO INSTALL

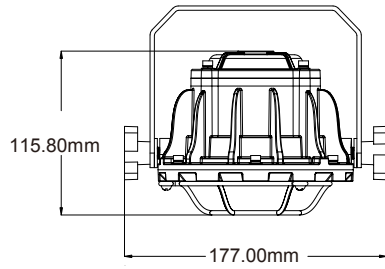

LED lamps system from 30W to 50W for docking stations, configurable with single 100-150cm and double 100-150cm supports.

ALPDC30**ROUND LED LOADING DOCK LIGHT 30W**

CODE	POWER (W)	POWER SUPPLY (Vac)	BRIGHTNESS (lm)	PROTECTION (IP)	BEAM ANGLE	WEIGHT (kg)
ALPDC30	30	100-240	3300	65	110°	1,60

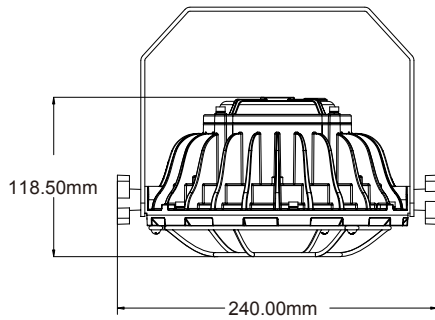
ALPDC50**ROUND LED LOADING DOCK LIGHT 50W**

CODE	POWER (W)	POWER SUPPLY (Vac)	BRIGHTNESS (lm)	PROTECTION (IP)	BEAM ANGLE	WEIGHT (kg)
ALPDC50	50	100-240	5500	65	110°	2,52

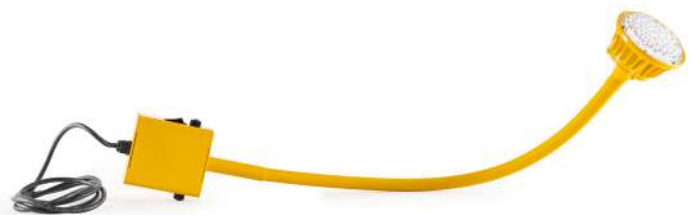
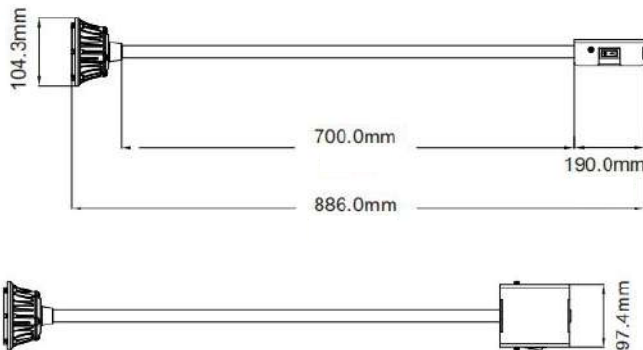
ALPDF20**LED GOOSENECK DOCK LIGHT 20W**

CODE	POWER (W)	POWER SUPPLY (Vac)	BRIGHTNESS (lm)	PROTECTION (IP)	BEAM ANGLE	WEIGHT (kg)
ALPDF20	20	100-240	3000	65	20°	2,56

ALPDB100S

BRACKET SINGLE ARM 100CM

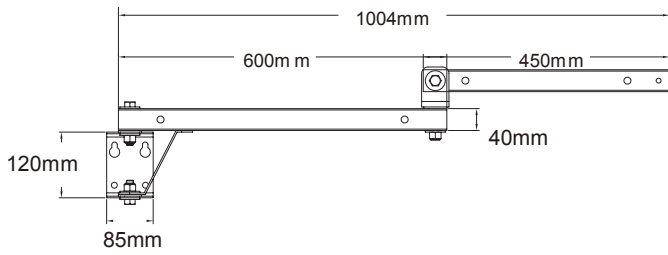

ALPDB150S

BRACKET SINGLE ARM 150CM

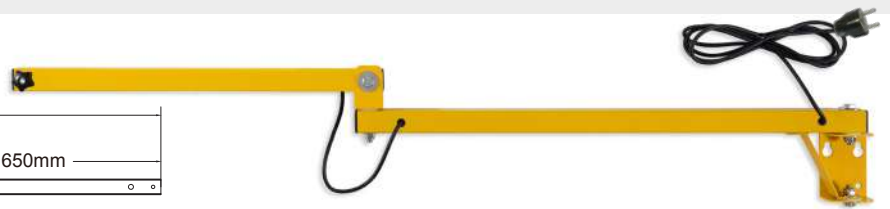
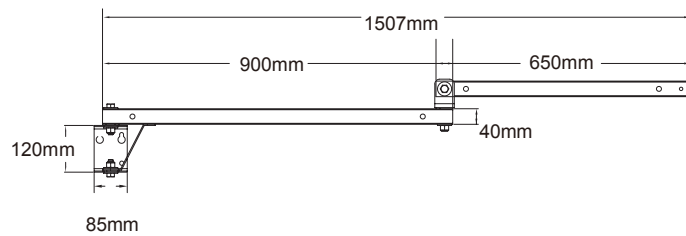

ALPDB100D

BRACKET DOUBLE ARM 100CM

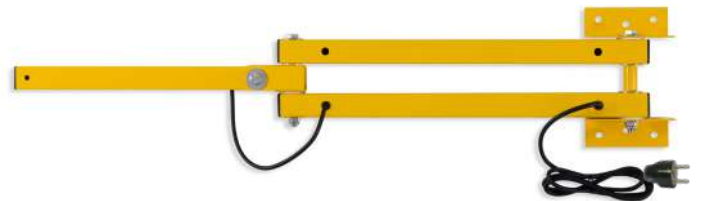
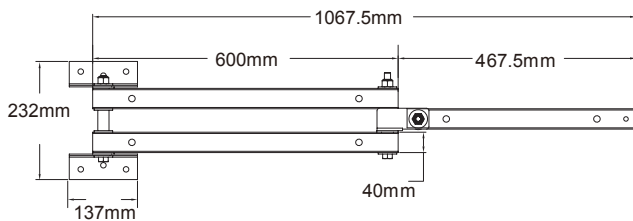

ALPDB150D

BRACKET DOUBLE ARM 150CM

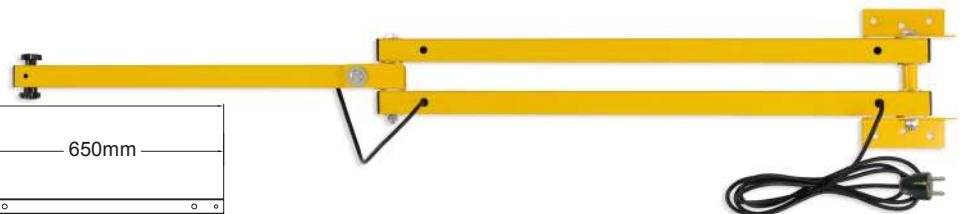
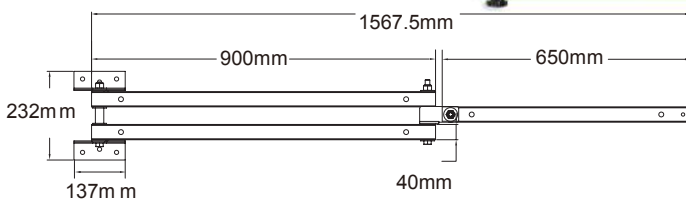

ALPDB100DP

BRACKET DOUBLE ARM 100CM BUILT-IN RECEPTACLE

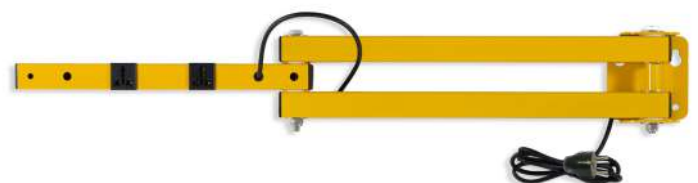
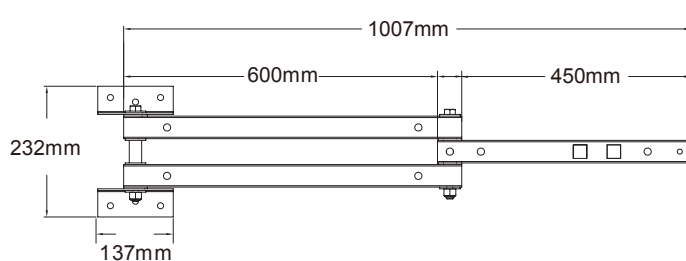

PEGASUS



APNL

APAL

APGL



Pegasus LED flashing light with integrated antenna and multi-power supply

Multi voltage 12-24-230V ac/dc

- Steady or flashing light
- Design (2003 Design Award)
- Integrated antenna (433MHz)

ACCESSORIES



KAFPG

Gray wall fixing support, complete with screws and gaskets

SATURNO



1Km
485

WEB
APP

10

FICLIGHT
MAFORI
FEU

WIFI
NET

PRIORITY
TIME BASED
CAR COUNTER
GREEN
WAVE

AUX
CONTACT



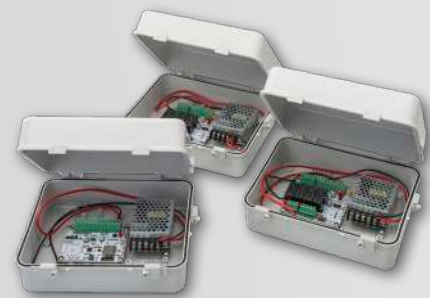
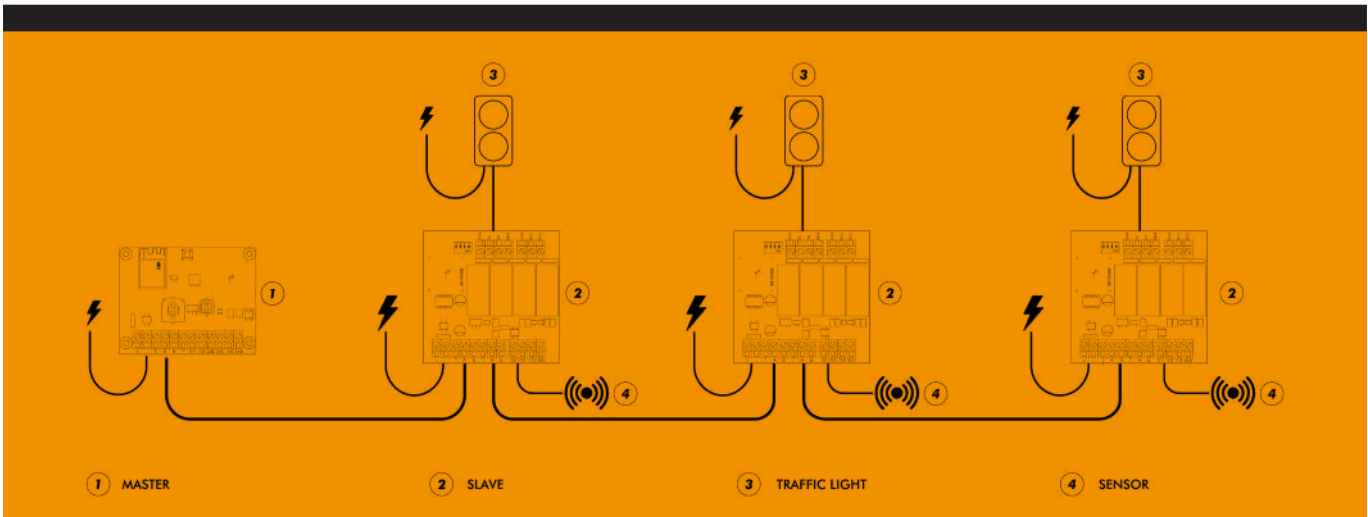

Code		Power supply	Working time	Protection
		(V)	(C°)	(IP)
SATURNO-S	Slave	230	-20/+ 50°	45
SATURNO-M	Master			
SATURNO-K	Kit: 1 master, 2 Slave			

Saturno is a control panel created for satisfying all kinds of installers' requests. From integrated time management to area management for up to 10 traffic lights for each installation. All these features have been improved thanks to a 2.0 technology, without any help from third parties. Simply use the internal wi-fi network included in the Saturno panel.



MULTI-FLOOR PARKING LOTS MANAGEMENT



MULTI-ENTRANCE PARKING LOTS MANAGEMENT



ALTERNATE ONE-WAY MANAGEMENT

ACNSEM3L



The ACNSEM3L is a card for handling two traffic lights with 2 or 3 lamps. It allows to equally manage 12-24 or 230 V ac/dc lanterns. With its two modes of operation, the first one being cyclical and time based and the other one logics-priority based with external sensors, it is particularly suitable for managing alternate merges, especially on ramps or slides with poor visibility.

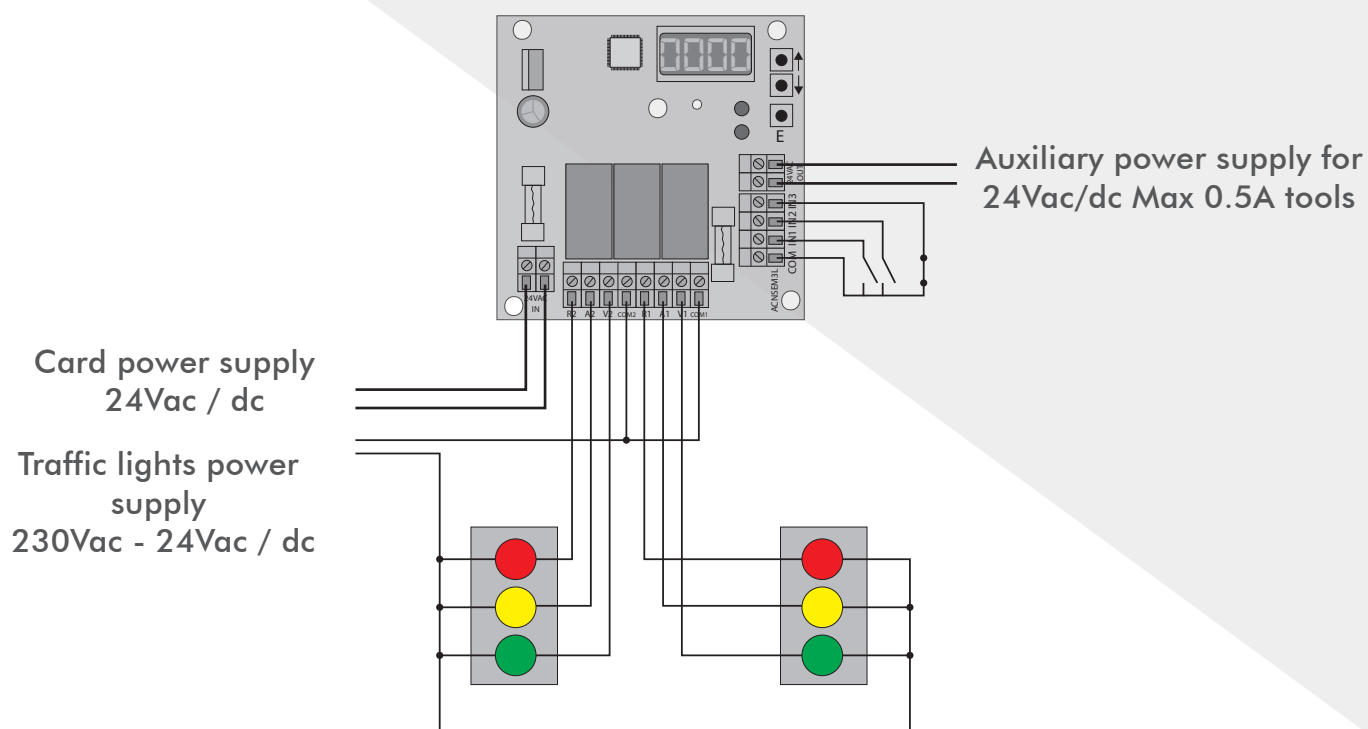

Code	Power supply
	(V)
ACNSEM3L	24
ACNSEM3L230	230

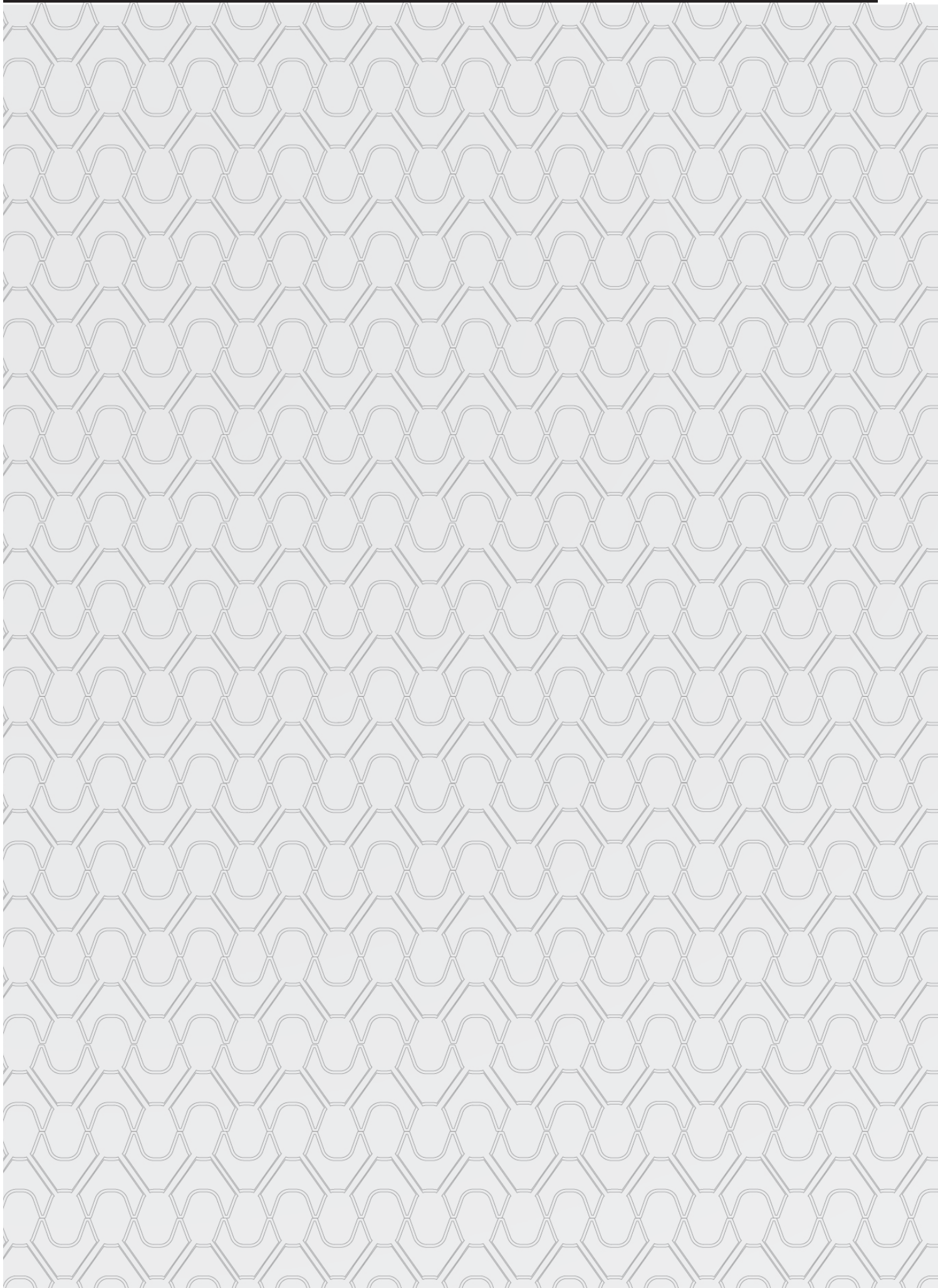

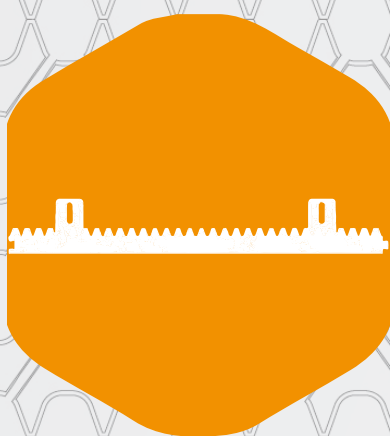

RACKS

45

**NYLON
STEEL**

**46
60**



Benefits of our nylon racks

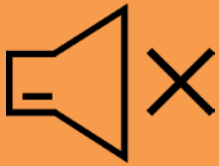

Silent



Self-lubricating



Light



Rust-proof

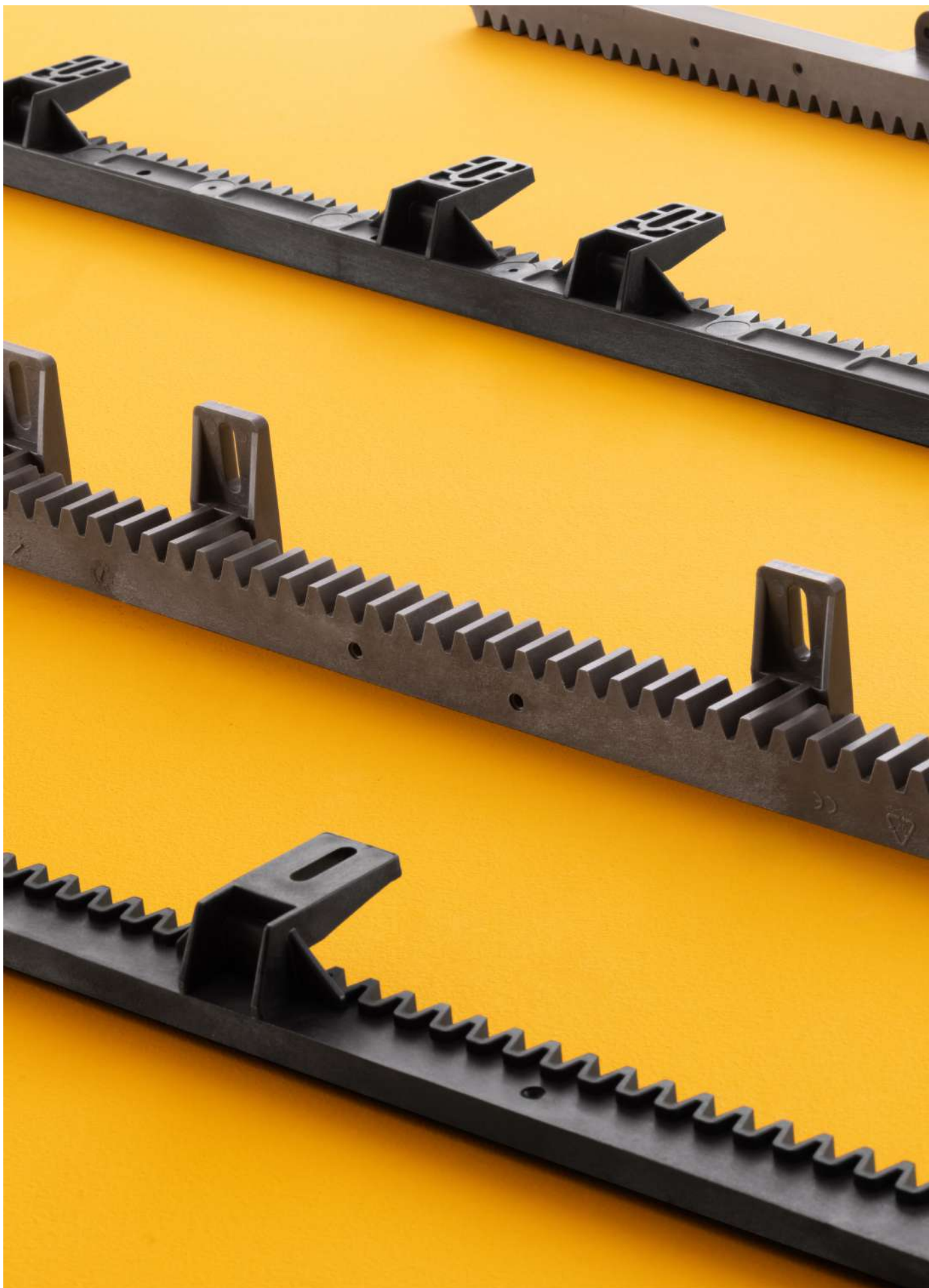



Rack **without steel core**, entirely in technopolymer, thanks to the geometries studied by Stagnoli, it is completely deformation-proof. **The presence of 5 central attachments and dual toothing** allows for use of the rack in both directions without distinction, making it perfectly symmetrical. This rack is tested for gates with a maximum capacity of **500Kg**.

New
rack
ACRN5

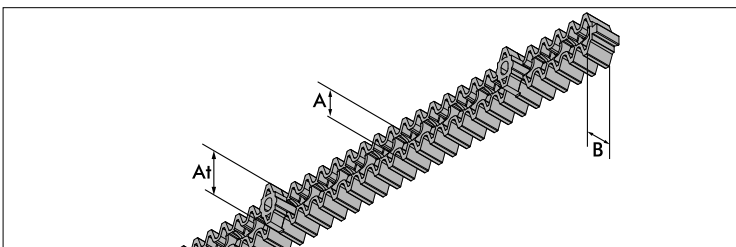
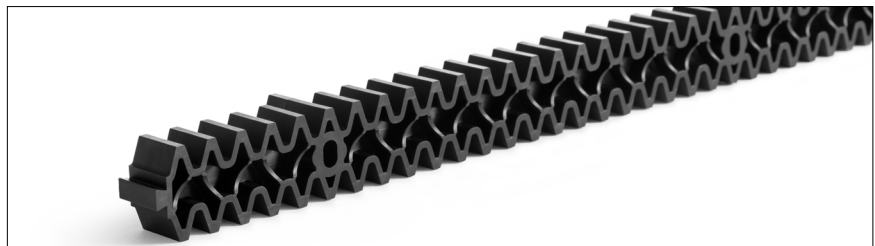

AVAILABLE ACCESSORIES

- SACN5

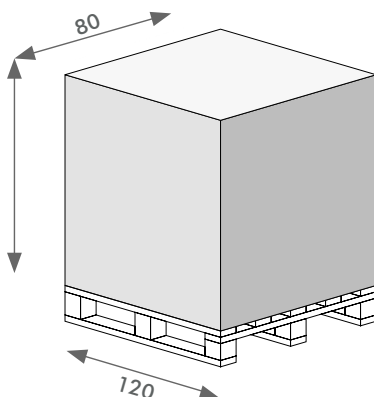

**SIZE
AND PALLET BULK**

Rack/Pallet
1020 m - h 100 cm

ACRN5	
B Width:	20 mm
A Part height:	14 mm
Total height:	32 mm
Length:	1000 x 6=(6000)mm
Weight:	0,36x6=(2,16)kg
Range:	500 Kg
Number of fit:	5



S6-1200

M4X1200 RACK, COLOR

GREY with upper attachments for gates of up to 1200Kg, thanks to reinforced hooks and the special material used for its construction.

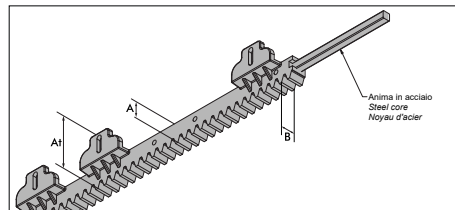

AVAILABLE ACCESSORIES

- SAC014
- ACRFF

PALLET SIZE AND BULK

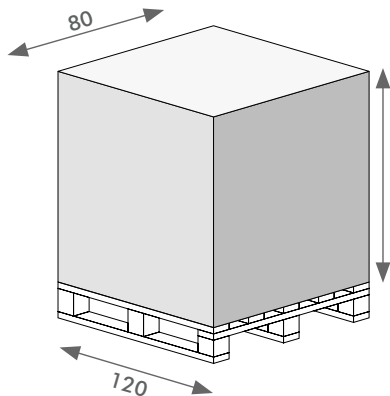

Rack/Pallet
300 m - h 60 cm
600 m - h 120 cm

S6-1200	
B Width:	20 mm
A Part height:	28 mm
Total height:	60 mm
Length:	1.000 mm
Weight:	1.336 g
Range:	1.200 Kg
Number of fit:	6

Steel core



Square shape alignment system



V6-1200

M4X1200 RACK, COLOR

GREY with lower cantilevered attachments for gates up to 1200Kg, thanks to reinforced hooks and the special material used for its construction.

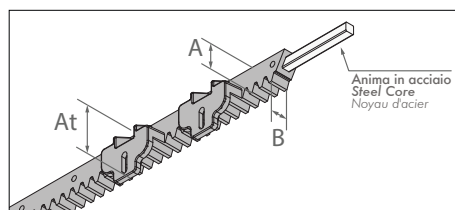

AVAILABLE ACCESSORIES

- SAC014
- ACRFF

PALLET SIZE AND BULK

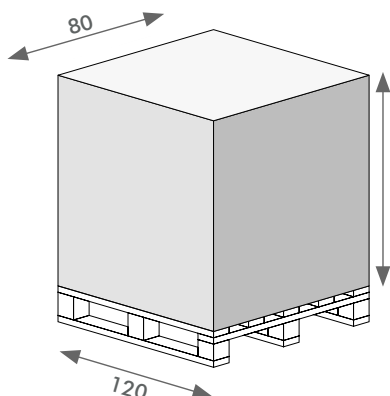

Rack/Pallet
300 m - h 60 cm
600 m - h 120 cm

V6-1200	
B Width:	20 mm
A Part height:	28 mm
Total height:	60 mm
Length:	1.000 mm
Weight:	1.336 g
Range:	1.200 Kg
Number of fit:	6

Steel core



Square shape alignment system



ACRV6

M4X1000 RACK, COLOR GREY with 6 lower cantilevered attachments, for gates with a maximum capacity of 800 Kg.

AVAILABLE ACCESSORIES

- SAC012
- ACRFF

PALLET SIZE AND BULK

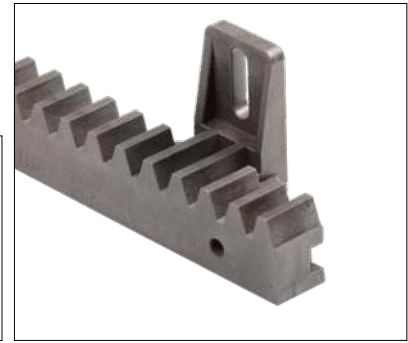
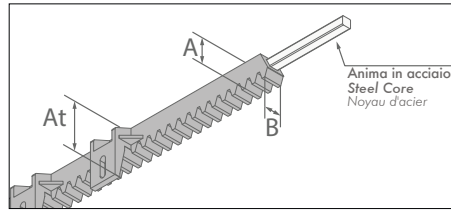
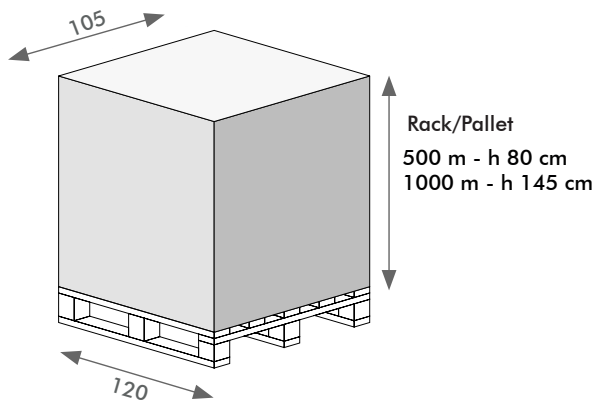

ACRV6

B Width:	20 mm
A Part height:	28 mm
Total height:	60 mm
Length:	1.000 mm
Weight:	1.328 g
Range:	800 Kg
Number of fit:	6

Steel core



Square shape alignment system



ACRV6B

M4X1000 RACK, COLOR WHITE with 6 lower cantilevered attachments, for gates with a maximum capacity of 800 Kg.

AVAILABLE ACCESSORIES

- SAC012
- ACRFF

PALLET SIZE AND BULK

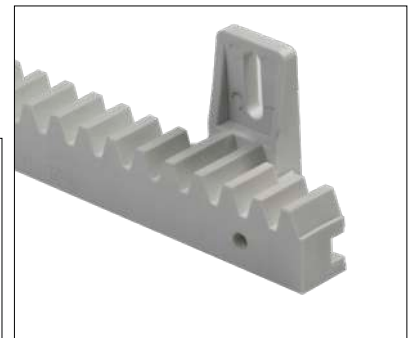
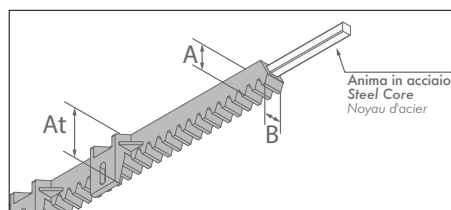
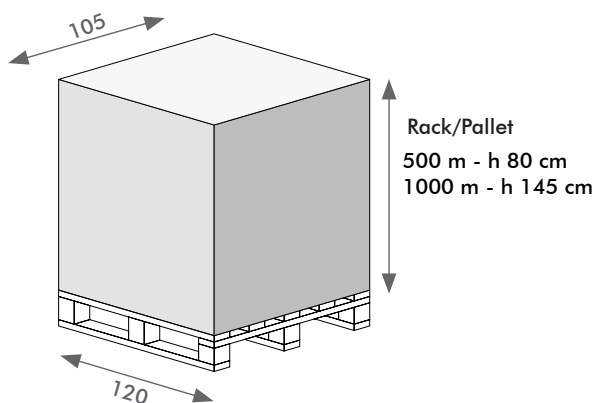

ACRV6B

B Width:	20 mm
A Part height:	28 mm
Total height:	60 mm
Length:	1.000 mm
Weight:	1.328 g
Range:	800 Kg
Number of fit:	6

Steel core



Square shape alignment system





ACRS6

M4X1000 RACK, COLOR GREY with 6 upper cantilevered attachments, for gates with a maximum capacity of 800 Kg.

AVAILABLE ACCESSORIES

- SAC012
- ACRFF

PALLET SIZE AND BULK

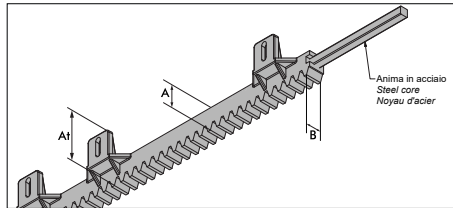
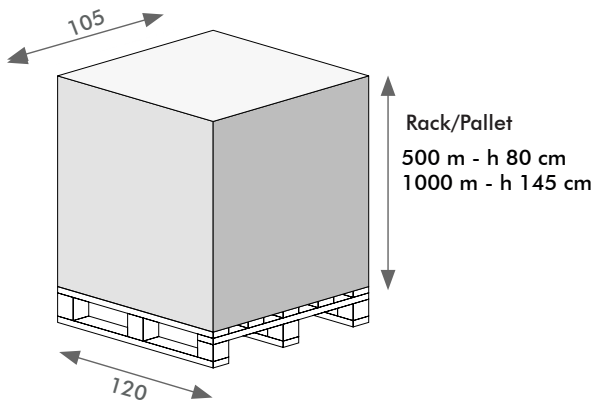

ACRS6

B Width:	20 mm
A Part height:	28 mm
Total height:	60 mm
Length:	1.000 mm
Weight:	1.318 g
Range:	800 Kg
Number of fit:	6

Steel core



Square shape alignment system



ACRS6N

M4X1000 RACK, COLOR BLACK with 6 upper cantilevered attachments, for gates with a maximum capacity of 700 Kg.

AVAILABLE ACCESSORIES

- SAC012
- ACRFF

PALLET SIZE AND BULK

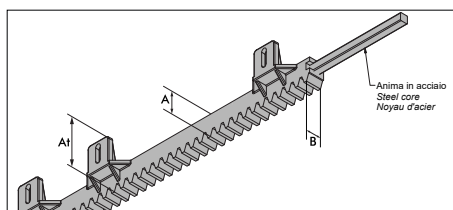
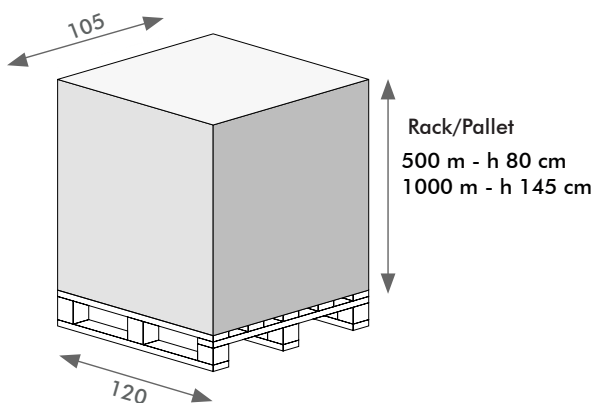

ACRS6N

B Width:	20 mm
A Part height:	28 mm
Total height:	60 mm
Length:	1.000 mm
Weight:	1.318 g
Range:	700 Kg
Number of fit:	6

Steel core



Square shape alignment system



ACRN6

M4X1000 RACK, COLOR BLACK with 6 lower cantilevered attachments, for gates with a maximum capacity of 700 Kg.

AVAILABLE ACCESSORIES

- SAC012
- ACRFF

PALLET SIZE AND BULK

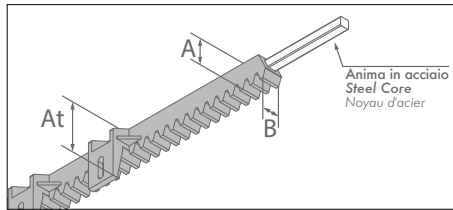
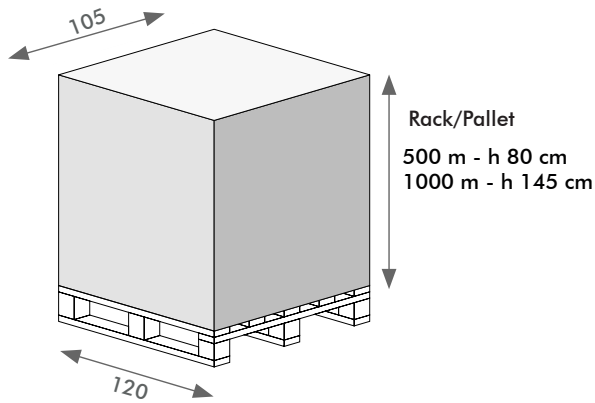

ACRN6

B Width:	20 mm
A Part height:	28 mm
Total height:	60 mm
Length:	1.000 mm
Weight:	1.328 g
Range:	700 Kg
Number of fit:	6

Steel core



Square shape alignment system



N6C - N6CH

M4X1000 RACK, COLOR BLACK with 6 lower cantilevered attachments, for gates with a maximum capacity of 700 Kg.

AVAILABLE ACCESSORIES

- SAC012
- ACRFF

PALLET SIZE AND BULK

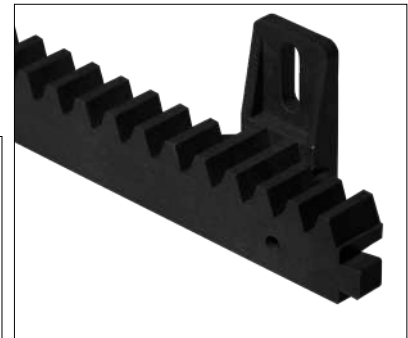
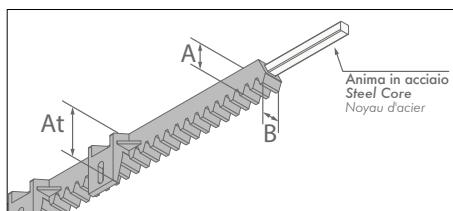
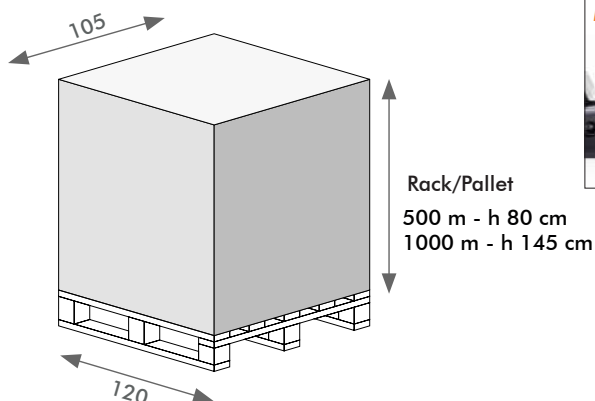

N6C



N6CH



N6C - N6CH

B Width:	20 mm
A Part height:	28 mm
Total height:	60 mm
Length:	1.000 mm
Weight:	1.328 g
Range:	700 Kg
Number of fit:	6

Steel core



Overtail alignment system





ACRV4

M4X1000 RACK, COLOR GREY with 4 lower cantilevered attachments, for gates with a maximum capacity of 500 Kg.

AVAILABLE ACCESSORIES

- SAC013
- ACRFF

PALLET SIZE AND BULK

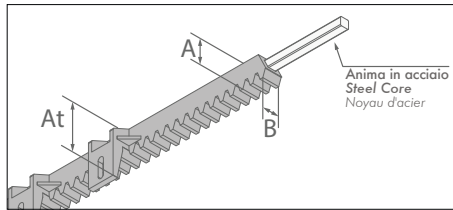
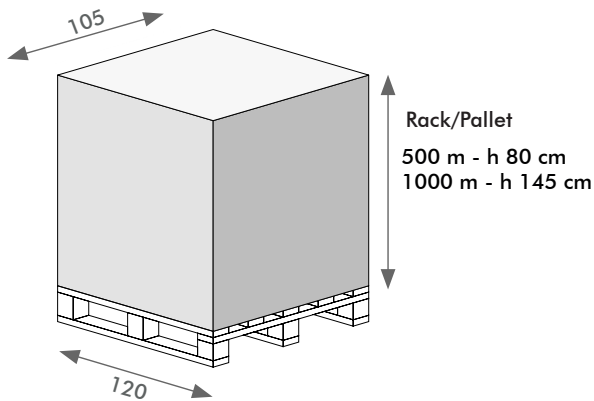

ACRV4

B Width:	20 mm
A Part height:	28 mm
Total height:	60 mm
Length:	1.000 mm
Weight:	1.318 g
Range:	500 Kg
Number of fit:	4

Steel core



Dovetail alignment system



ACRN4

M4X1000 RACK, COLOR BLACK with 4 lower cantilevered attachments, for gates with a maximum capacity of 400 Kg.

AVAILABLE ACCESSORIES

- SAC013
- ACRFF

PALLET SIZE AND BULK

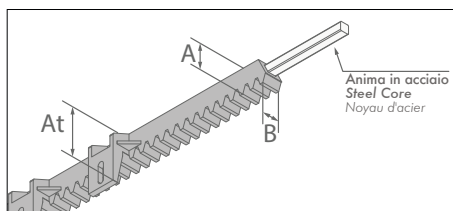
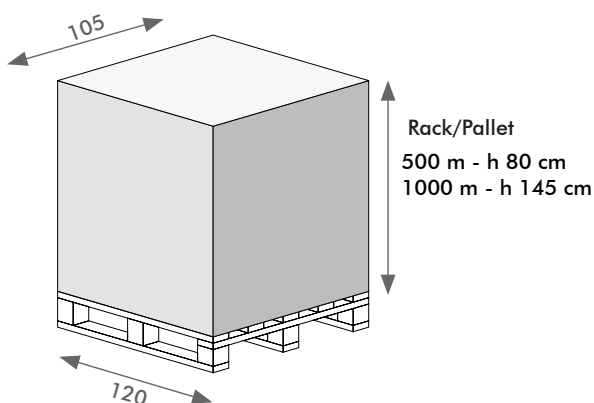

ACRN4

B Width:	20 mm
A Part height:	28 mm
Total height:	60 mm
Length:	1.000 mm
Weight:	850 g
Range:	400 Kg
Number of fit:	4

Steel core



Dovetail alignment system



ACRV33

THREE PIECES OF GRAY M4X333 MM RACK

(not packaged) for gates with a maximum capacity of 300 Kg.

AVAILABLE ACCESSORIES

- SAC012
- ACRFF

PALLET SIZE AND BULK

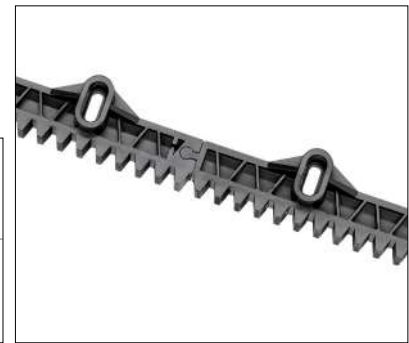
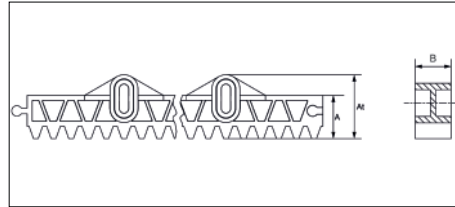
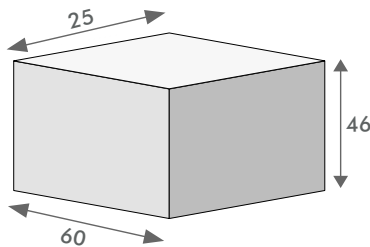

42 meter in the box

ACRV33	
B Width:	20 mm
A Part height:	30 mm
Total height:	45 mm
Length:	999mm
Weight:	446=(148,6X3) g
Range:	300 Kg
Number of fit:	6

ACFCR333VP

M4X333 MM RACK

GREY COLOR (in packs of 2 meters with self-drilling screws) for gates with a maximum capacity of 300 Kg.

AVAILABLE ACCESSORIES

- SAC012
- ACRFF

PALLET SIZE AND BULK

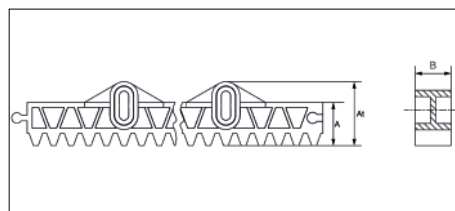
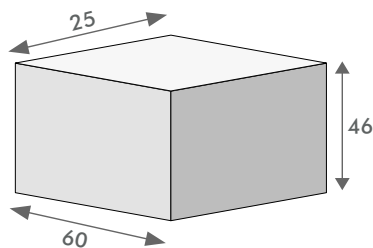

20 total pieces in the box

ACFCR333VP	
B Width:	20 mm
A Part height:	30 mm
Total height:	45 mm
Length:	1.998mm
Weight:	892=(148,6x6)g
Range:	300 Kg
Number of fit:	6



ACRV20BL

M4X3000 MM RACK WITH PRE-DRILLED ALUMINUM PROFILE with six buttonholes (15x8 mm) for gates with a maximum capacity of 300 Kg.

AVAILABLE ACCESSORIES

- SAC012
- ACRFF

PALLET SIZE AND BULK

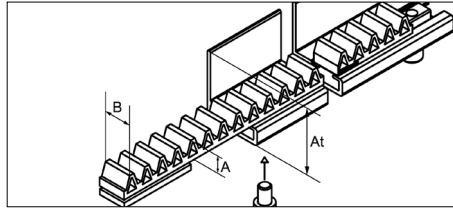
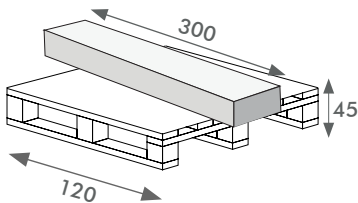

ACRV20BL

B Width:	20 mm
A Part height:	15 mm
Total height:	48 mm
Length:	3.000 mm
Weight:	3.335 g
Range:	300 Kg
Number of fit:	7

AKTCSSP1

Two pieces, glass fiber reinforced nylon **M4X1000 MM** rack, for aluminum profiles. for gates with a maximum capacity of 300 Kg.

AVAILABLE ACCESSORIES

- ACRFF

PALLET SIZE AND BULK

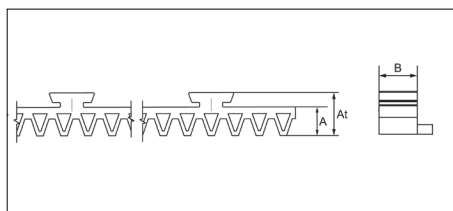
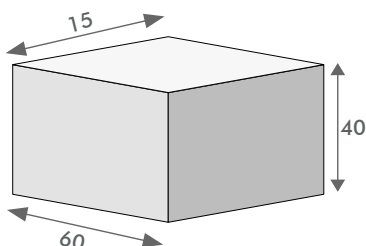

AKTCSSP1

B Width:	20 mm
A Part height:	15 mm
Total height:	21 mm
Length:	978=(489X2)mm
Weight:	280=(140x2)g
Range:	300 Kg
Number of fit:	0

2 pieces x 500mm
Total 60 meter in the box

AKTCSSP1-01

Two pieces, glass fiber reinforced nylon **M4X1000 MM** rack, for aluminum profiles. for gates with a maximum capacity of 300 Kg.

AVAILABLE ACCESSORIES

- ACRFF

PALLET SIZE AND BULK

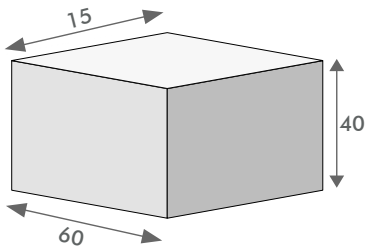
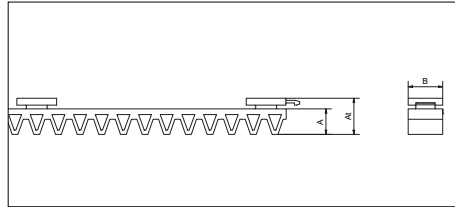

2 pieces x 500mm
Total 60 meter in the box

AKTCSSP1-01

B Width:	20 mm
A Part height:	15 mm
Total height:	21 mm
Length:	978=(489X2)mm
Weight:	280=(140x2)g
Range:	300 Kg
Number of fit:	0

ACRS20Z

M4X1000 RACK AND GALVANIZED STEEL PROFILE with upper attachment, for gates with a maximum capacity of 300 Kg.

AVAILABLE ACCESSORIES

- ACRFF
- ACRSCUN

PALLET SIZE AND BULK

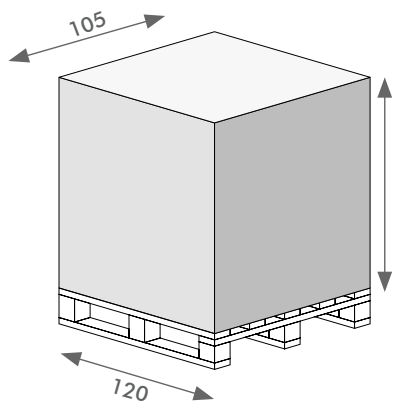
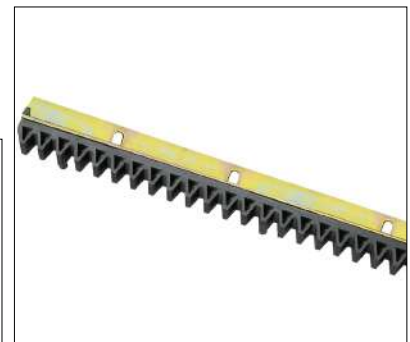
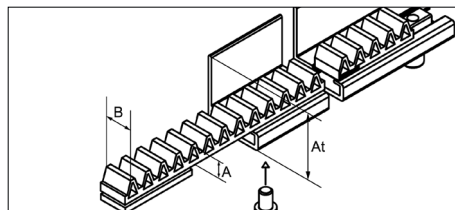

50 total pieces
500 m - h 80 cm

ACRS20Z

B Width:	20 mm
A Part height:	15 mm
Total height:	48 mm
Length:	1.000 mm
Weight:	3.335 g
Range:	300 Kg
Number of fit:	0

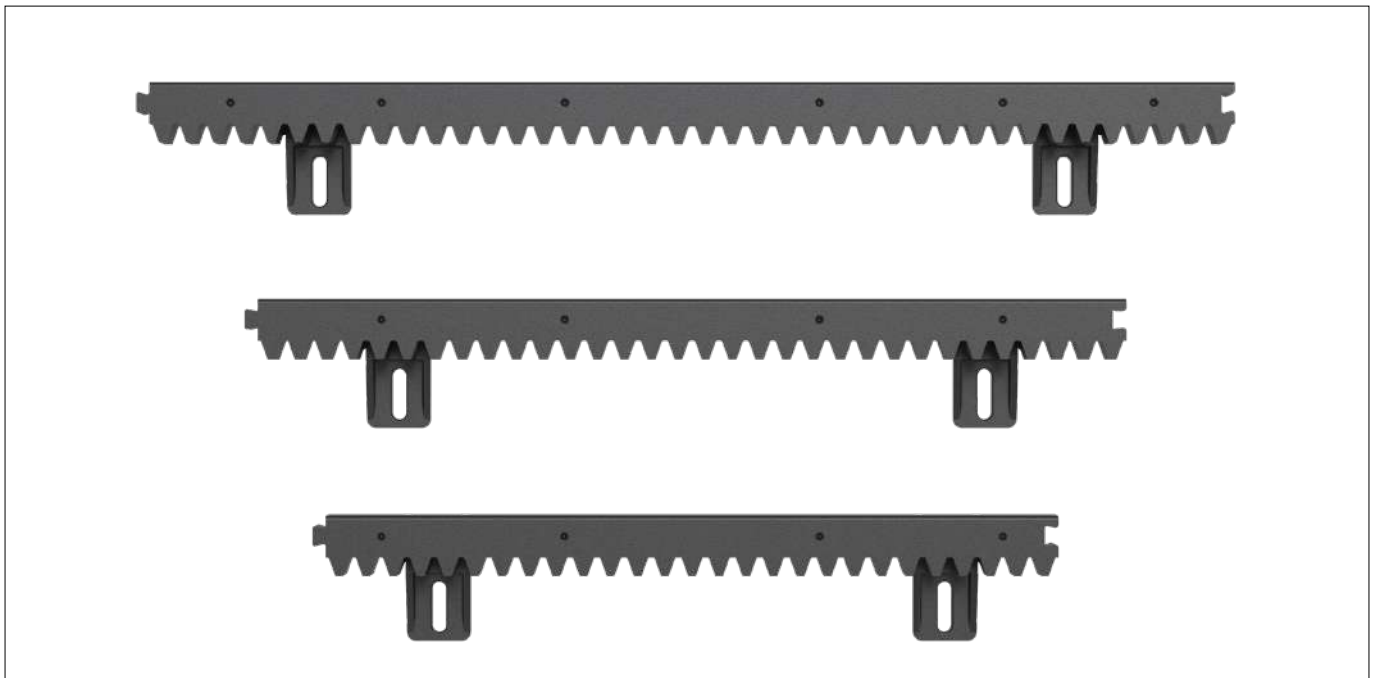

N233 - N240 - N250

Stagnoli presents its new line of modular gate racks. Specifically, these are nylon racks, with steel core, module 4, compatible with all automations, available in different lengths. Suitable for automation kits, ideal for shipping, for storage and for GDO or DIY markets.

N233K



N240K



N250K

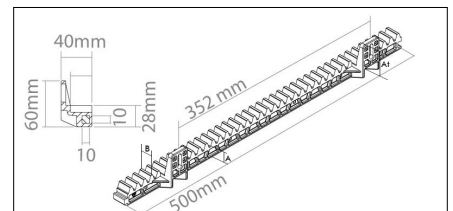
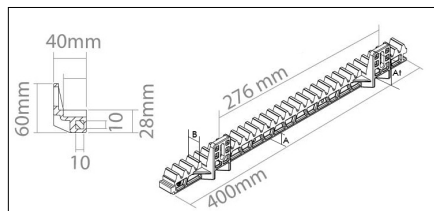
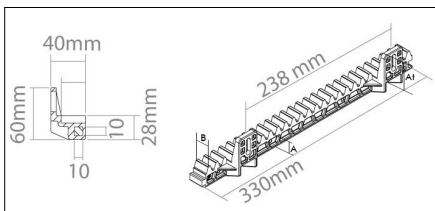

Overtail alignment system



Steel core

AVAILABLE ACCESSORIES

- SAC012
- ACRFF

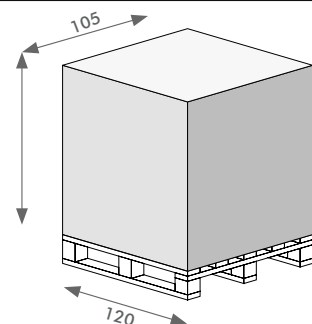

Rack/Pallet

- 500 m - h 80 cm
- 700 m - h 105 cm
- 1000 m - h 145 cm

	B WIDTH	PART. HEIGHT A	HEIGHT TOTAL	LENGTH	WEIGHT	RANGE	NUMBER OF FIT
N233K	19mm	19mm	59mm	330mm	380g	700kg	2
N240K	19mm	19mm	59mm	400mm	450g	700kg	2
N250K	19mm	19mm	59mm	500mm	550g	700kg	2

Rack accessories

	<p>SACN5 ACRN5 Rack fixing kit. 30 screws (5 screws per meter of rack)</p>	 <p>X 6 X 18</p>	<p>SAC014 Rack fixing kit, 6 connections. 18 screws (ACRVA) + 6 washers (ACRR)</p>
	<p>SAC012 Rack fixing kit, 6 connections. 10 sets of 6 screws (ACRVA) + 6 washers (ACRR)</p>		<p>SAC013 Rack fixing kit, 4 connections. 10 sets of 4 screws (ACRVA) + 4 washers (ACRR)</p>
	<p>ACRFF Pair of steel end- of-stroke cams</p>		<p>ACRSCUN Pair of nylon end- of-stroke cams (compatible with ACRS20Z rack)</p>
	<p>AKTBLO Terminal block for aluminum sheet - 2pcs.(compatible with the ACRV20BL rack)</p>		



CODE	CAPACITY	NUMBER OF FIT (m)	STEEL CORE	WEIGHT	LENGHT
S6-1200	1.200 KG	6	✓	1.336 g	1.000 mm
V6-1200	1.200 KG	6	✓	1.336 g	1.000 mm
ACRV6	800 KG	6	✓	1.328 g	1.000 mm
ACRV6B	800 KG	6	✓	1.328 g	1.000 mm
ACRS6	800 KG	6	✓	1.318 g	1.000 mm
ACRS6N	800 KG	6	✓	1.318 g	1.000 mm
ACRN6	700 KG	6	✓	1.328 g	1.000 mm
N6C	700 KG	6	✓	1.328 g	1.000 mm
N6CH	700 KG	6	✓	1.328 g	1.000 mm
N250K	700 KG	4	✓	550 g	1.000 mm
N240K	700 KG	4	✓	450 g	1.000 mm
N233K	700 KG	4	✓	380 g	1.000 mm
ACRN5	500 KG	5	✗	360 g	1.000 mm
ACRV4	500 KG	4	✓	1.318 g	1.000 mm
ACRN4	400 KG	4	✓	850 g	1.000 mm
ACRV33	300 KG	6	✗	446 g	999 mm
ACFCR333VP	300 KG	6	✗	892 g	1.998 mm
AKTCSSP1	300 KG	✗	✗	280 g	978 mm
AKTCSSP1-01	300 KG	✗	✗	280 g	978 mm

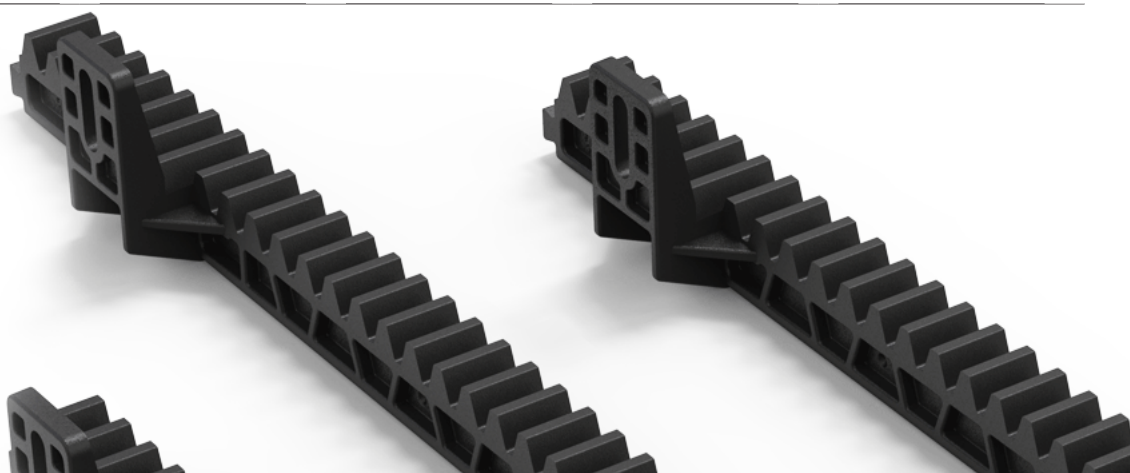

ACRM2

M4 30X8X1000mm RACK
 in galvanized steel, complete with accessories, for gates with a maximum capacity of 1200 Kg.
 With screws included (3pcs x m)

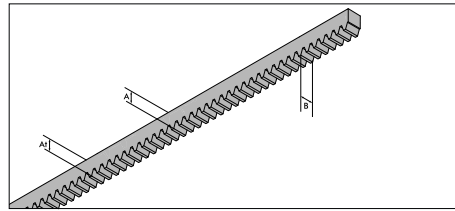

PALLET SIZE AND BULK

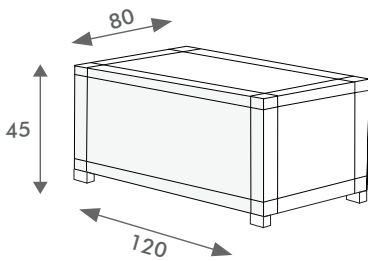

500 total pieces

ACRM2	
B Width:	8 mm
A Part height:	30 mm
Total height:	30 mm
Length:	1.000 mm
Weight:	1.700 g
Range:	1.200 Kg
Number of fit:	3

ACRM3

M4 30X12X1000mm RACK
 in galvanized steel, complete with accessories, for gates with a maximum capacity of 2200 Kg. 4 meter pack.
 With screws included (3pcs x m)

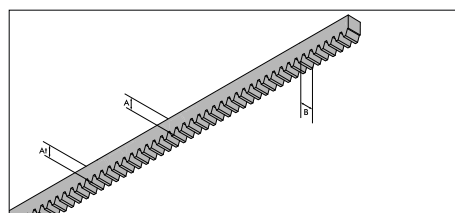

PALLET SIZE AND BULK

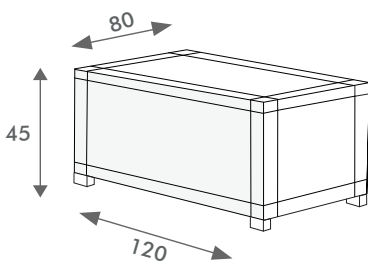

500 total pieces

ACRM3	
B Width:	12 mm
A Part height:	30 mm
Total height:	30 mm
Length:	1.000 mm
Weight:	2.530 g
Range:	2.200 Kg
Number of fit:	3



ACRM3-2000

M4 30X12X2000mm RACK

in galvanized steel, complete with accessories, for gates with a maximum capacity of 2200 Kg. 4 meter pack. With screws included (3pcs x m)

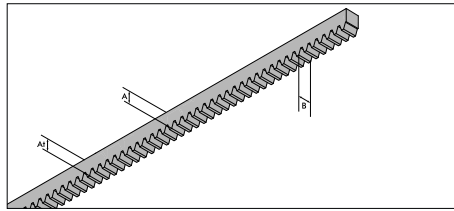

PALLET SIZE AND BULK

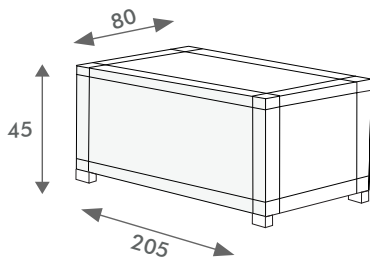

250 total pieces

ACRM3-2000	
B Width:	12 mm
A Part height:	30 mm
Total height:	30 mm
Length:	2.000 mm
Weight:	4.778 g
Range:	2.200 Kg
Number of fit:	4

ACRM1

M4 22X22X1000mm RACK

in galvanized steel, complete with accessories, for gates with a maximum capacity of 4000 Kg. Product to be welded. (3pcs.x m)

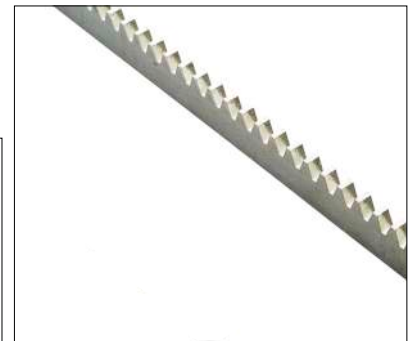
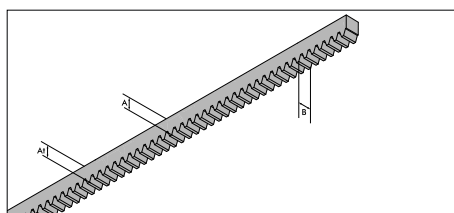

PALLET SIZE AND BULK

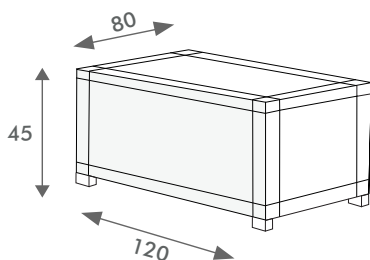

500 total pieces

ACRM1	
B Width:	22 mm
A Part height:	22 mm
Total height:	22 mm
Length:	1.000 mm
Weight:	2.400 g
Range:	4.000 Kg
Number of fit:	0

ACRM1-2000

M4 22X22X2000mm RACK

in galvanized steel, complete with accessories, for gates with a maximum capacity of 4000 Kg. Product to be welded. (3pcs.x m)

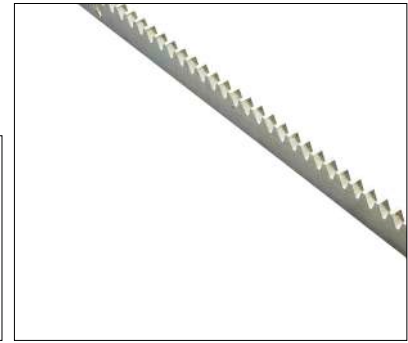
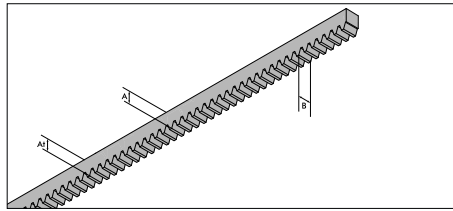

PALLET SIZE AND BULK

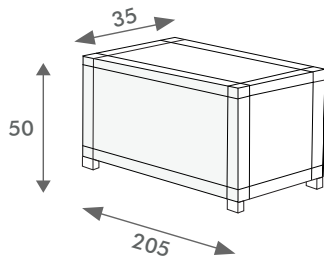

250 total pieces

ACRM1-2000

B Width:	22 mm
A Part height:	22 mm
Total height:	22 mm
Length:	2.000 mm
Weight:	6.000 g
Range:	4.000 Kg
Number of fit:	4

ACRM6

M6 30X30X1000mm RACK

in galvanized steel, complete with accessories, for gates with a maximum capacity of 4000 Kg. Product to be welded. (3pcs.x m)

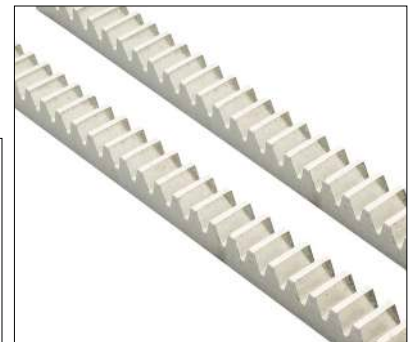
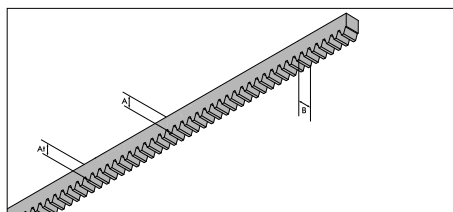

PALLET SIZE AND BULK

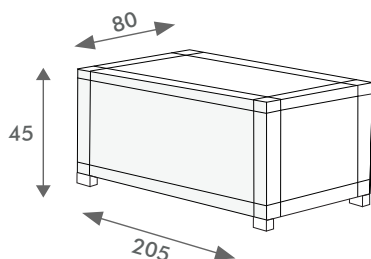

250 total pieces

ACRM6

B Width:	30 mm
A Part height:	30 mm
Total height:	30 mm
Length:	1.000 mm
Weight:	5.980 g
Range:	4.000 Kg
Number of fit:	0



ACRM6-2000

M6 30X30X2000mm RACK

in galvanized steel, complete with accessories,
for gates with a maximum capacity of 4000 Kg.
Product to be welded. (3pcs.x m)

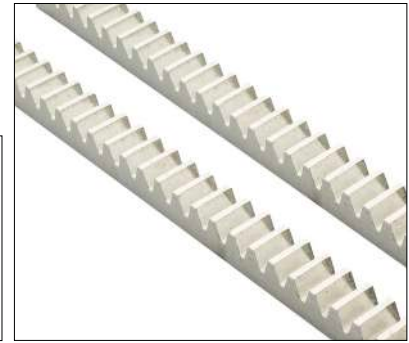
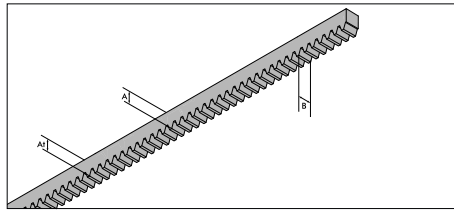

PALLET SIZE AND BULK

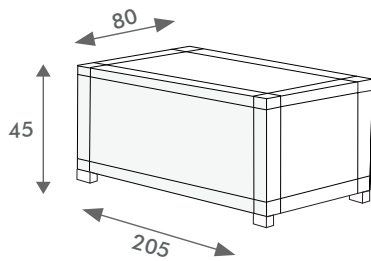

250 total pieces

ACRM6 - 2000	
B Width:	30 mm
A Part height:	30 mm
Total height:	30 mm
Length:	2.000 mm
Weight:	11.120 g
Range:	4.000 Kg
Number of fit:	0



WALL KEY SELECTOR



Code	Assembly	Material	Type of key	Number of contact points	IP	Weight	Size
ASM1S	Wall	Aluminum	EU cylinder	1	65	390 g	70 x 70 x 75 mm
ASM2		Aluminum	EU cylinder	2		406 g	
ASM2P		Aluminum	EU cylinder	2		406 g	
ASM2PC		Aluminum	EU cylinder	2		410 g	
ASM2P11		Aluminum	EU cylinder	2		420 g	

RECESSED KEY SELECTOR

Code	Assembly	Material	Type of key	Number of contact points	IP	Weight	Size
ASIP2	Wall recessed	Aluminum / Nylon	EU cylinder	2	65	386 g	70x70x75mm
ASIP2P		Aluminum / Nylon	EU cylinder	2		386 g	
ASIP2PC		Aluminum / Nylon	EU cylinder	2		390 g	
ASIP2P11		Aluminum / Nylon	EU cylinder	2		400 g	



**AFEPN**

PAIR OF WALL PHOTOCELLS WITH FIXED OPTICS



Code	Power supply	Adjustability	IR Range	Level of protection	Working time
	V ac/dc	-	m	IP	C°
AFEPN	12-24	NO	15	65	-30 +55

PAIR OF WALL PHOTOCELLS WITH ADJUSTABLE OPTICS

AFAP20

Code	Power supply	Adjustability	IR Range	Level of protection	Working time
	V ac/dc	-	m	IP	C°
AFAP20	12-24	$\updownarrow \pm 10^\circ, \neq 180^\circ$	20	65	-30 +55



Accessories
COD: AFAPC
 Cover
 vandal-proof
 in aluminum
 satin.

DA021

SINGLE CHANNEL METAL MASS DETECTOR



Code	Power supply	Power	Load	Level of protection	Working time
	V ac/dc	W		IP	C°
DA021	12-24	1.5	Max 24Vac/dc 250mA	40	-20 +70

TWO-CHANNEL METAL MASS DETECTOR
WITH DIN RAIL FIXING**DA035**

Code	Power supply	Power	Load	Level of protection	Working time
	V ac/dc	W		IP	C°
DA035	24	1.5	Max 24Vac/dc 250mA	40	-20 +70

**COMPAPR2000**

ACTIVE SENSITIVE EDGE

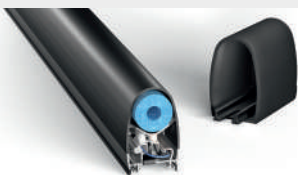

Code	Load	Sensitive area	Level of protection	Working time	Output
		m	IP	C°	-
COMPAPR2000	Max 24Vac/dc 250mA	2	55	-10 +60	N.C.

DOPPLER EFFECT MOTION DETECTOR
IN BOTH DIRECTIONS**PRAP**

Code	Power supply	Power	Load	Sensitive area	Height	Level of protection	Working time
	V ac/dc	W		m	m	IP	C°
PRAP	12-24	2	Max 42V 60W	4x7	3.5-7	65	-30 +55



General Sale Conditions

The Parties mutually acknowledge the fact that all sales of products (hereinafter, collectively, "Products") made by Stagnoli TG Srl, based in Lonato del Garda (hereinafter, "Stagnoli") to its customers (hereinafter, the "Customer") are governed by these General Conditions, which form an integral part of the existing contract between the Parties and replace, by canceling it, any different clause contained in previous agreements, in the order (hereinafter, "The Order") or in another document from the Customer.

1 Order and Order Confirmation

This is without prejudice to Stagnoli's right to accept, reject or modify, in whole or in part, the Customer's Order, taking into account availability of stock and production capacity of the moment, in compliance with these General Conditions.

Should Stagnoli modify the Order placed by the Customer, the Order thus modified will have the value of a new offer and must be accepted again by the Customer in writing, also by fax, under penalty of forfeiture of the Order.

It is understood that, in any case, the failure to provide explicit confirmation of the Order by Stagnoli (hereinafter, the "Order Confirmation") will not be valid as tacit acceptance of the Order itself.

Pursuant to these General Conditions, the Order cannot be, in any case and in no way, canceled or modified, in whole or in part, by the Customer once Stagnoli has sent the Order Confirmation, unless otherwise agreed by the Set off.

In the event of total or partial cancellation of the Order after the Order Confirmation has been sent by Stagnoli, as well as in the event of the Customer's refusal to collect the ordered goods, Stagnoli will be entitled to obtain payment from the Customer. of the full price of the Products ordered, without prejudice to the right to greater damage.

2 Prices

Stagnoli sells and the Customer purchases the Products at the prices indicated in the Stagnoli price list (hereinafter, the "Price List"), to be understood always ex works and VAT excluded (hereinafter, the "Price" or "Prices"). The Customer will pay the Listing Prices in effect on the date of each delivery of Products to the Customer. Each new Stagnoli Price List cancels and replaces the previous ones, starting from the date of its entry into force. The Customer undertakes to accept, unconditionally, any variation of the Price List that occurs between the date of each Order and that of its delivery.

3 Terms of payment

The payment of the Price must be made according to the terms and conditions indicated in the Stagnoli invoice. In the absence of such indications on the invoice or of different written agreements between the Parties, payments must be made within 30 (thirty) days from the end of the month of issue of the invoice relating to the Products sold. Payments must be made by bank transfer or bank remittance.

Failure to pay the Price by the deadline of the single invoice will automatically generate default interest pursuant to the provisions of Legislative Decree 231/2002, without the need for any communication or formal notice from Stagnoli to the Customer. Said interest will start from the day following the expiry date of the single invoice and until the date of the actual payment. In addition to interest, Stagnoli will also be entitled to full compensation for costs incurred for the recovery of sums not promptly received, without prejudice, in any case, to compensation for greater damage.

Without prejudice to the foregoing, in the case of an Order with split deliveries, if the Customer is late in paying, even for a single delivery or part of it, with respect to the expected deadline, Stagnoli will have the right to suspend subsequent deliveries until full payment of the accrued sums, without prejudice to the right to obtain the termination of the contract pursuant to art. 12 below.

4 Terms of delivery

The delivery terms of the Products are those indicated in the Stagnoli Order Confirmation. The Products are sold ex factory, by the Stagnoli TG Srl plant or by another secondary office which will be indicated to the Customer from time to time.

The obligation to deliver the Products is fulfilled by Stagnoli with the delivery of the same to the carrier. Stagnoli must be considered released from this obligation in all cases in which delivery to the carrier has become impossible or excessively burdensome, due to force majeure or unforeseeable circumstances, such as, merely by way of example, strikes, impossibility of supplying raw materials, events war or terrorist, massacres, meteorological events and any other event not attributable to Stagnoli.

The Parties expressly agree that the mere delay in the delivery of the Products does not give the Customer any right to request the termination of the contract or to refuse the collection of the Products, or not to pay the relative Price.

The Customer, for his part, undertakes to do everything necessary to collect the goods once they are made available to him. For any delays by the Customer in collecting the goods, Stagnoli will be entitled, in addition to the payment of the price, to the payment of the costs associated with the storage of the goods at its warehouses, at third-party warehouses or at the carrier, without prejudice, in any case, to the right to compensation for any damage.

Furthermore, in cases of delay in the collection of the Products, the Customer assumes on himself all the risks for any damage that may derive from the storage of the goods, both at the warehouses of Stagnoli, that of third parties, as well as at the carrier.

5 Shipping

Unless otherwise agreed in writing, Stagnoli, in the name and on behalf of the Customer, will appoint a trusted courier or a courier indicated by the Customer for the deliveries of the Products, the cost of which will be charged to the Customer from time to time in the invoice. In all cases in which thefts, losses, losses and/or failures, even if only partial, of the Products were to occur during transport for any cause not directly attributable to Stagnoli, the Customer will be required to pay the full Price towards di Stagnoli, without prejudice to the right to retaliate against the carrier and/or the third party who is found to be responsible.

Without prejudice to the responsibilities of the carrier in charge, all risks related to the transport of the Products from the Stagnoli headquarters to the Customer's home or to the place he will indicate for delivery will remain the sole responsibility of the Customer.

Unless otherwise agreed between the Customer and Stagnoli, shipments are not covered by any insurance policy other than those that the carrier may have stipulated.

6 Guarantees

6.1 Stagnoli guarantees that the Listed Products have been carefully manufactured, tested and checked. Stagnoli also provides a guarantee on the Products against construction defects for a period of 24 (twenty-four) months from the date of delivery of the same.

Warranty is assured to the final consumer and will be managed exclusively by the seller of the Product, in accordance with the provisions of the Consumer Code and Articles. 1490 and following of the Italian Civ. Code. The warranty intervention will be carried out upon presentation of a fiscally valid document (invoice) relating to the purchase of the Products. Any faults and/or defects must be reported by the consumer to the Customer within a maximum period of 60 (sixty) days from the date of their discovery, under penalty of forfeiture of the guarantee. Apparent defects, on the other hand, must be reported immediately upon delivery under penalty of forfeiture.

6.2 As a result of this guarantee, the Customer must identify the defect and, if the conditions are met, proceed with the repair or replacement of the Products or non-compliant components and the recognition of the costs related to the replacement (transport, interventions).

6.3 When the non-conformity detected will be attributable to the production process carried out by Stagnoli, the Customer will have the right to recourse against Stagnoli.

However, Stagnoli's warranty will be excluded in cases of damage, faults or defects deriving from incorrect installation of the Products, non-compliance with the installation instructions supplied with the Products, as well as non-compliance with the sector regulations in force at the time of the installation itself and with the general safety rules for the sector.

Stagnoli also declines any responsibility for the non-observance, by the Customer or other user of the Products, of the safety rules and the rules of good practice in the use and maintenance of the Products themselves.

Stagnoli's warranty will also be excluded in all cases in which the Product has not been installed by qualified personnel (issuing a suitable certificate) and in cases in which the Products have been installed and/or used with accessories, complementary items of the automation, non-original mechanical or electronic parts, from manufacturers other than Stagnoli.

Finally, it is expressly agreed that Stagnoli will not be liable to the customer or third parties for any indirect, incidental or consequential damage suffered by the latter, including, by way of example only, loss of productivity, reduction of profits, failure to conclude contracts, renunciation of commercial opportunities.

7 Sale with split deliveries

In the case of split deliveries of the Products sold, as well as in the case of payment in installments of the Price, the transfer of ownership of the goods to the customer takes place only at the time of payment of the part of the Price relating to the Products delivered. It is understood that, however, the customer will assume all risks relating to the Products from the moment of delivery, even if it has already taken place, pursuant to the provisions of point 4 above.

Trademarks and industrial property Stagnoli guarantees to be the owner or in any case to have the full and free enjoyment of the registered trademarks that distinguish the Products. Therefore, it is expressly forbidden for anyone to remove, delete, integrate, alter in any way or replace with others the trademarks, initials and other distinctive signs affixed to the Products, their components or their packaging.

Unless authorized in writing by Stagnoli, it is expressly forbidden for anyone to reproduce (totally or partially) the trademarks and other distinctive signs owned by Stagnoli, as well as to use them in any other way for their own purposes or those of third parties.

It is also forbidden for the Customer and third parties to reproduce, copy or otherwise imitate the Products patented by or on behalf of Stagnoli or protected by other industrial or intellectual property rights in favor of Stagnoli.

8 Trademarks and industrial property

Stagnoli guarantees full ownership and full and free entitlement to the registered trademarks peculiar of the Products. Therefore, it is expressly forbidden for anyone to remove, alter, delete, integrate in any way or replace the trademarks, initials and other distinctive signs affixed to the Products, their components or their packaging. Unless expressly authorized, it is forbidden for anyone to reproduce (totally or partially) the trademarks and other distinctive signs owned by Stagnoli, as well as to use them in any other way for their own purposes or those of third parties. It is also forbidden for the Customer and third parties to reproduce, copy or otherwise imitate the Products patented or protected by other industrial property rights belonging to Stagnoli.

9 Confidentiality

Each of the Parties undertakes to put in place all the necessary measures in order to ensure adequate protection of the confidentiality of the information received on the occasion or due to the supply of Products.

10 Applicable law and competent court

These General Conditions and the contractual relations for the purchase and sale of the Products regulated by them are governed by Italian law.

Any dispute that may arise with reference to the interpretation and application of the General Conditions, as well as the execution of the supply relationship governed by them, will be referred to the competent judge of the Court of Brescia.

11 Previous agreements and amendments to the General Conditions

Any changes that the Parties wish to make to these General Conditions can only be made by means of a written and signed agreement of the Parties.

12 Resolution clause

In the event of non-fulfillment of the obligation to pay the Price referred to in points 2 and 3 above, or failure to collect the Products by the Customer, Stagnoli may send the defaulting Party, by registered letter or fax, a diffi from to fulfillment.

If the period of 15 (fifteen) days from the date of the delay has elapsed without any effect, Stagnoli will terminate the contract governed by the General Conditions.

Pursuant to the law, Stagnoli will also have the right to request the termination of the contractual relationship in the event that the Customer is declared bankrupt or subjected to other insolvency and / or liquidation procedures.

13 Final clauses

The invalidity and / or ineffectiveness of one or part of the clauses of these General Conditions does not imply the invalidity and / or ineffectiveness of all the others.

Any failed, partial or delayed exercise of any right, power or faculty provided for by these General Conditions does not in any way constitute a waiver of the same for the Parties. The Customer has read and expressly accepted the clauses contained in articles 3) Payment conditions; 4) Terms of delivery; 6) Guarantees; 7) Sale with retention of title; 10) Applicable law and competent court; 12) Termination clause; of those present General Conditions of Sale, pursuant to articles 1341 and 1342 of the Civil Code.



NOTES:

A series of horizontal dotted lines for writing notes, starting below the 'NOTES:' header and extending to the bottom of the page.

WWW.STAGNOLI.COM
Stagnoli T.G. S.r.l.
Via Mantova Traversa 1, 105 a/b
25017 Lonato del Garda - Brescia - Italia
e-mail: info@stagnoli.com

