

APOLO PLAST



— MADE IN ITALY —



EXTERNAL USE







ROTATABLE AT 130°



EASY TO INSTALL



ANTI-VANDALIC

Product	Code	Power supply (V)	Power (W)	Color	Number of lights	Brightness (lx)	Working Temperature (C°)	Number of LED's by color	Ø Lens mm	Protection (IP)	Weight (kg)	Pallet pcs.
	ASFR	24V ac/dc	1,5	●	1	35 (±5)	-20/+55°	18	120	65	0.60	144
	ASFG			●								
	ASFV			●								
	ASFR230	230V ac	3	●	1	35 (±5)	-20/+55°	18	120	65	0.98	144
	ASFG230			●								
	ASFV230			●								
	ASF36L1RV	24V ac/dc	1,5	● ●	1	35 (±5)	-20/+55°	18	120	65	0.60	144
	ASF36L1RV230	230V ac	3	● ●								
	ASFRV	24V ac/dc	1,5	● ●	2	35 (±5)	-20/+55°	18	120	65	0.60	48
	ASFRV230	230V ac	3	● ●								

**BULK SIZE
AND
PALLET**

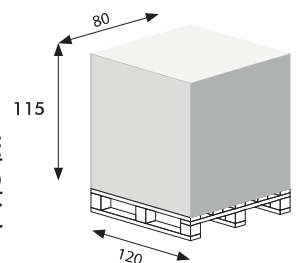

SIZE AND BULK
1- LAMPS TRAFFIC LIGHT

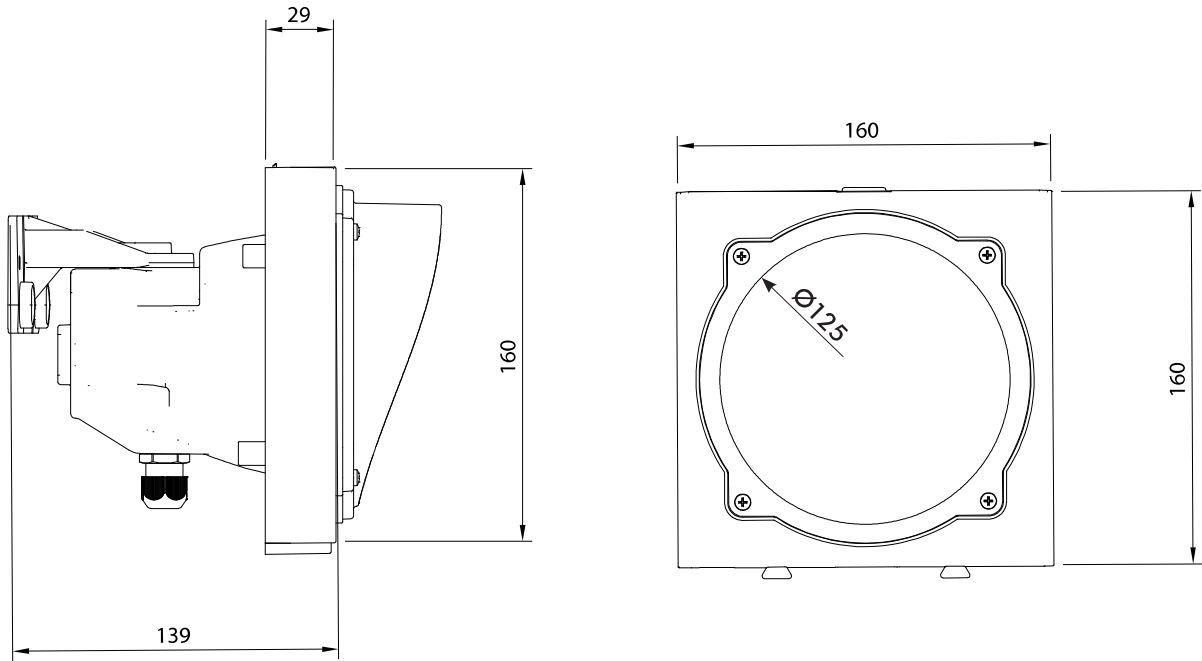

FIELDS OF APPLICATION



AIRPORT



LOGISTICS



CONSTRUCTION SITES



**TWIN COLOR
TRAFFIC LIGHT**
CODE: ASF36L1RV
ASF36L1RV230

Double coloring
(red-green) in one body with
36 LEDs (18+18) integrated.



MODULARITY OF BODIES
The clips placed
below the traffic light allow
for easy modulation of the
traffic light, from 2 to 3
bodies.

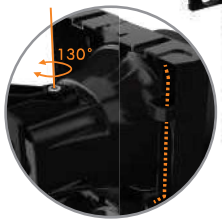

CHANNEL CLIP
for hiding the cable and prevent its
visibility.



ACCESSORIES

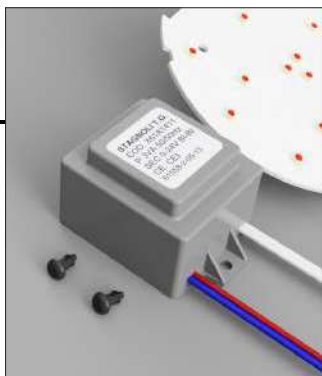

ASFK230

Conversion kit for
allowing use of Apollo
traffic lights from 24V
to 230V.



AMPS

Pair of brackets for
hooking the traffic light
onto the pole.



APS

Galvanized pole
(Ø60mm) for traffic
light support,
length 3m.



ARSFPOF-10
ARSFPOX-10

Directional lenses
kit 10 pcs. Apollo.