

abax2

Bidirectional keyfob

APT-210

Firmware version 1.02

EN

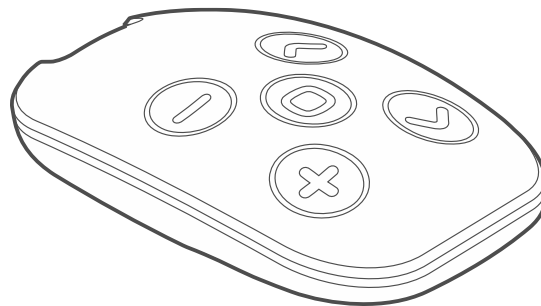

CE

apt-210_en 05/24

Satel®

SATEL sp. z o.o. • ul. Budowlanych 66 • 80-298 Gdańsk • POLAND
tel. +48 58 320 94 00
www.satel.pl

IMPORTANT

Changes, modifications or repairs not authorized by the manufacturer shall void your rights under the warranty.

Description of symbols on the device:



The device meets the requirements of the applicable EU directives.

The device must not be disposed of with other municipal waste. It should be disposed of in accordance with the existing rules for environment protection (the device was placed on the market after 13 August 2005).

SATEL aims to continually improve the quality of its products, which may result in changes in their technical specifications and software. Current information about the changes being introduced is available on our website.

Please visit us at:
<https://support.satel.pl>

Hereby, SATEL sp. z o.o. declares that the radio equipment type APT-210 is in compliance with Directive 2014/53/EU. The full text of the EU declaration of conformity is available at the following internet address: www.satel.pl/ce

In the EU, this radio equipment is only permitted to operate in the 868 MHz frequency band.

The following symbols may be used in this manual:



- note,



- caution.

CONTENTS

1	Features	2
2	Description.....	2
2.1	Control	2
	ACU-220 controller	2
	ABAX 2 / ABAX controller connected to INTEGRA / INTEGRA Plus control panel	3
	INTEGRA 128-WRL control panel.....	3
	ABAX 2 / ABAX controller connected to VERSA / VERSA Plus / VERSA IP control panel ...	3
	ABAX 2 controller connected to PERFECTA 64 M control panel	3
2.2	System state information	4
	ACU-220 controller	4
	ABAX 2 / ABAX controller connected to INTEGRA / INTEGRA Plus control panel	4
	INTEGRA 128-WRL control panel.....	4
	ABAX 2 / ABAX controller connected to VERSA / VERSA Plus / VERSA IP control panel ...	4
	ABAX 2 controller connected to PERFECTA 64 M control panel	4
3	Battery replacement.....	4
4	Specifications	6

The APT-210 keyfob allows you to remotely control the alarm system or automation devices. It is designed for operation within the ABAX 2 / ABAX two-way wireless system. The keyfob is supported by:

- ABAX 2:
 - ACU-220 / ACU-280 controller (firmware version 6.08 or newer),
- ABAX:
 - ACU-120 / ACU-270 controller (firmware version 5.04 or newer),
 - INTEGRA 128-WRL control panel (firmware version 1.19 or newer and firmware version of processor used to operate ABAX system 3.10 or newer).

1 Features

- Encrypted two-way radio communication in the 866 MHz / 868 MHz / 915 MHz frequency band (AES standard for the ABAX 2 system).
- Transmission channel diversity – 4 channels for automatic selection of the one that will enable transmission without interference with other signals in the 866 MHz / 868 MHz / 915 MHz frequency band (ABAX 2 system only).
- 5 buttons to start up to 6 functions.
- 3 LEDs indicating the alarm system status.
- Built-in sounder.
- Battery status control.

2 Description

For description of adding and configuring the keyfobs, refer to the ABAX 2 / ABAX system controller manual / INTEGRA 128-WRL control panel user manual.



In the ABAX 2 / ABAX system, the pilot is identified as APT-200.

Pressing the keyfob button will:

- generate a beep,
- make the LEDs blink three times,
- send a radio transmission to the controller / alarm control panel.

As long as the button is pressed, the keyfob will keep sending information about this fact to the controller / alarm control panel. If the button will be pressed for 20 seconds, the keyfob will turn off to save battery power.

After the transmission is sent, the keyfob is waiting for an answer from the controller / control panel. The keyfob will signal with a sound whether it has received transmission acknowledgement or not. Having received the system state information, the keyfob will present it by means of LEDs.



Fig. 1 shows numeration of the keyfob LEDs (1-A) and buttons (1-B). The LEDs are visible only when they are ON.

2.1 Control

ACU-220 controller



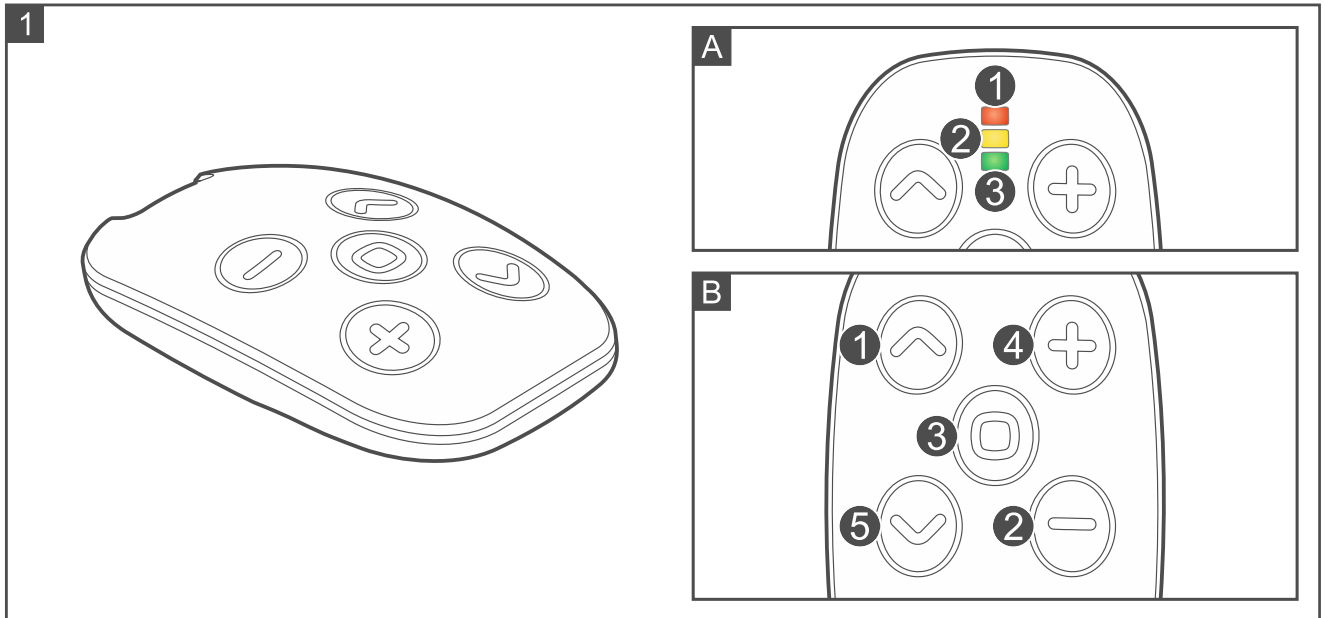

The description below does not apply to the ACU-220 controller connected to the INTEGRA / INTEGRA Plus / VERSA / VERSA Plus / VERSA IP / PERFECTA 64 M control panel.

The keyfob user can control the ACU-220 controller outputs. The five buttons make it possible to control six outputs (to control the sixth output, press the  and  [1 and 5] buttons simultaneously). Pressing the keyfob button(s) will turn on the output for a preset time or toggle the output to its opposite state. You must define the output operating mode when configuring the controller settings. For more information, refer to the ACU-220 controller manual.





ABAX 2 / ABAX controller connected to INTEGRA / INTEGRA Plus control panel

The keyfob user can control the alarm system zones. The five buttons make it possible to control six zones (to control the sixth zone, press the  and  [1 and 5] buttons simultaneously). The zones must not exist physically and their preprogrammed wiring type must be different from “Not used” or “Follow output”. You can program any zone type for them. Pressing the keyfob button(s) will violate the zone. For more information, refer to the ABAX 2 / ABAX controller manual and the INTEGRA / INTEGRA Plus control panel manuals.



INTEGRA 128-WRL control panel

The keyfob user can control the alarm system zones in the same way as in the case of ABAX 2 / ABAX controller connected to the INTEGRA / INTEGRA Plus control panel. For more information, refer to the INTEGRA 128-WRL control panel manuals.

ABAX 2 / ABAX controller connected to VERSA / VERSA Plus / VERSA IP control panel

The keyfob user can run functions available in the control panel. The five buttons make it possible to run six functions (to run the sixth function, press the  and  [1 and 5] buttons simultaneously). If the function allows for zone violation, the zone must not exist physically and its preset wiring type must be different from “Not used”. You can program any zone type for the zone. For more information, refer to the ABAX 2 / ABAX controller manual and the VERSA / VERSA Plus / VERSA IP control panel manuals.

ABAX 2 controller connected to PERFECTA 64 M control panel

The keyfob user can run functions available in the control panel. The five buttons make it possible to run six functions (to run the sixth function, press the  and  [1 and 5] buttons simultaneously). If the function allows for zone violation, the zone must not exist physically and its preset wiring type must be different from “No detector”. You can program any zone

type for the zone. For more information, refer to the ABAX 2 controller manual and the PERFECTA 64 M control panel manuals.

2.2 System state information

To get the system state information, press any button (it needn't start any function). The information will be presented by the keyfob LEDs for a few seconds.

ACU-220 controller



The description below does not apply to the ACU-220 controller connected to the INTEGRA / INTEGRA Plus / VERSA / VERSA Plus / VERSA IP / PERFECTA 64 M control panel.

Each LED can indicate the state of one zone of the ACU-220 controller. The LED is ON when:

- the NO type input is shorted,
- the NC type input is open.

For more information, refer to the ACU-220 controller manual.

ABAX 2 / ABAX controller connected to INTEGRA / INTEGRA Plus control panel

Each LED can indicate the state of one output of the alarm system. The LED is ON when:

- output with normal polarity is active,
- output with reversed polarity is inactive.

For more information, refer to the ABAX 2 / ABAX controller manual and the INTEGRA / INTEGRA Plus control panel manuals.

INTEGRA 128-WRL control panel

Each LED can indicate the state of one output of the alarm system in the same way as in the case of the ABAX 2 / ABAX controller connected to the INTEGRA / INTEGRA Plus control panel. For more information, refer to the INTEGRA 128-WRL control panel manuals.

ABAX 2 / ABAX controller connected to VERSA / VERSA Plus / VERSA IP control panel

For the list of information that can be presented on the keyfob LEDs, refer to the manuals of VERSA / VERSA Plus / VERSA IP control panels.

ABAX 2 controller connected to PERFECTA 64 M control panel

Each LED can indicate the state of one output of the alarm system (LED ON – output activated; LED OFF – output deactivated).

3 Battery replacement



There is a danger of battery explosion when using a different battery than recommended by the manufacturer, or handling the battery improperly. Do not crush the battery, cut it or expose it to high temperatures (throw it into the fire, put it in the oven, etc.).

Do not expose the battery to very low pressure due to the risk of battery explosion or leakage of flammable liquid or gas.

Be particularly careful during installation and replacement of the battery. The manufacturer is not liable for the consequences of incorrect installation of the battery.

The used batteries must not be discarded, but should be disposed of in accordance with the existing rules for environment protection.

The battery life depends on how the keyfob is used. The more frequently the buttons are pressed, the faster the battery drains. Fig. 2 shows how to replace the battery.

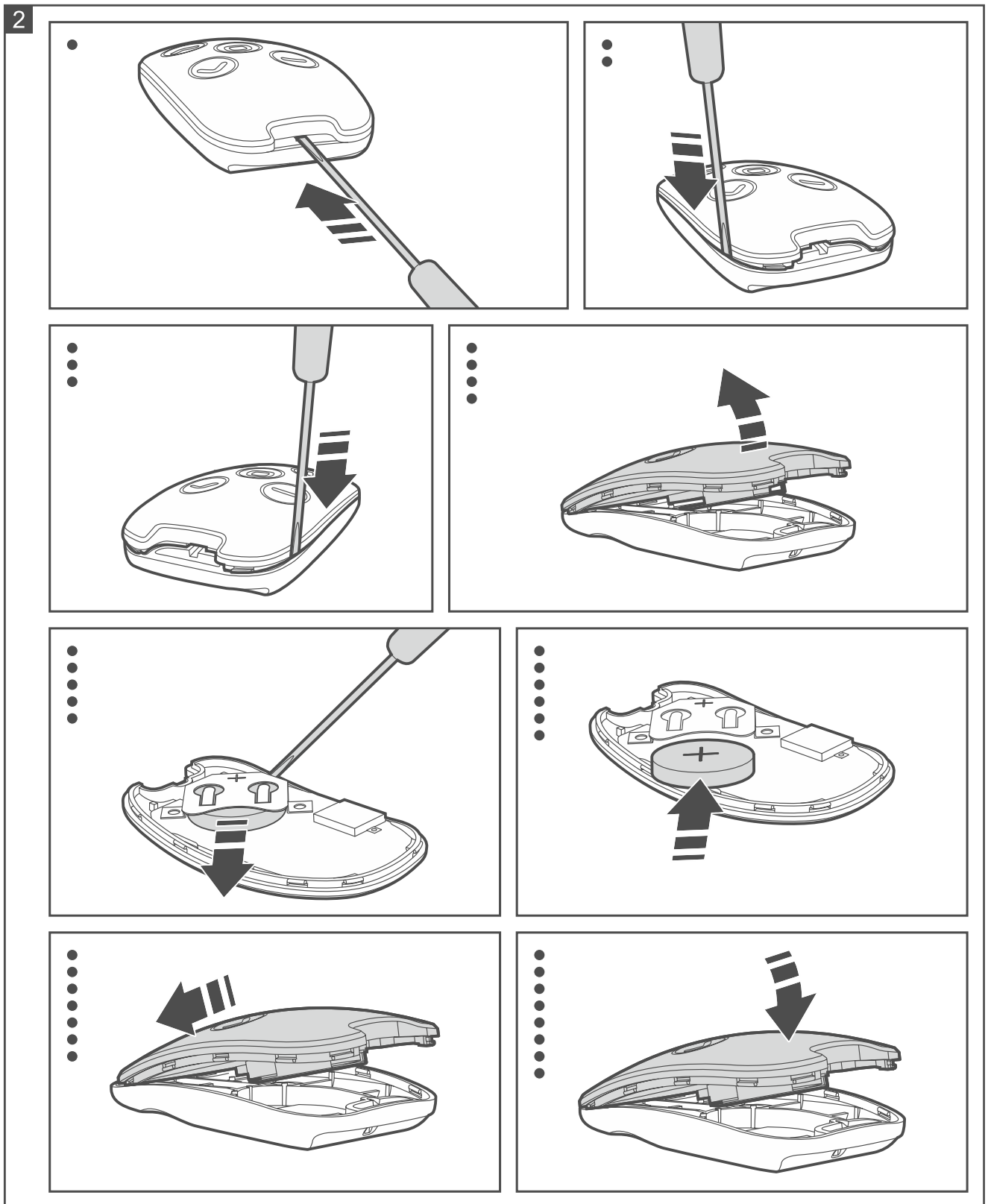

When the battery is low, after pressing the button:

- the LBA output of the ACU-220 controller will turn on (if the keyfob is registered in the ACU-220 controller),

- the control panel will indicate trouble (if the keyfob is registered in the ABAX 2 / ABAX controller, which is connected to the INTEGRA / INTEGRA Plus / VERSA / VERSA Plus / VERSA IP / PERFECTA 64 M control panel, or in the INTEGRA 128-WRL control panel).

The LBA output of the ACU-220 controller will turn off / the control panel will stop indicating trouble only after the battery replacement.

4 Specifications

Operating frequency band.....	866 MHz / 868.0 MHz ÷ 868.6 MHz / 915 MHz – 928 MHz
Radio communication range (in open area)	
ACU-220.....	up to 600 m
ACU-280.....	up to 300 m
Battery.....	CR2032 3V
Low battery voltage threshold	2.6 V
Environmental class according to EN50130-5	II
Operating temperature range.....	-10°C...+55°C
Maximum humidity	93±3%
Dimensions	38 x 78 x 16 mm
Weight.....	30 g