



Smart Video Intercom Access

The device is Touch Key Access Controller with WiFi enabled Intercom. People can install the APP for intercom with their smart phone, and program the access controller by touch key. It is compatible with both IOS (7.0 above) and Android (4.3 above).

Features:

Intercom

- > 2.4G WiFi connection
- > Android and IOS available
- > Full duplex voice intercom
- > 2MP+wide angle camera and night vision
- > Support TF card with unlimited capacity
- > Support motion detection, playback, take picture/video, unlock remotely

Access Control

- > Touch key with one relay, 1000 users (988 common+2 panic+10 visitor)
- > Fingerprint version support 100 fingerprint users
- > PIN Length: 4-6 digits
- > EM card, Mifare card optional
- > Wiegand 26-44 bits input & output
- > Can be used as Wiegand reader with LED & buzzer
- > 2 devices can be interlocked for 2 doors

Specification:

Network	2.4G WiFi connection
Pixel	2.0Mpx (1080P)
Visual Angle	Horizontal 140° wide angle
Night Vision	IR-CUT (Colorful at daytime, black and white at night)
Extended Memory	TF card with unlimited capacity
Intercom	Full duplex voice intercom
Other Functions	Motion detection; Playback; Take picture/video; Unlock remotely.

Video Intercom

Network	2.4G WiFi connection
Pixel	2.0Mpx (1080P)
Visual Angle	Horizontal 140° wide angle
Night Vision	IR-CUT (Colorful at daytime, black and white at night)
Extended Memory	TF card with unlimited capacity
Intercom	Full duplex voice intercom
Other Functions	Motion detection; Playback; Take picture/video; Unlock remotely.

Video Intercom

Network	2.4G WiFi connection
Pixel	2.0Mpx (1080P)
Visual Angle	Horizontal 140° wide angle
Night Vision	IR-CUT (Colorful at daytime, black and white at night)
Extended Memory	TF card with unlimited capacity
Intercom	Full duplex voice intercom
Other Functions	Motion detection; Playback; Take picture/video; Unlock remotely.

Video Intercom

Network	2.4G WiFi connection
Pixel	2.0Mpx (1080P)
Visual Angle	Horizontal 140° wide angle
Night Vision	IR-CUT (Colorful at daytime, black and white at night)
Extended Memory	TF card with unlimited capacity
Intercom	Full duplex voice intercom
Other Functions	Motion detection; Playback; Take picture/video; Unlock remotely.

Video Intercom

Network	2.4G WiFi connection
Pixel	2.0Mpx (1080P)
Visual Angle	Horizontal 140° wide angle
Night Vision	IR-CUT (Colorful at daytime, black and white at night)
Extended Memory	TF card with unlimited capacity
Intercom	Full duplex voice intercom
Other Functions	Motion detection; Playback; Take picture/video; Unlock remotely.

Video Intercom

Network	2.4G WiFi connection
Pixel	2.0Mpx (1080P)
Visual Angle	Horizontal 140° wide angle
Night Vision	IR-CUT (Colorful at daytime, black and white at night)
Extended Memory	TF card with unlimited capacity
Intercom	Full duplex voice intercom
Other Functions	Motion detection; Playback; Take picture/video; Unlock remotely.

Video Intercom

Network	2.4G WiFi connection
Pixel	2.0Mpx (1080P)
Visual Angle	Horizontal 140° wide angle
Night Vision	IR-CUT (Colorful at daytime, black and white at night)
Extended Memory	TF card with unlimited capacity
Intercom	Full duplex voice intercom
Other Functions	Motion detection; Playback; Take picture/video; Unlock remotely.

Video Intercom

Network	2.4G WiFi connection
Pixel	2.0Mpx (1080P)
Visual Angle	Horizontal 140° wide angle
Night Vision	IR-CUT (Colorful at daytime, black and white at night)
Extended Memory	TF card with unlimited capacity
Intercom	Full duplex voice intercom
Other Functions	Motion detection; Playback; Take picture/video; Unlock remotely.

Video Intercom

Network	2.4G WiFi connection
Pixel	2.0Mpx (1080P)
Visual Angle	Horizontal 140° wide angle
Night Vision	IR-CUT (Colorful at daytime, black and white at night)
Extended Memory	TF card with unlimited capacity
Intercom	Full duplex voice intercom
Other Functions	Motion detection; Playback; Take picture/video; Unlock remotely.

Video Intercom

Network	2.4G WiFi connection
Pixel	2.0Mpx (1080P)
Visual Angle	Horizontal 140° wide angle
Night Vision	IR-CUT (Colorful at daytime, black and white at night)
Extended Memory	TF card with unlimited capacity
Intercom	Full duplex voice intercom
Other Functions	Motion detection; Playback; Take picture/video; Unlock remotely.

Video Intercom

Network	2.4G WiFi connection
Pixel	2.0Mpx (1080P)
Visual Angle	Horizontal 140° wide angle
Night Vision	IR-CUT (Colorful at daytime, black and white at night)
Extended Memory	TF card with unlimited capacity
Intercom	Full duplex voice intercom
Other Functions	Motion detection; Playback; Take picture/video; Unlock remotely.

Introduction

The device is Touch Key Access Controller with WiFi enabled Intercom. People can install the APP for intercom with their smart phone, and program the access controller by touch key. It is compatible with both IOS (7.0 above) and Android (4.3 above).

Features:

Intercom

- > 2.4G WiFi connection
- > Android and IOS available
- > Full duplex voice intercom
- > 2MP+wide angle camera and night vision
- > Support TF card with unlimited capacity
- > Support motion detection, playback, take picture/video, unlock remotely

Access Control

- > Touch key with one relay, 1000 users (988 common+2 panic+10 visitor)
- > Fingerprint version support 100 fingerprint users
- > PIN Length: 4-6 digits
- > EM card, Mifare card optional
- > Wiegand 26-44 bits input & output
- > Can be used as Wiegand reader with LED & buzzer
- > 2 devices can be interlocked for 2 doors

Specification:

Network	2.4G WiFi connection
Pixel	2.0Mpx (1080P)
Visual Angle	Horizontal 140° wide angle
Night Vision	IR-CUT (Colorful at daytime, black and white at night)
Extended Memory	TF card with unlimited capacity
Intercom	Full duplex voice intercom
Other Functions	Motion detection; Playback; Take picture/video; Unlock remotely.

Video Intercom

Network	2.4G WiFi connection
Pixel	2.0Mpx (1080P)
Visual Angle	Horizontal 140° wide angle
Night Vision	IR-CUT (Colorful at daytime, black and white at night)
Extended Memory	TF card with unlimited capacity
Intercom	Full duplex voice intercom
Other Functions	Motion detection; Playback; Take picture/video; Unlock remotely.

Video Intercom

Network	2.4G WiFi connection
Pixel	2.0Mpx (1080P)
Visual Angle	Horizontal 140° wide angle
Night Vision	IR-CUT (Colorful at daytime, black and white at night)
Extended Memory	TF card with unlimited capacity
Intercom	Full duplex voice intercom
Other Functions	Motion detection; Playback; Take picture/video; Unlock remotely.

Video Intercom

Network	2.4G WiFi connection
Pixel	2.0Mpx (1080P)
Visual Angle	Horizontal 140° wide angle
Night Vision	IR-CUT (Colorful at daytime, black and white at night)
Extended Memory	TF card with unlimited capacity
Intercom	Full duplex voice intercom
Other Functions	Motion detection; Playback; Take picture/video; Unlock remotely.

Video Intercom

Network	2.4G WiFi connection
Pixel	2.0Mpx (1080P)
Visual Angle	Horizontal 140° wide angle
Night Vision	IR-CUT (Colorful at daytime, black and white at night)
Extended Memory	TF card with unlimited capacity
Intercom	Full duplex voice intercom
Other Functions	Motion detection; Playback; Take picture/video; Unlock remotely.

Video Intercom

Network	2.4G WiFi connection
Pixel	2.0Mpx (1080P)
Visual Angle	Horizontal 140° wide angle
Night Vision	IR-CUT (Colorful at daytime, black and white at night)
Extended Memory	TF card with unlimited capacity
Intercom	Full duplex voice intercom
Other Functions	Motion detection; Playback; Take picture/video; Unlock remotely.

Video Intercom

Network	2.4G WiFi connection
Pixel	2.0Mpx (1080P)
Visual Angle	Horizontal 140° wide angle
Night Vision	IR-CUT (Colorful at daytime, black and white at night)
Extended Memory	TF card with unlimited capacity
Intercom	Full duplex voice intercom
Other Functions	Motion detection; Playback; Take picture/video; Unlock remotely.

Video Intercom

Network	2.4G WiFi connection
Pixel	2.0Mpx (1080P)
Visual Angle	Horizontal 140° wide angle
Night Vision	IR-CUT (Colorful at daytime, black and white at night)
Extended Memory	TF card with unlimited capacity
Intercom	Full duplex voice intercom
Other Functions	Motion detection; Playback; Take picture/video; Unlock remotely.

Video Intercom

Network	2.4G WiFi connection
Pixel	2.0Mpx (1080P)
Visual Angle	Horizontal 140° wide angle
Night Vision	IR-CUT (Colorful at daytime, black and white at night)
Extended Memory	TF card with unlimited capacity
Intercom	Full duplex voice intercom
Other Functions	Motion detection; Playback; Take picture/video; Unlock remotely.

Video Intercom

Network	2.4G WiFi connection
Pixel	2.0Mpx (1080P)
Visual Angle	Horizontal 140° wide angle
Night Vision	IR-CUT (Colorful at daytime, black and white at night)
Extended Memory	TF card with unlimited capacity
Intercom	Full duplex voice intercom
Other Functions	Motion detection; Playback; Take picture/video; Unlock remotely.

Video Intercom

Network	2.4G WiFi connection
Pixel	2.0Mpx (1080P)
Visual Angle	Horizontal 140° wide angle
Night Vision	IR-CUT (Colorful at daytime, black and white at night)
Extended Memory	TF card with unlimited capacity
Intercom	Full duplex voice intercom
Other Functions	Motion detection; Playback; Take picture/video; Unlock remotely.

Installation

> Remove the back cover from the unit

> Drill 2 holes(A,C) on the wall for the screws and one hole for the cable

> Knock the supplied rubber bungs to the screw holes(A,C)

> Fix the back cover firmly on the wall with 4 flat head screws

> Thread the cable through the cable hole(B)

> Attach the unit to the back cover

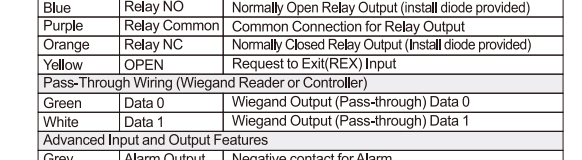

Wire Color	Function	Notes
Red	DC +	12V DC Power Input
Black	GN	Negative Pole of DC Power Input
Blue	Relay NO	Normally Open Relay Output (install Gnd as provided)
Purple	Relay Common	Common Connection for Relay Output
Orange	Relay NC	Normally Closed Relay Output (install Gnd as provided)
Yellow	OPEN	Request to Exit(REX) Input
Green	Data 0	Wiegand Output (Pass-through) Data 0
White	Data 1	Wiegand Output (Pass-through) Data 1
Red	Alarm Input	Request to Alarm
Grey	Alarm Output	Negative contact for Alarm
Brown	Contact Input	Door/Gate Contact Input (Normally Closed)

Operation Status	LED	Buzzer
Stand by	Red light bright	—
Enter into programming mode	Red light shines	One beep
In the programming mode	Orange light bright	One beep
Operation error	—	Three beeps
Exit from the Programming mode	Red light bright	One beep
Open lock	Green light bright	One beep
Alarm	Red light shines quickly	Beeps

Function	Keystroke Steps	Notes
Add fingerprint user (For fingerprint version)	* (Master Code) # 1 (Fingerprint) (Repeat Fingerprint) (Repeat Fingerprint again)	Using auto ID, the cards can be added continuously
Add common card user	* (Master Code) # 1 (User ID) # (Input 8/10 digits card number) (Repeat card) / (Input 8/10 digits card number) # (Master Code) # 1 (User ID) # (Input 8/10 digits card number)	Using auto ID, the cards can be added continuously
Add common PIN user	* (Master Code) # 1 (PIN) # (User ID) # 1 (User ID) # (Read card) / (Input 8/10 digits card number) / PIN #	Using auto ID, the PINs can be added continuously
Add panic user	* (Master Code) # 1 (User ID) # (Read card) / (Input 8/10 digits card number) / PIN #	User ID number is 988,989; PIN length: 4-6 digits except 888
Add visitor user	* (Master Code) # 1 (User ID) # (User ID) # (Read card) / (Input 8/10 digits card number) / PIN #	User ID number is 988,989; PIN length: 4-6 digits except 888
Change PIN	* (User ID) # (Old PIN) # (New PIN) # (Repeat new PIN) #	There will auto allocate PIN (888) to cards when adding
Delete user	* (Master Code) # 2 (User ID) # (Master Code) # 2 (Master Code) #	Delete user by card / number
Exit	*	Press * to exit programming

Users Management:

Function	Keystroke Steps	Notes
Add fingerprint user (For fingerprint version)	* (Master Code) # 1 (Fingerprint) (Repeat Fingerprint) (Repeat Fingerprint again)	Using auto ID, the cards can be added continuously
Add common card user	* (Master Code) # 1 (User ID) # (Input 8/10 digits card number) (Repeat card) / (Input 8/10 digits card number) # (Master Code) # 1 (User ID) # (Input 8/10 digits card number)	Using auto ID, the cards can be added continuously
Add common PIN user	* (Master Code) # 1 (PIN) # (User ID) # 1 (User ID) # (Read card) / (Input 8/10 digits card number) / PIN #	Using auto ID, the PINs can be added continuously
Add panic user	* (Master Code) # 1 (User ID) # (Read card) / (Input 8/10 digits card number) / PIN #	User ID number is 988,989; PIN length: 4-6 digits except 888
Add visitor user	* (Master Code) # 1 (User ID) # (User ID) # (Read card) / (Input 8/10 digits card number) / PIN #	User ID number is 988,989; PIN length: 4-6 digits except 888
Change PIN	* (User ID) # (Old PIN) # (New PIN) # (Repeat new PIN) #	There will auto allocate PIN (888) to cards when adding
Delete user	* (Master Code) # 2 (User ID) # (Master Code) # 2 (Master Code) #	Delete user by card / number
Exit	*	Press * to exit programming

Set Access Mode (for without fingerprint version):

Function	Keystroke Steps	Notes
Card access	* (Master Code) # 4 1 #	Entry by card only
Card + PIN access	* (Master Code) # 4 2 #	Entry by card + PIN
Card or PIN access	* (Master Code) # 4 3 #	Entry by card or PIN (default)
Multi user access	* (Master Code) # 4 3 (2-9) #	Only after 2-9 valid users, the door can be opened. The interval time of reading can't exceed 5 seconds
Exit	*	Press * to exit programming

Set Access Mode (for fingerprint version):

Function	Keystroke Steps	Notes
Fingerprint access	* (Master Code) # 4 0 #	Entry by fingerprint only
Card access	* (Master Code) # 4 1 #	Entry by card only
PIN access	* (Master Code) # 4 2 #	Entry by PIN only
Card+PIN access	* (Master Code) # 4 3 #	Entry by card+PIN only
Multi users access	* (Master Code) # 4 3 (2-9) #	Only after 2-9 valid users, the door can be opened. The interval time of reading can't exceed 5 seconds
Fingerprint or Card or PIN access	* (Master Code) # 4 4 #	Entry by fingerprint or card or PIN (default)
Exit	*	Press * to exit programming

Operation Setting:

Function	Keystroke Steps	Notes
Relay time setting	* (Master Code) # 3 (1-99) #	Time range: 1~99s (default is 5 seconds)
Relay toggle mode	* (Master Code) # 3 0 #	Set the relay to ON/OFF toggle mode
Strike-Out OFF	* (Master Code) # 6 1 #	Normal mode (default)
Strike-Out ON	* (Master Code) # 6 1 #	Access will be denied for 10 minutes after 10 failed entry attempts (Exit button is still workable)
Strike-Out ON (Alarm)	* (Master Code) # 6 2 #	It will alarm after 10 failed entry attempts. Enter any valid card/PIN # or user or master) to silence
Disable door open detection	* (Master Code) # 6 3 #	Normal mode (default)

Notes for PIN Security (Only valid for 6 digits PIN):

For higher security we allow you to hide your correct PIN with other numbers up to a max of 10 digits.

Example PIN: 123434
You could use **123434** or ** (123434)
(** can be any numbers from 0-9)

APP Operation

Here are just a few steps to get you started.

- Free APP Downloading
- Make sure WiFi works on your mobile phone.

1. Register & Login

(Make sure the registered email is legal and valid, so that you can recover your password once forgotten. **Mobile Number is for China Mobile ONLY**)

APP Operation

Here are just a few steps to get you started.

- Free APP Downloading
- Make sure WiFi works on your mobile phone.

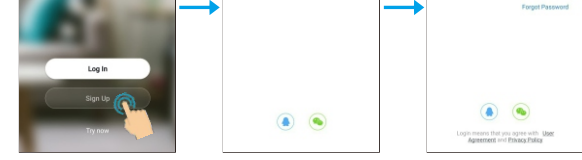

You will get a verification code in your mail box.

2. Add Device

You can add device by clicking 'Add Device' or clicking '+' on the top. Before adding the device, please make sure it is adding mode (Door bell LED flashes slowly).

Intercom operation ON/OFF

- Full screen
- Take a picture
- Intercom ON/OFF
- Take a video
- Check the alarm video record (To use this function, must insert a TF card in the device)
- Change the theme color
- Adjust the volume of device
- Motion detection ON/OFF
- Unlock the door

3. Operation

- Revise device name and location
- Check IP address, ID and time zone of device
- Configure one or more devices' automation
- Door bell LED ON/OFF; Flip screen
- Adjust device volume
- Motion detection ON/OFF; set the detection sensitivity, set alarm timer
- Check the capacity (Total/Used/Remaining) of TF card, and format TF card
- Value-added Service
- If turn on it, a notification will be sent after device stayed offline in 30 minutes.
- Check the FAQ related to device
- Share the device by