

## GS12650(12V65Ah/10hr)

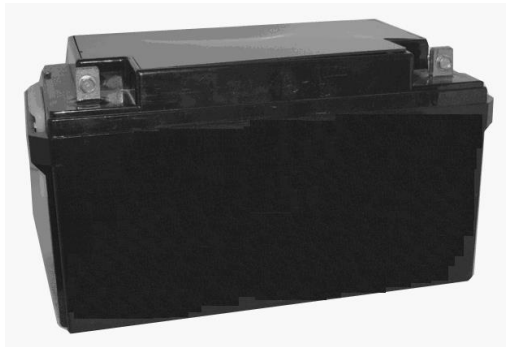

### General Series

General Series Valve Regulated Lead Acid batteries are designed with AGM (Absorbent Glass Mat) technology, high performance plates and electrolyte to gain extra power output for common power backup system applications widely used in the field of UPS, Emergency Lighting System.

### Application

- Alarm System
- Cable Television
- Power tools
- Emergency Power System
- Security System
- Solar
- Medical Equipment
- UPS
- Communication Equipment
- Control Equipment
- Toys

### General Features

- Sealed and maintenance free operation.
- Non-Spillable construction design.
- ABS containers and covers(UL94HB, UL94V-0) optional.
- Safety valve installation for explosion proof .
- High quality and high reliability.
- Exceptional deep discharge recovery performance.
- Low self discharge characteristic.
- Flexibility design for multiple install positions.

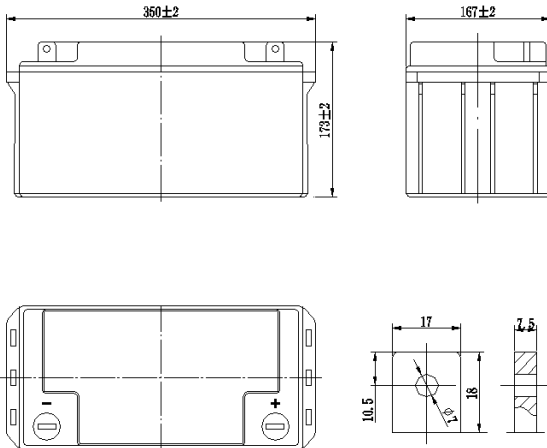

### CONSTRUCTION

Component	Positive plate	Negative plate	Container	Cover	Safety valve	Terminal	Separator	Electrolyte
Raw material	Lead dioxide	Lead	ABS	ABS	Rubber	Copper	Fiberglass	Sulfuric acid

### TECHNOLOGY PARAMETER

Battery model	GS12650			
Designed Floating Life	8-10 Years			
Capacity (25 °C)	10hR(6.5A, 10.8V)	5hR(10.7A, 10.5V)		1hR(40.7A, 9.60V)
	65Ah	53.5Ah		40.7Ah
Dimensions	Length	Width	Height	Total Height
	350±2mm	167±2mm	173±2mm	173±2mm
Approx. weight (±5%)	20.5Kg			
Internal resistance	Full charged at 25 °C: Approx. 7.5mOhms			
Self discharge	3% of capacity declined per month at 25 °C (average)			
Capacity Affected by Temp.(10HR)	40 °C	25 °C	0 °C	-15 °C
	102%	100%	85%	65%
Charge Voltage (25 °C)	Cycle use		Float use	
	14.4-14.7V(-30mV/°C), max. Current: 16.25A		13.5-13.8V(-20mV/°C)	

## GS12650 (12V65Ah/10hr)

Constant current discharge ratings-amperes at 25°C

End Point Volts/Cell	5min	10min	15min	30min	1h	3h	5h	10h	20h
1.60V	210	159	121	70.8	40.7	17.9	11.7	6.70	3.51
1.65V	200	152	115	69.5	39.2	17.3	11.4	6.65	3.47
1.70V	188	143	109	68.2	37.7	16.7	11.0	6.58	3.45
1.75V	176	135	103	66.9	36.2	16.0	10.7	6.53	3.40
1.80V	164	128	97.2	65.6	34.7	15.3	10.4	6.50	3.37

Constant power discharge ratings-watts at 25°C

End Point Volts/Cell	5min	10min	15min	30min	1h	3h	5h	10h	20h
1.60V	378	287	220	130	74.9	33.1	21.7	12.5	6.60
1.65V	357	273	208	127	71.8	31.9	21.0	12.4	6.50
1.70V	334	256	196	123	68.6	30.6	20.3	12.2	6.42
1.75V	311	240	185	120	65.6	29.2	19.6	12.0	6.30
1.80V	289	226	173	117	62.5	27.7	18.9	11.7	6.20

